

Model C22VOY-TZR

Tizen 8.0

User Manual

Cello Electronics

Dovecot Hill,
South Church,
Bishop Auckland UK
DL14 6XW

Page Contents Summary

- 2. Setup Wizard**
- 8. Home page**
 - 9. Home
 - 11. Source
- 14. TV settings**
 - 14. Picture
 - 17. Sound
 - 19. Connections
 - 21. Broadcasting
- 24. General & Privacy
 - 31. Support
- 35. Specifications**
- 36. Safety Warnings**
- 37. Maintenance**
- 38. Waste & Recycling**

Content

SETUP WIZARD

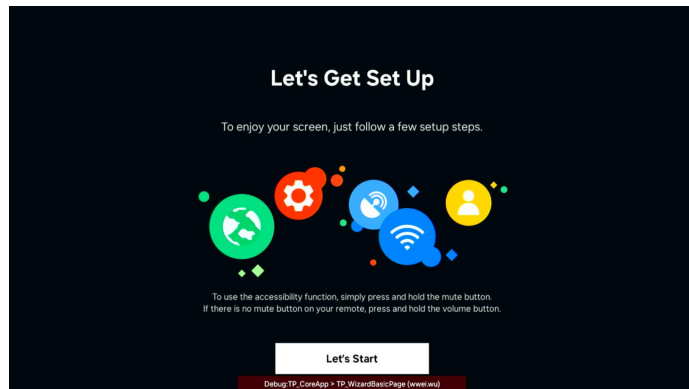

HOME PAGE

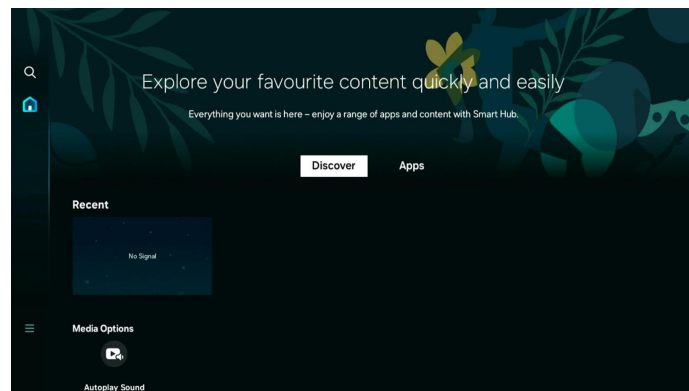

TV SETTING

- Picture
- Sound
- Connection
- Broadcasting
- General&Privacy
- Support

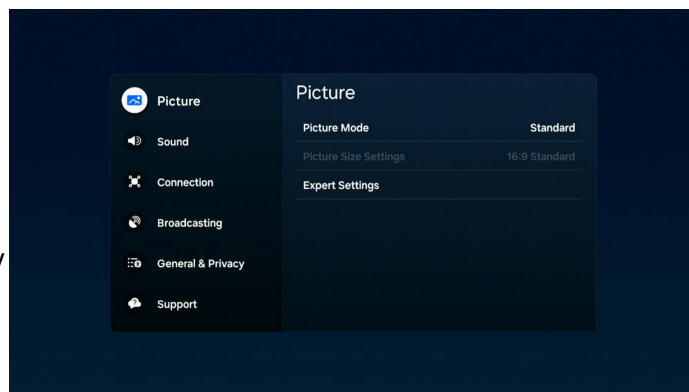

Setup Wizard

The system setting will appear when you open the TV on the first time. Please set according to the on-screen guide. Press **OK** button to start the setup.

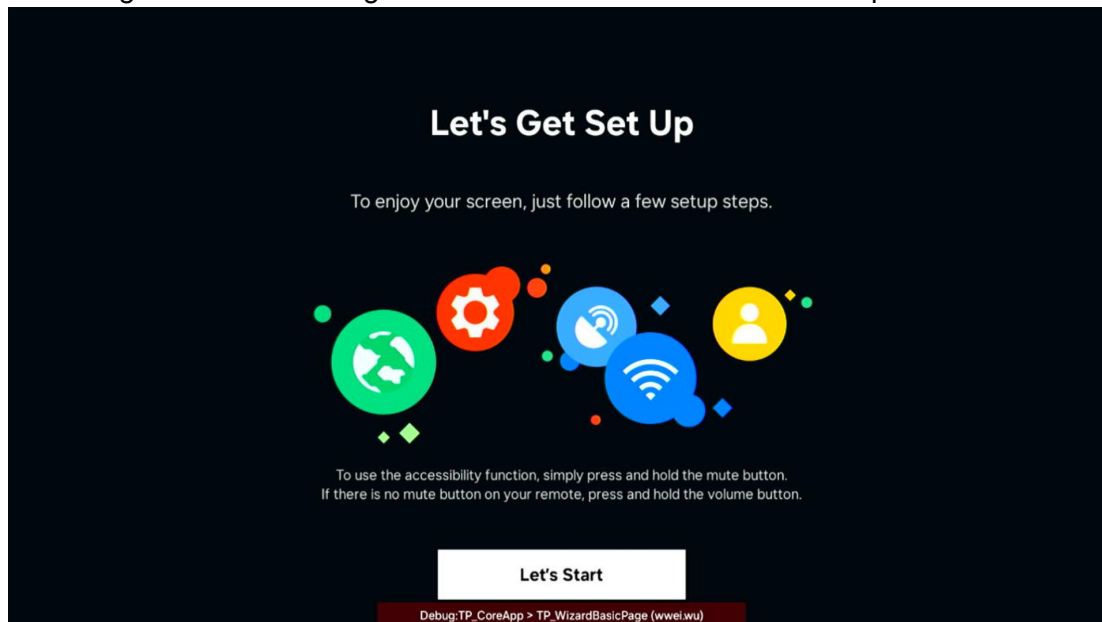

Press **▼/▲** button to select your country or region, press **OK** button to confirm and proceed to the next step.

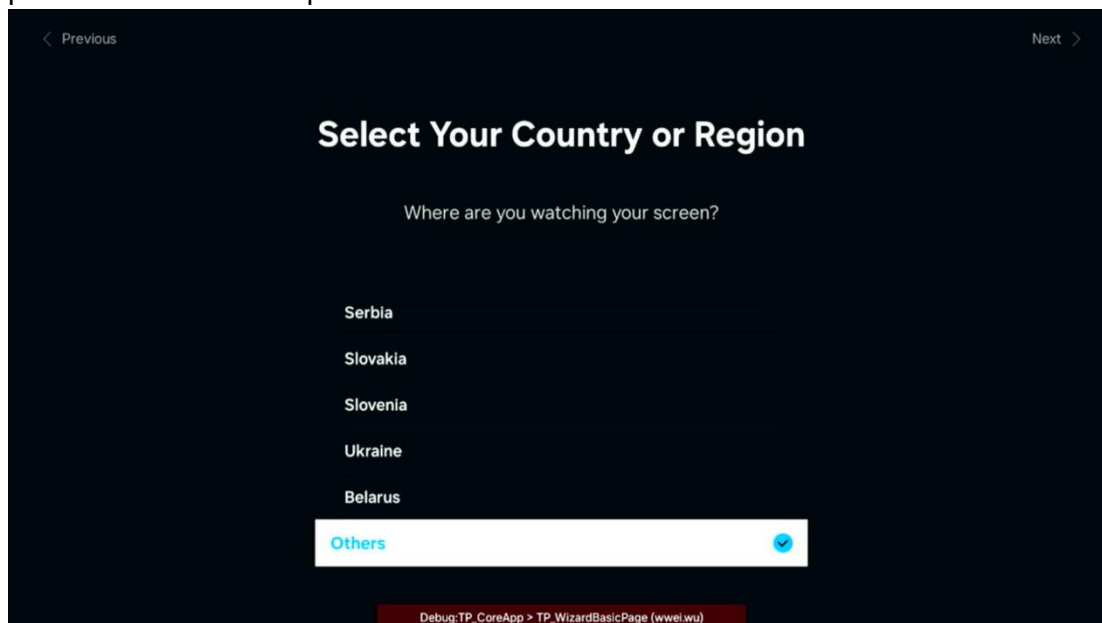

Press ◀/▶ button to setup and choose to connect your devices to the screen then start setup.

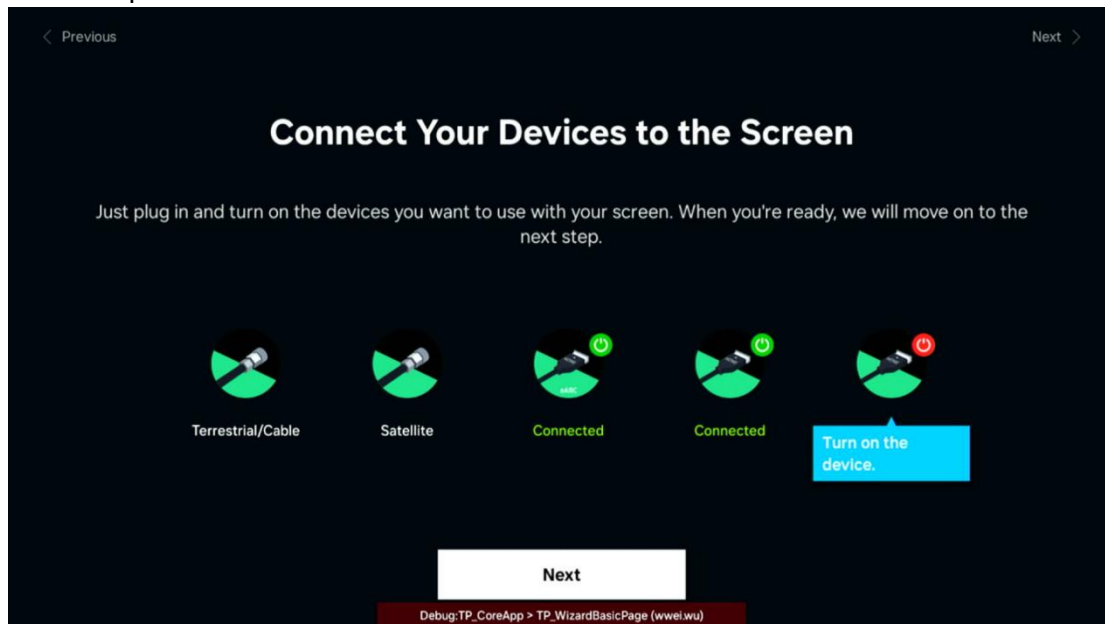

Press ◀/▶ button to select the signal setup page. Select the connected aerial that you want to use to get channels, and select each item and choose the correct setting. Then select Next to search for channels.

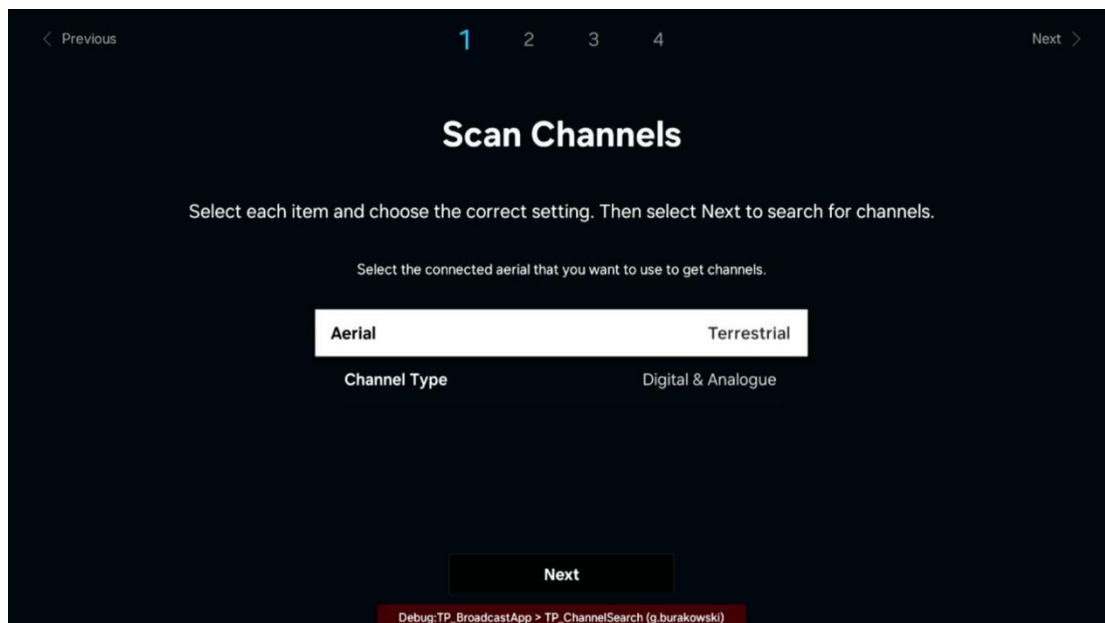

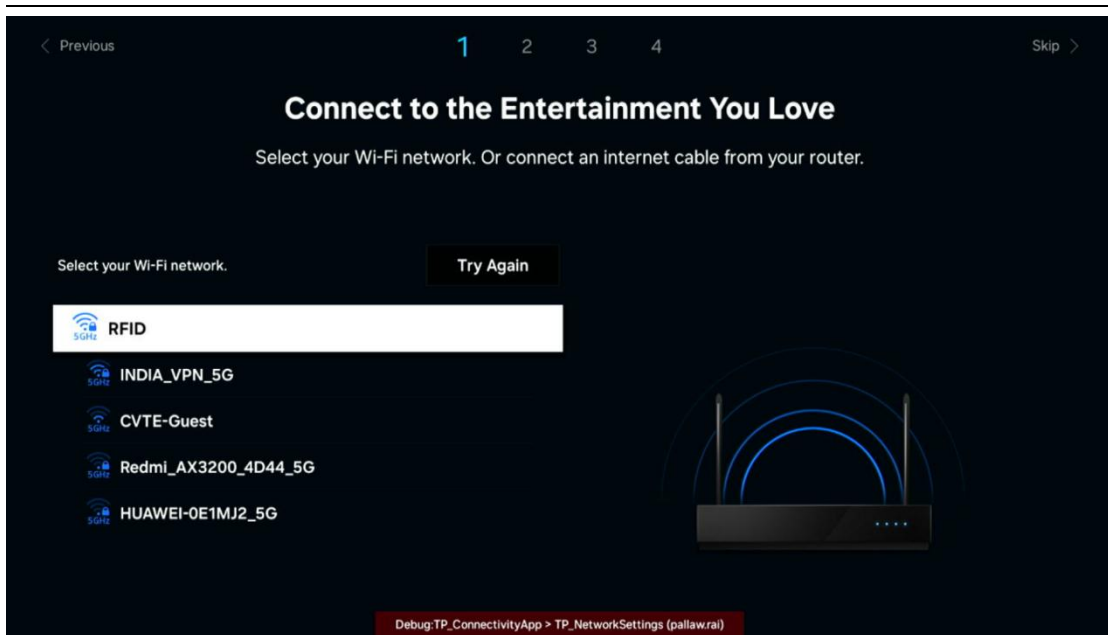

Press ◀/▶ button to select Network and press **OK** button to turn to next page.

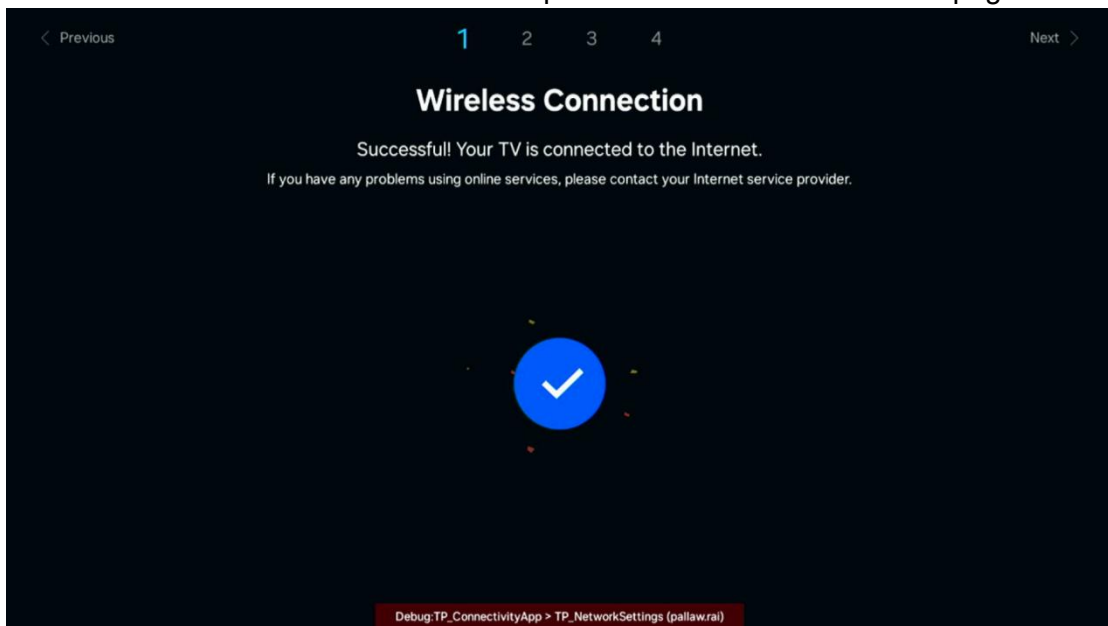

Select " OK " to agree to the Terms & Conditions and Privacy Notice, and then choose to enable specific additional service above by individually selecting.

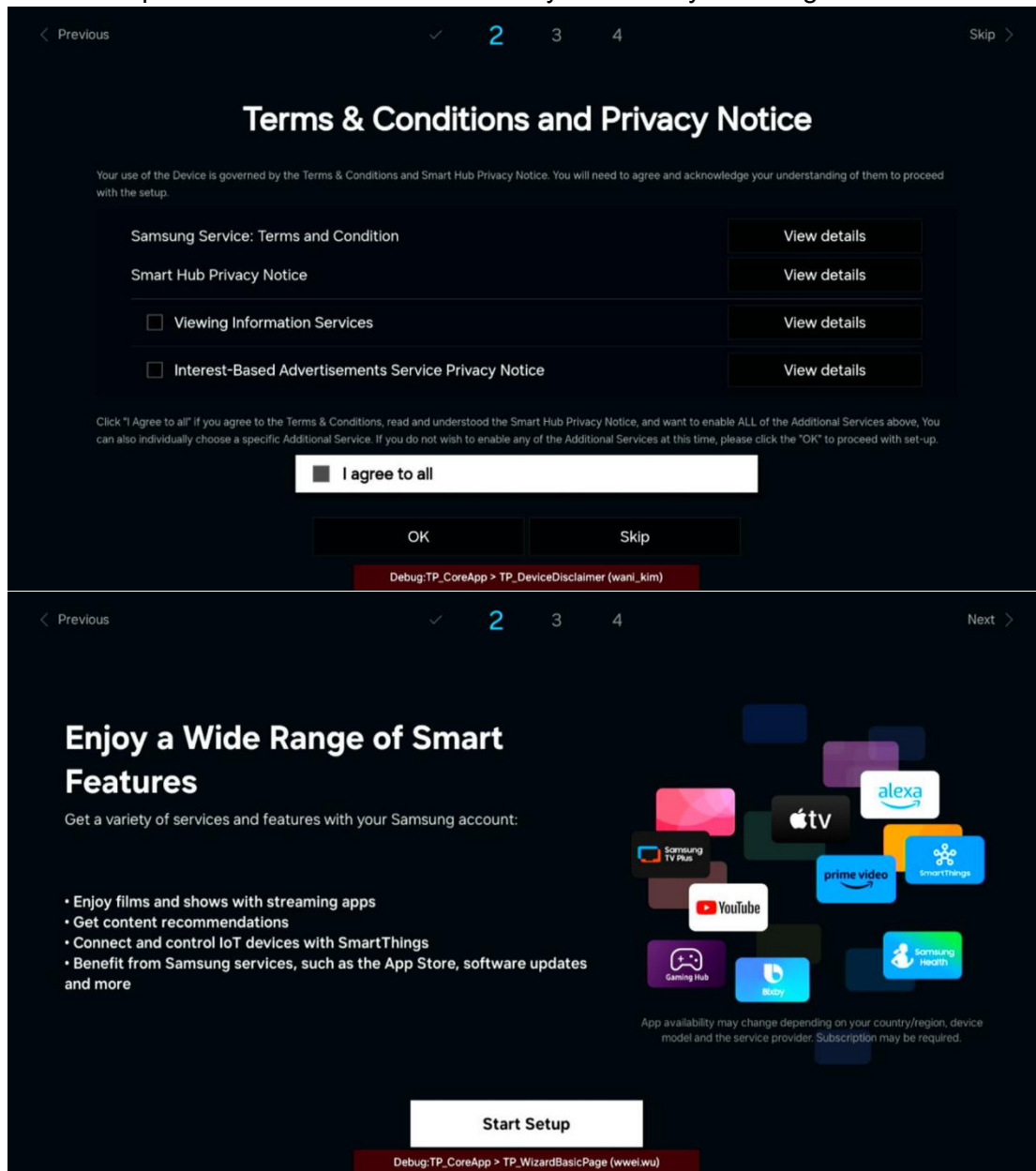

Choose sign in the Samsung account or skip to next step.

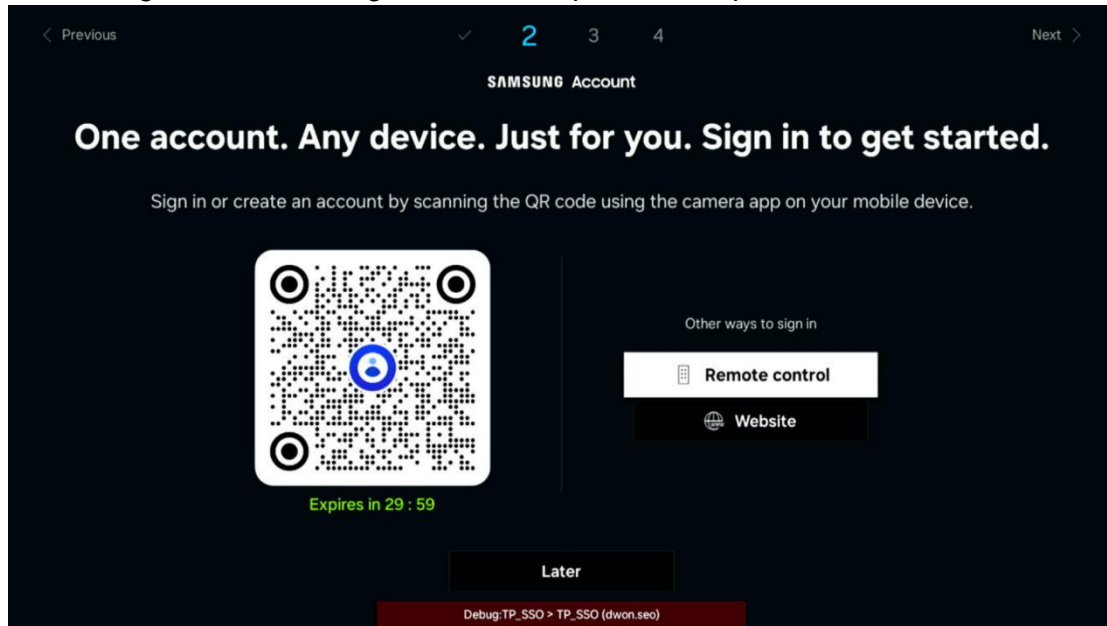

Press ◀/▶/▼/▲ button to select TV source and scan channel

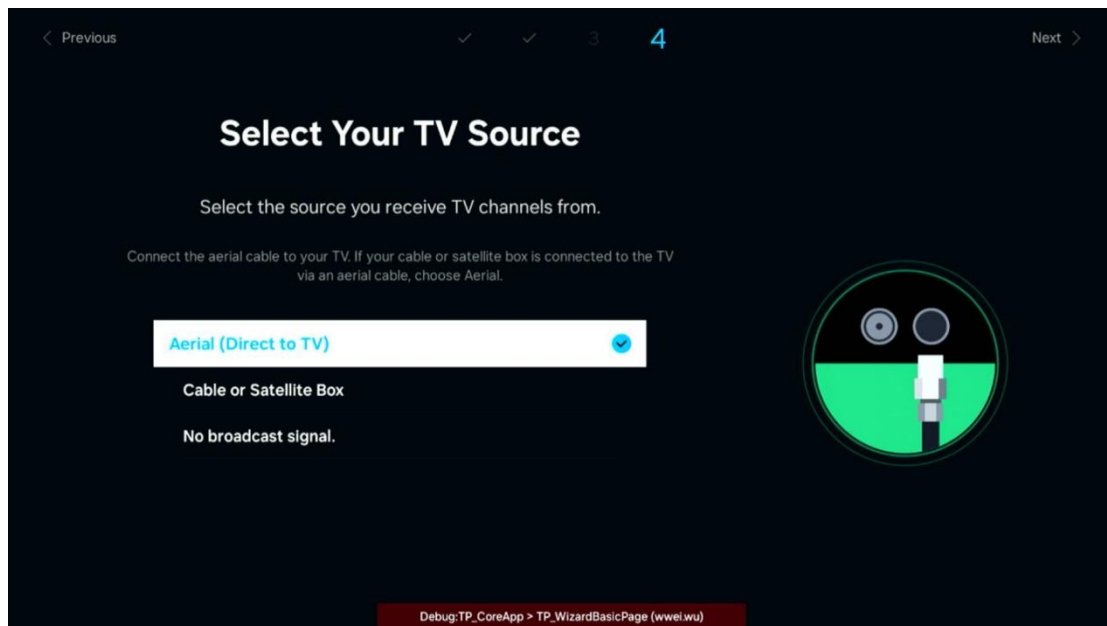

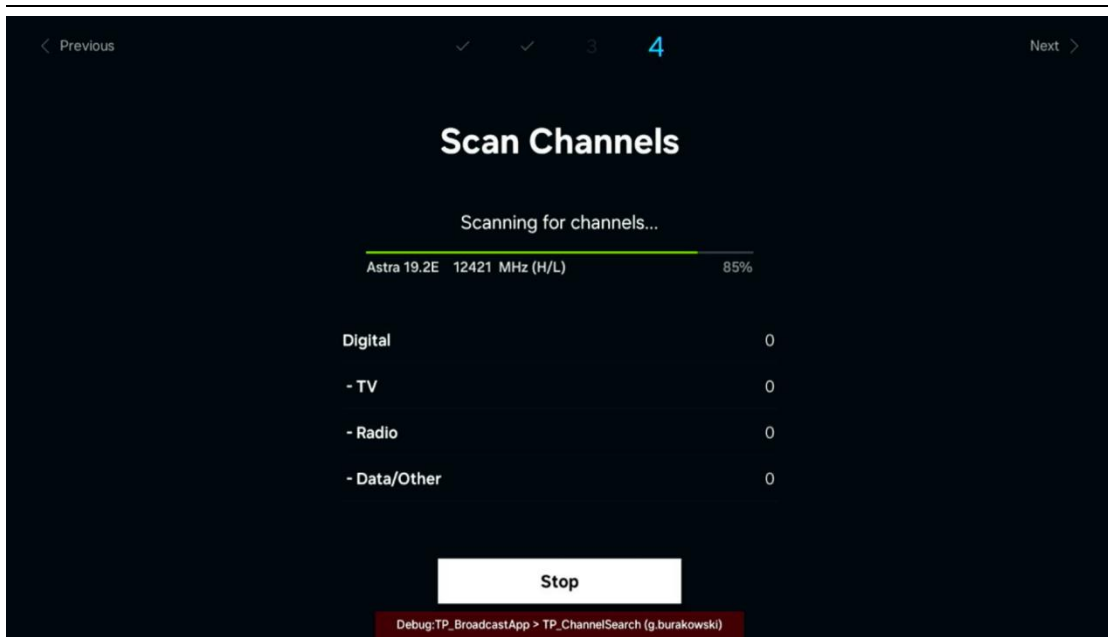

Check the settings below to make sure everything's how you want it, then enter the next step.

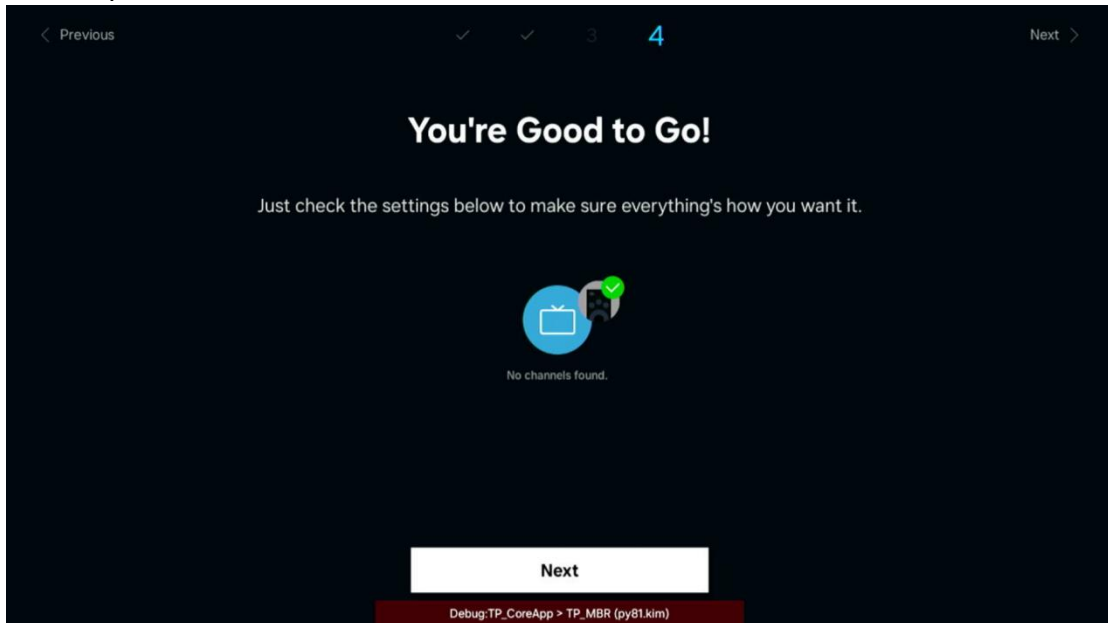

Home page

Enter the Home page after Setup Wizard.

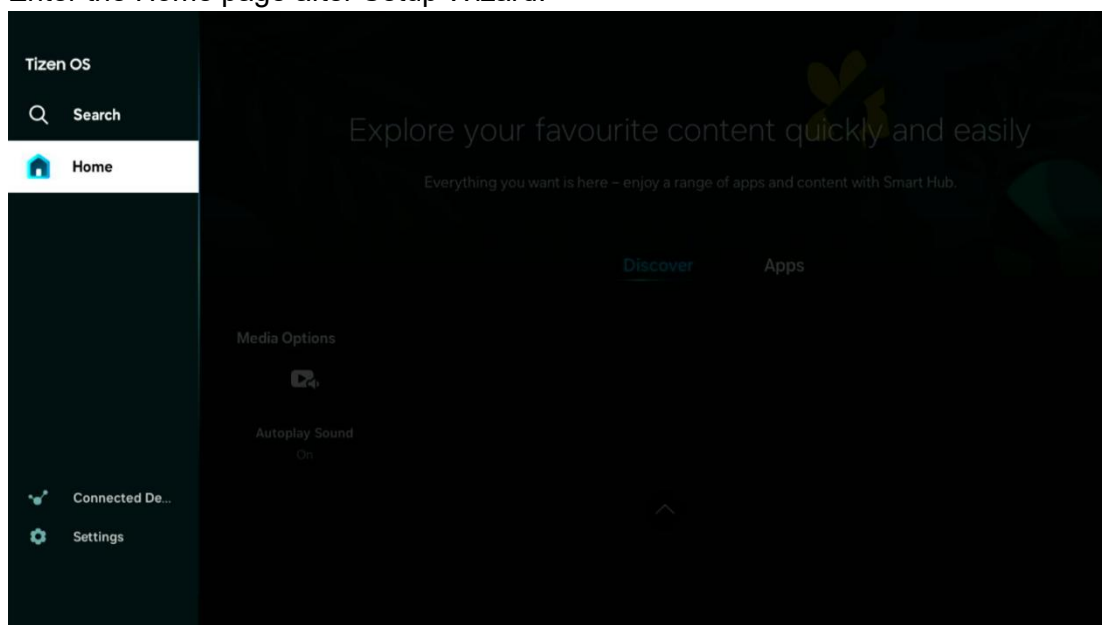

Search

Press ▼/▲/◀/▶ button to select Search, then press <OK> to enter.

You can search for channels, programs, movie titles and apps from Smart Hub.

(Note:It only available when connected to the Internet.)

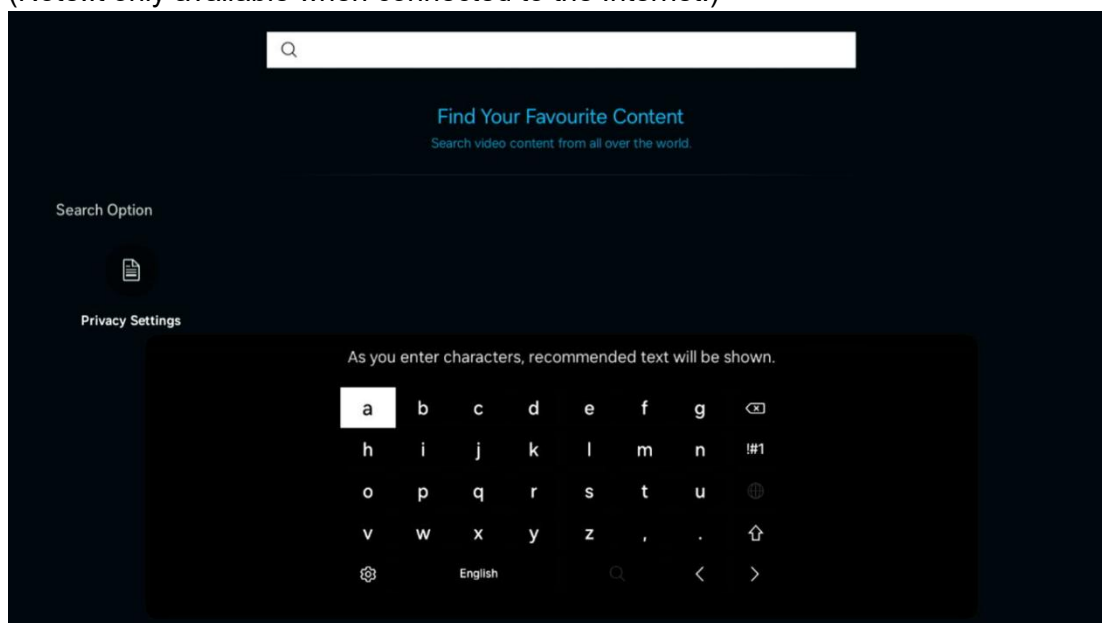

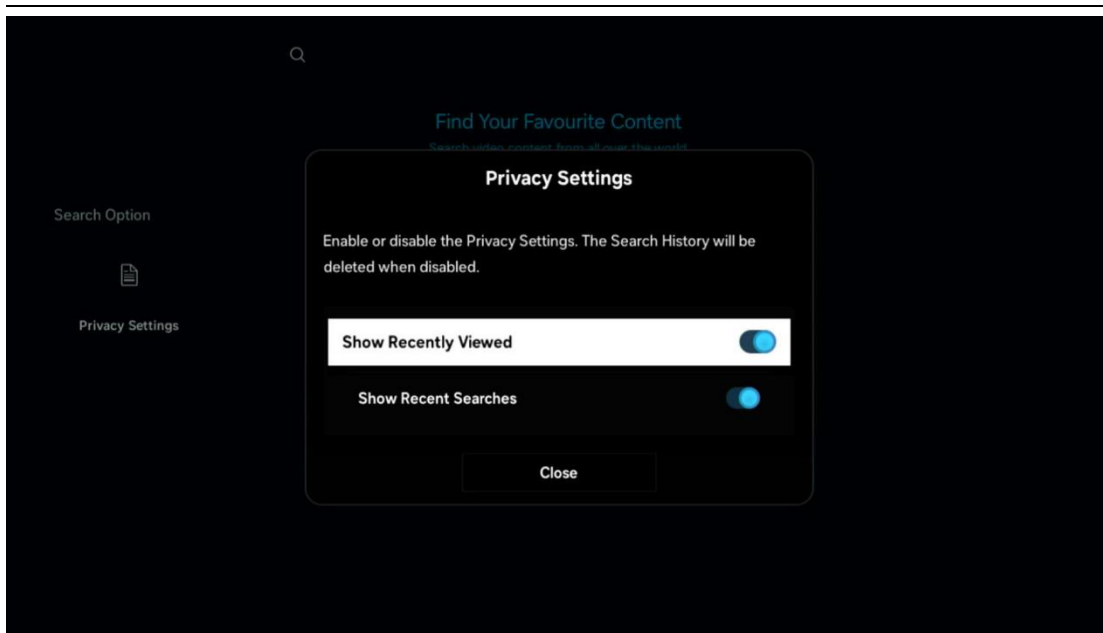

Home

Press ▼/▲/◀/▶ button to select Home, then press <OK> to enter.

Press ◀/▶ button to select Discover/ Apps.

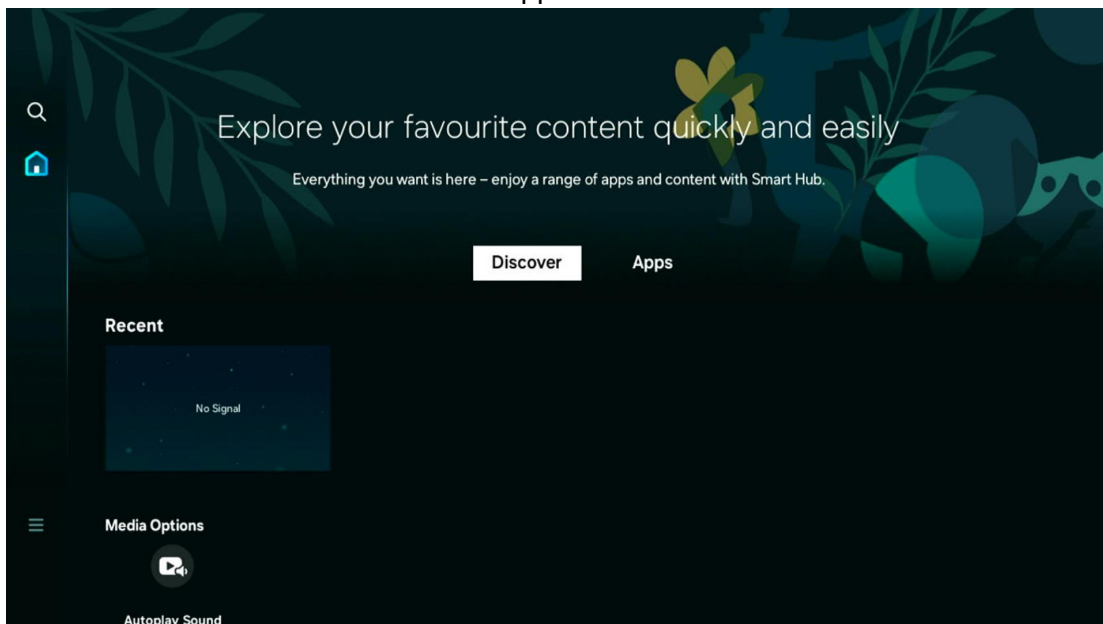

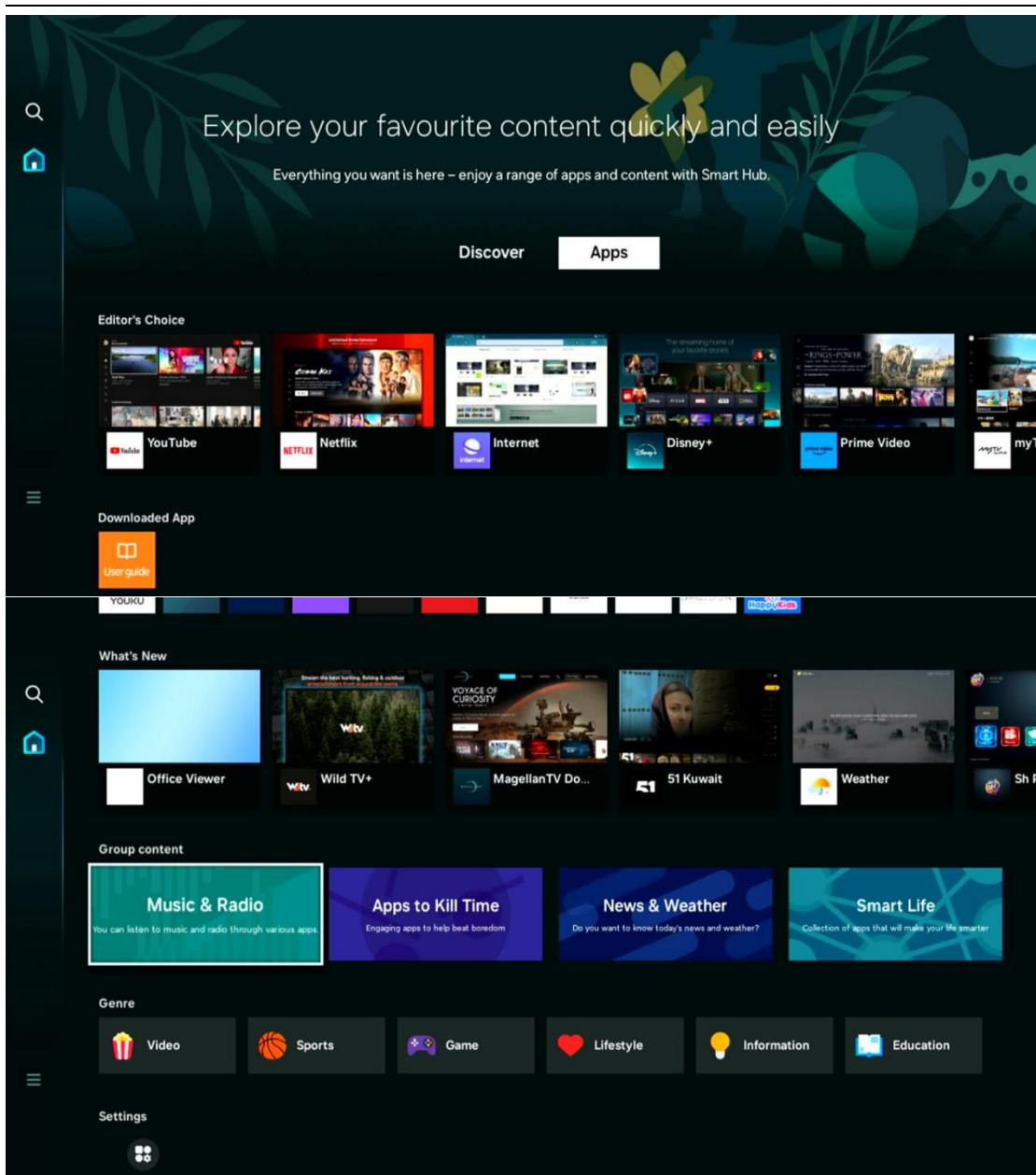

Source

Press ▼/▲/◀/▶ button to select Connected Devices, then press <OK>/▶ to enter.
You can select an external device connected to the TV.

(Optional:TV/HDMI1/HDMI2/HDMI3/AV/Connection Guide)

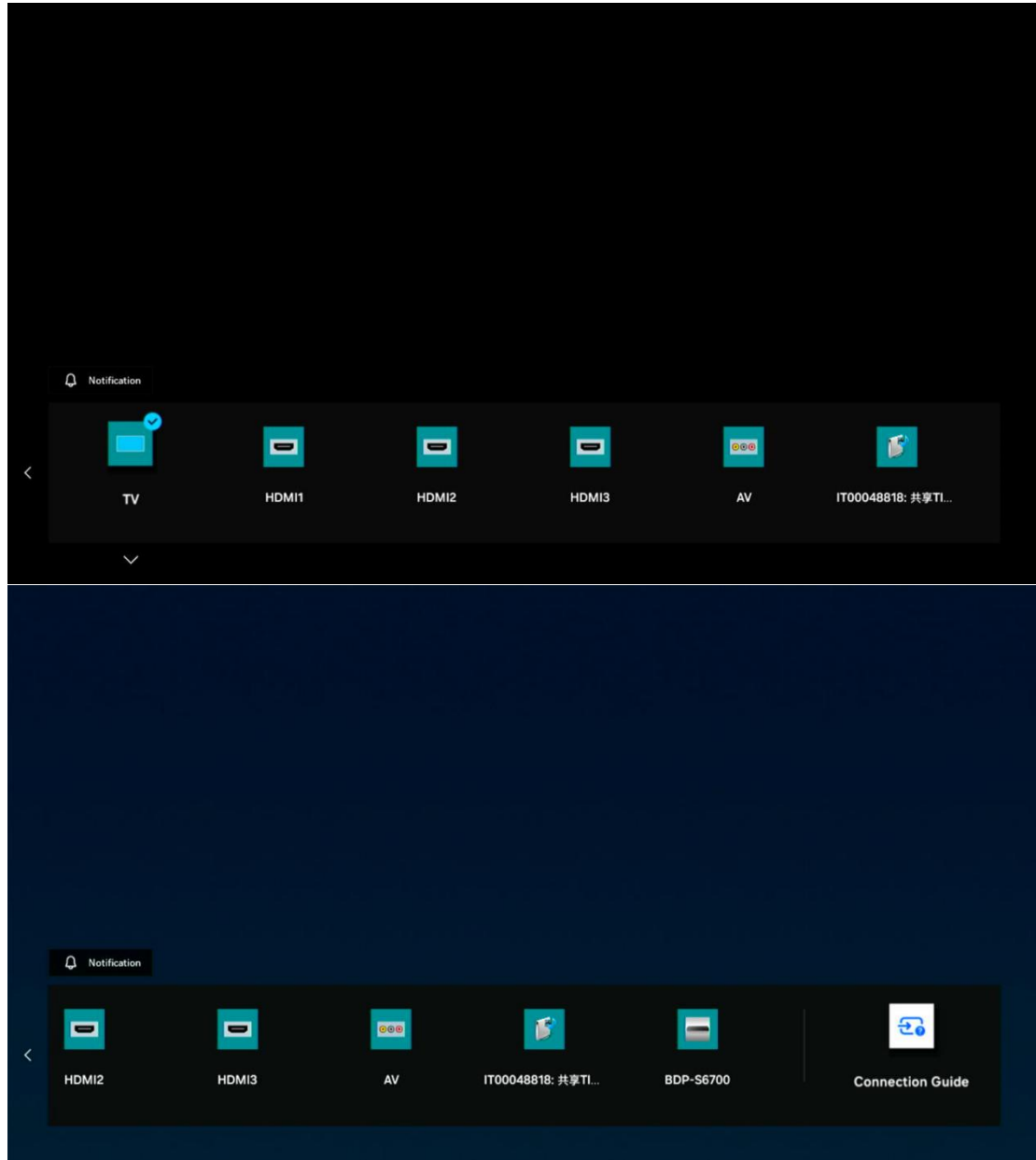

Settings

Press ▼/▲/◀/▶ button to select Settings, then press <OK>/▶ to enter.

(Optional: All Settings/Sound Output/Backlight/Picture Mode/Sound Mode/Bluetooth Devices/LAN/Game Mode/Subtitle/Audio Language/Energy Saving Solution/Support/Sleep Timer/Edit List)

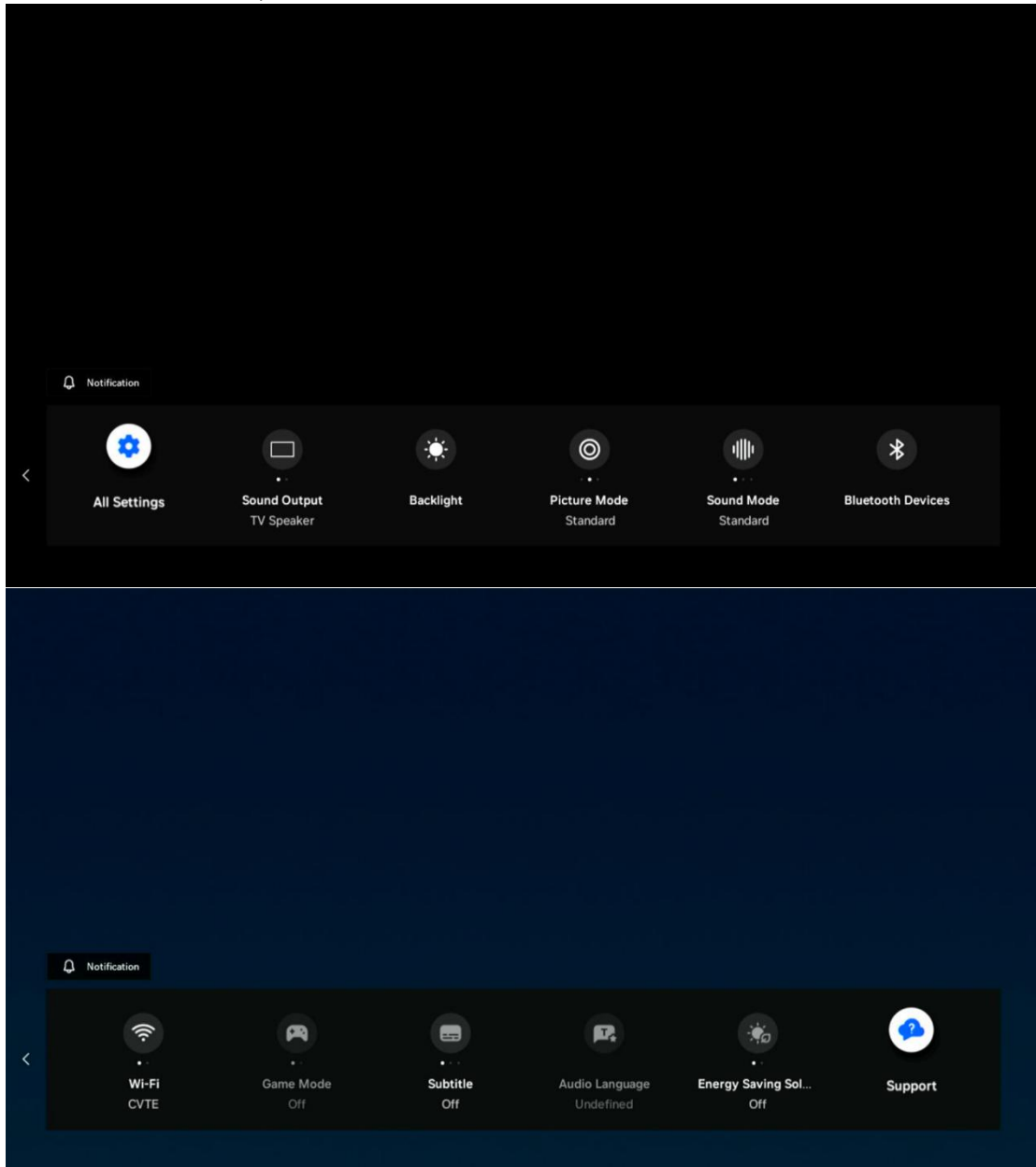

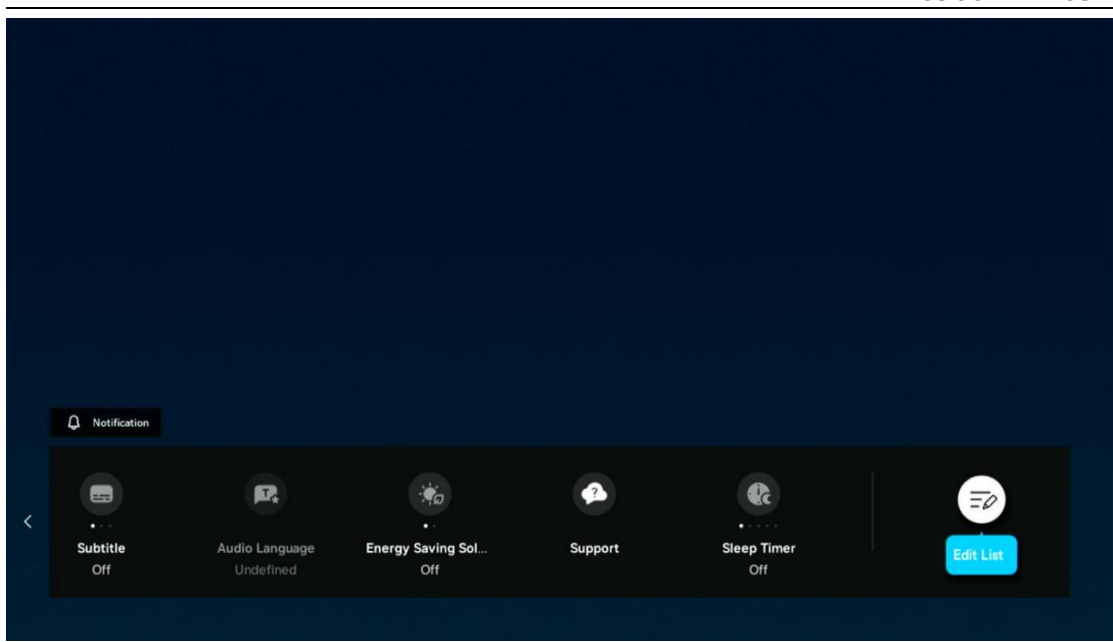

TV Setting

Press **SETTINGS** button to enter the TV Setting.

Press **▼/▲** button to highlight the desired menu icon , and press **OK** button to select.

(Optional:Picture/Sound/Connection/Broadcasting/General&Privacy/Support)

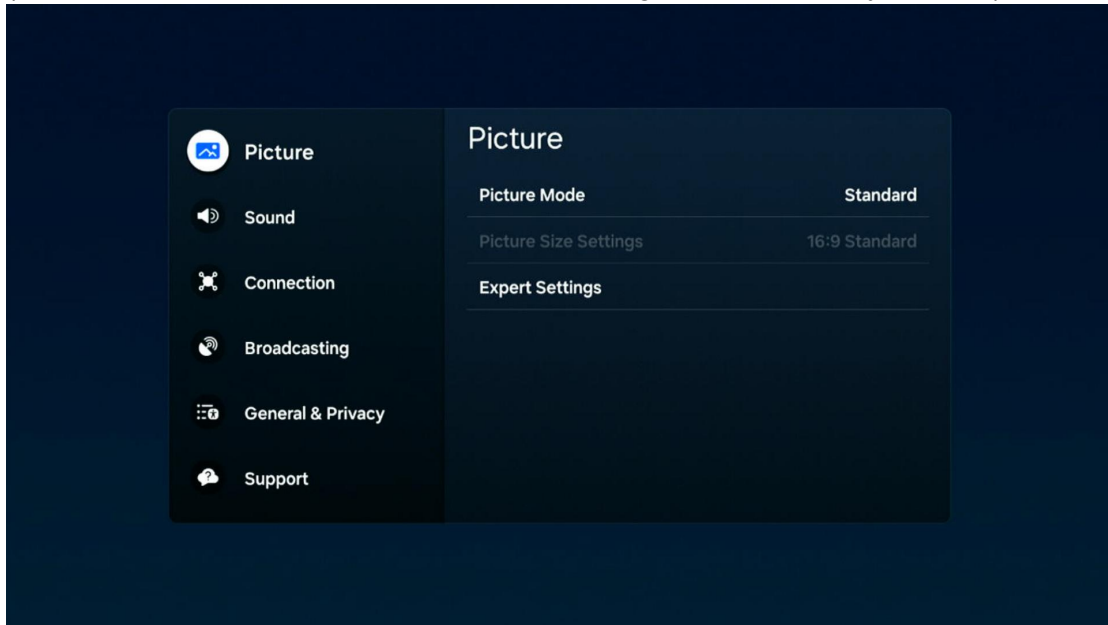

Picture

Press **SETTINGS** button to enter the main menu.

Press **▼/▲** button to select the Picture.

Press **OK** button to enter the sub-menu.

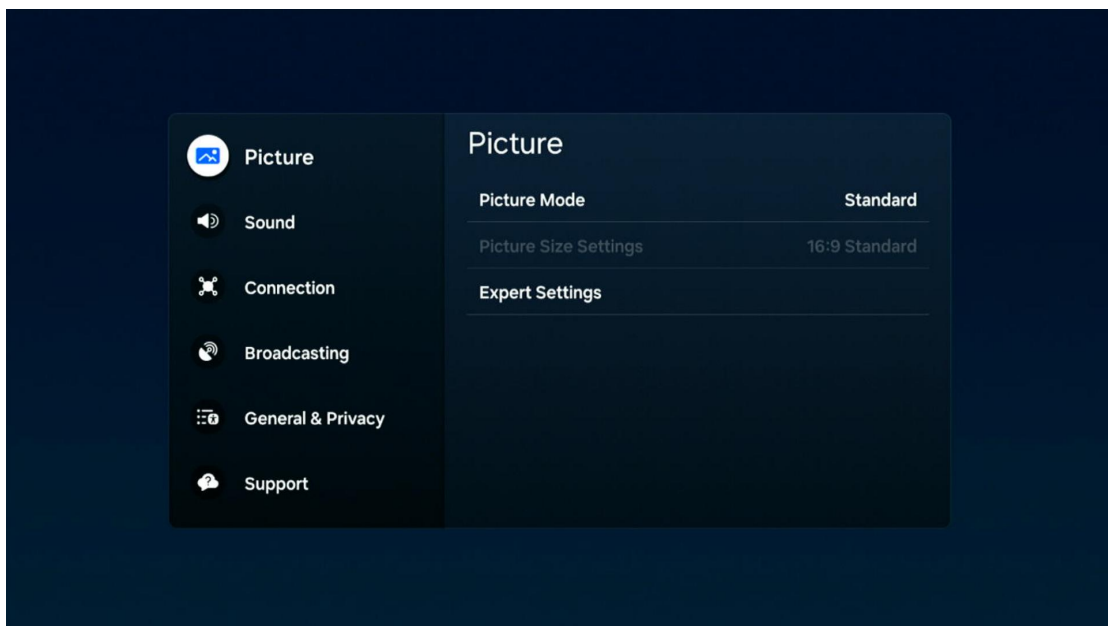

Press ▼/▲ button to select Picture Mode/Picture Size Settings/Expert Settings.
Press **SETTINGS** or **EXIT** button to quit.

Picture Mode

Highlight the item and press **OK** button to enter the sub-menu, that shows the picture mode you can choose.

Press ▼/▲ button to select Standard/Dynamic/Movie.

Standard	Is the default mode suitable for general viewing environments.
Dynamic	Makes the picture brighter and clearer in bright viewing environments.
Movie	Is suitable for watching TV or movies in a dark room.

Picture Size Settings

Press ▼/▲ button to select Picture Size Settings and press **OK** button to enter sub-menu.

Picture Size

Press ▼/▲ button to select Picture Size.

Press ▼/▲ button to select 16:9 Standard/4:3/Custom.

Auto Wide

Press ▼/▲ button to select Auto Wide.

Press ▼/▲ button to select On/Off.

4:3 Screen Size

Press ▼/▲ button to select 4:3 Screen Size.

Press ▼/▲ button to select 16:9 Standard/4:3/Zoom.

Fit to screen

Press ▼/▲ button to select Fit to screen.

Press ▼/▲ button to select On/Off.

Zoom and Position

Press ▼/▲ button to select Zoom and Position.

Press **OK** button to adjust.

(Note:This function is available only if Picture Size is set to Custom.)

Expert Settings

Press ▼/▲ button to select Expert Settings and press **OK** button to enter sub-menu.

Backlight/Contrast/Sharpness/Colour/Tint(G/R)

Press ▼/▲ button to select Backlight/Contrast/Sharpness/Colour/Tint(G/R).

Press ◀/▶ button to adjust.

Backlight	Adjust the Backlight of the image.
Contrast	Adjust the contrast of the image.
Sharpness	Adjust the edge sharpness of the image.
Colour	Adjust the colour intensity of the image.
Tint(G/R)	Adjust the ratio of green to red tint levels.

Apply Picture Settings

Press ▼/▲ button to select Apply Picture Settings.

Press ▼/▲ button to select All Sources/Current Source.

Noise Reduction

Press ▼/▲ button to select Noise Reduction.(Optional:Off/On)

Contrast Enhancer

Press ▼/▲ button to select Contrast Enhancer.

Press ▼/▲ button to select Off/Low/High.

Color Tone

Adjust the overall color of the image.

Press ▼/▲ button to select Color Tone.

Press ▼/▲ button to select Standard/Cool/Warm1/Warm2.

Cool	The picture is in favor of green-blue and less red. The whole color is in favor of light. The picture is more fresh and elegant.
Standard	The picture does not in favor of any color.The color is moderate.
Warm1	The picture is in favor of red-green and less blue to make the color more vivid and soft.
Warm2	Warm2 is bluer than Warm1 and looks more vivid.

White Balance

Adjust the color temperature of the picture so that white objects appear brighter.

Press ▼/▲ button to select White Balance.

Press ▼/▲ button to select 2 Point/10 Point Settings,then press **OK** button to enter sub-menu and press ▼/▲/◀/▶ to select and adjust.

Brightness

Press ▼/▲ button to select Brightness.

Press ◀/▶ button to adjust.

Reset Picture

Press ▼/▲ button to select Reset Picture.

Press ◀/▶ button to select reset or not.

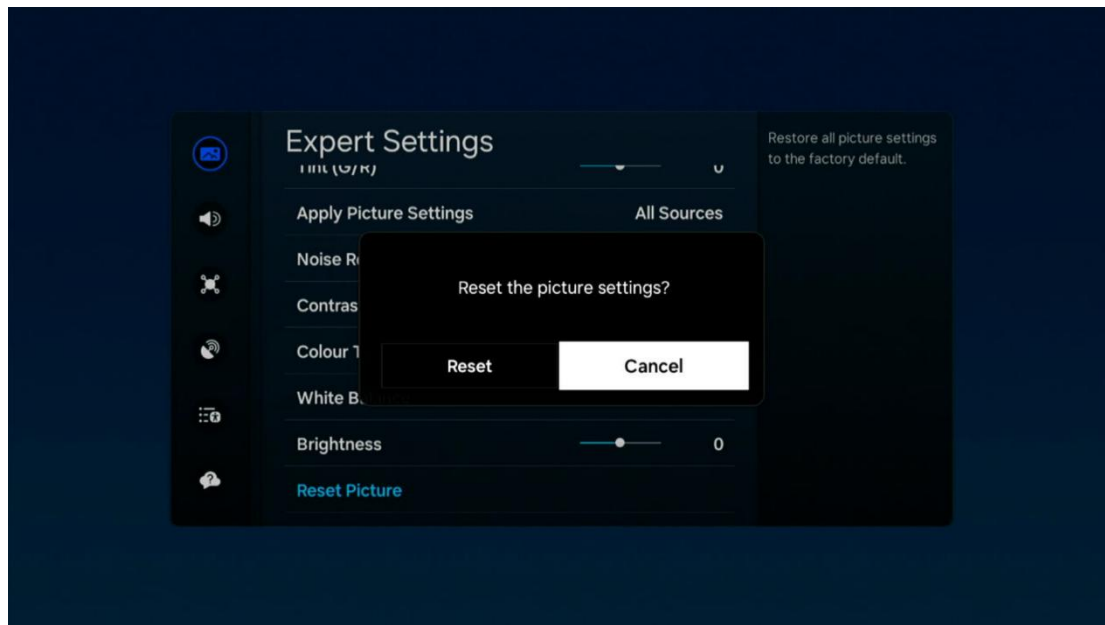

Sound

Press **SETTINGS** button to enter the main menu.

Press ▼/▲ button to select the Sound.

Press **OK** button to enter the sub-menu.

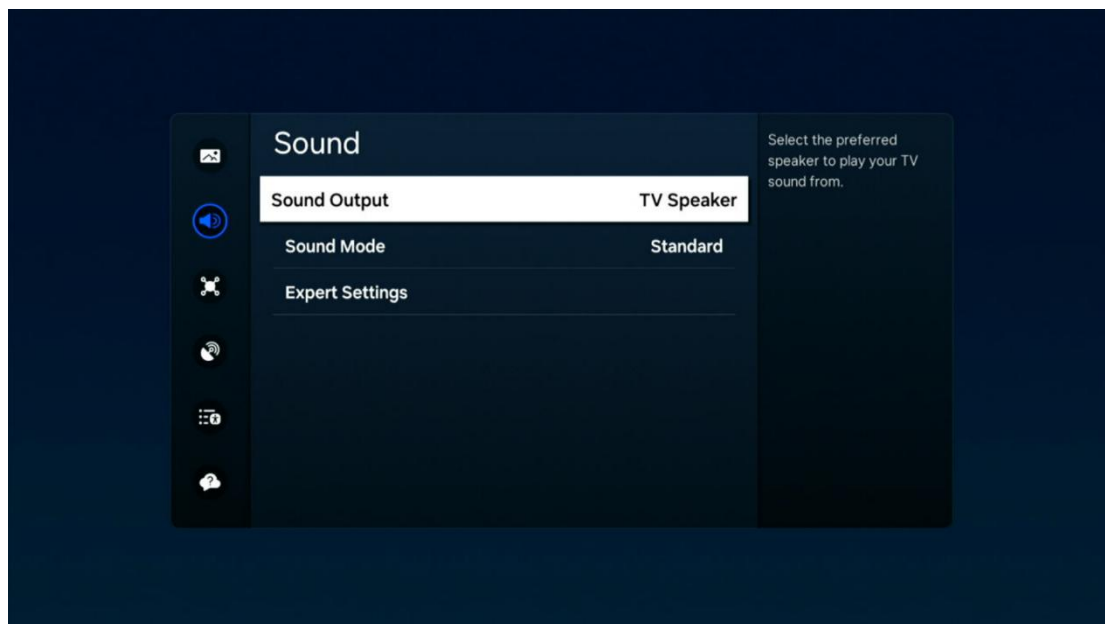

Press ▼/▲ button to select Sound Output/Sound Mode/Expert Settings.

Press **SETTINGS** or **EXIT** button to quit.

Sound Output

Press ▼/▲ button to select Sound Output.

Press ▼/▲ button to select TV Speaker/Receiver(Optical)/Bluetooth Speaker List.

Sound Mode

Press ▼/▲ button to select Sound Mode.

Press ▼/▲ button to select Standard/Optimised/Amplify.

Expert Settings

Press ▼/▲ button to select Expert Settings and press **OK** button to enter sub-menu.

Balance

Balanced left and right channels.

Press ▼/▲ button to select Balance.

Press **OK** button to enter sub-menu then press ◀/▶ button to adjust.

Equaliser

Press ▼/▲ button on to select Equaliser.

Press **OK** button to enter sub-menu then press ◀/▶ button to adjust.

HDMI-eARC Mode

Press ▼/▲ button to select HDMI-eARC Mode.

Press **OK** button to enter sub-menu then press ▼/▲ button to select Auto/Off.

Digital Output Audio Format

Press ▼/▲ button to select Digital Output Audio Format.

Press **OK** button to enter sub-menu then press ▼/▲ button to select PCM/Auto/Pass-through.

Digital Output Audio Delay

Press ▼/▲ button to select Digital Output Audio Delay. Press ◀/▶ button to adjust.

Auto Volume

Press ▼/▲ button to select Auto Volume. Press **OK** button to select On/Off.

Simultaneous Optical Output

Press ▼/▲ button to select Simultaneous Optical Output. Press **OK** button to select On/Off.

Reset Sound

Press ▼/▲ button to select Reset Sound.

Press **OK** button to enter sub-menu then press ◀/▶ button to select reset or not.

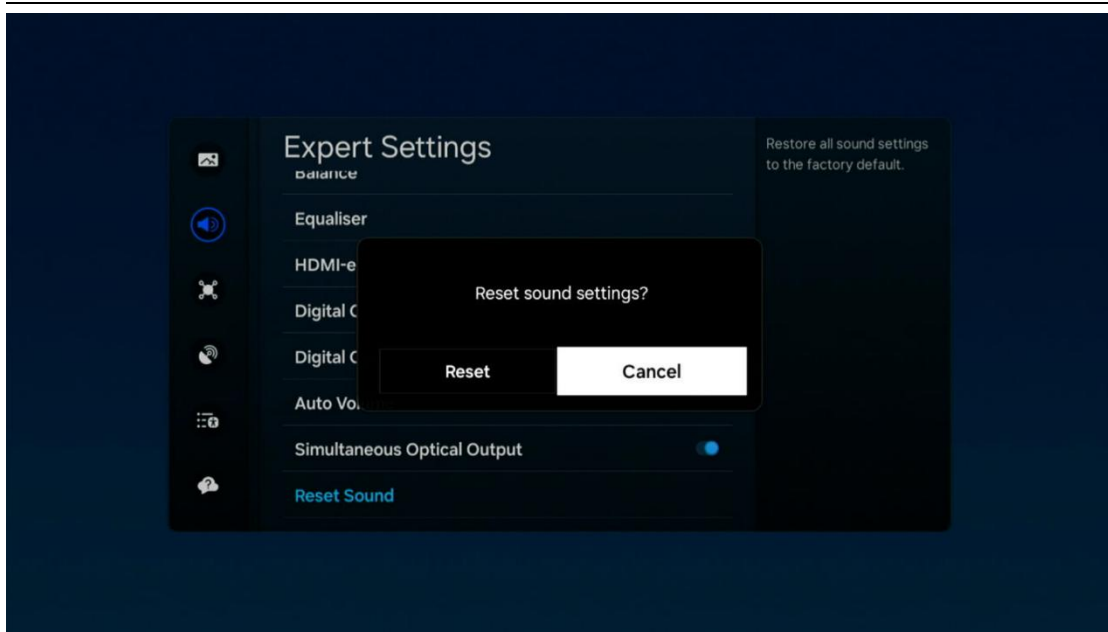

Connection

Press **SETTINGS** button to enter the main menu.

Press **▼/▲** button to select the Connection.

Press **OK** button to enter the sub-menu.

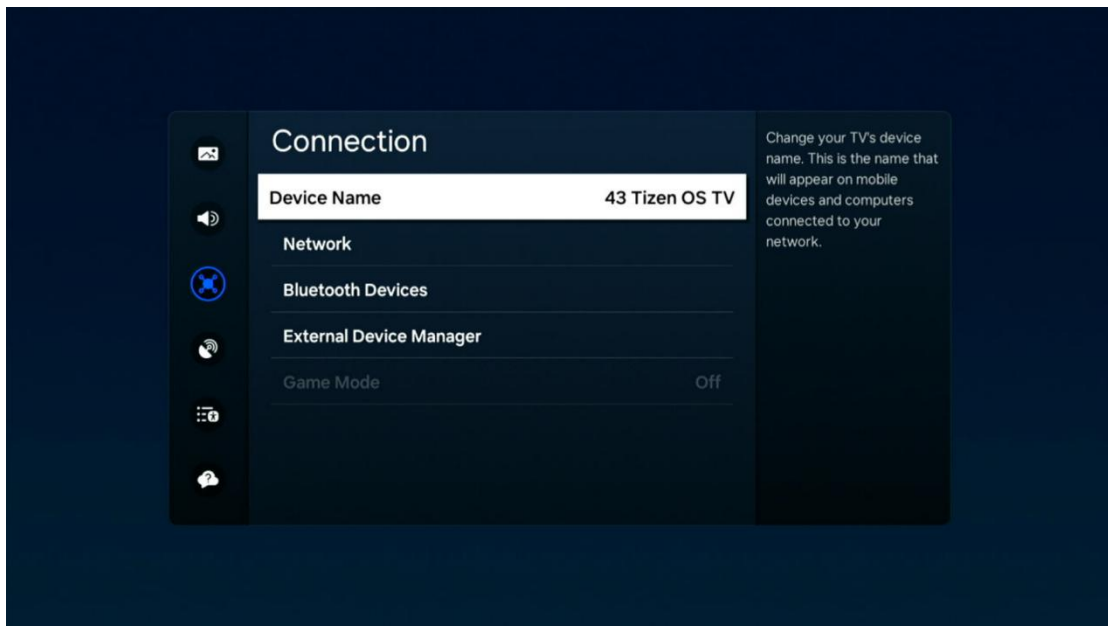

Press **▼/▲** button to select Device Name/Network/Bluetooth Device List/External Device Manager.

Press **SETTINGS** or **EXIT** button to quit.

Device Name

Press **▼/▲** button to select Device Name. Press **OK** button to select and change.

Network

Press ▼/▲ button to select Network. Press **OK** button to enter sub-menu.

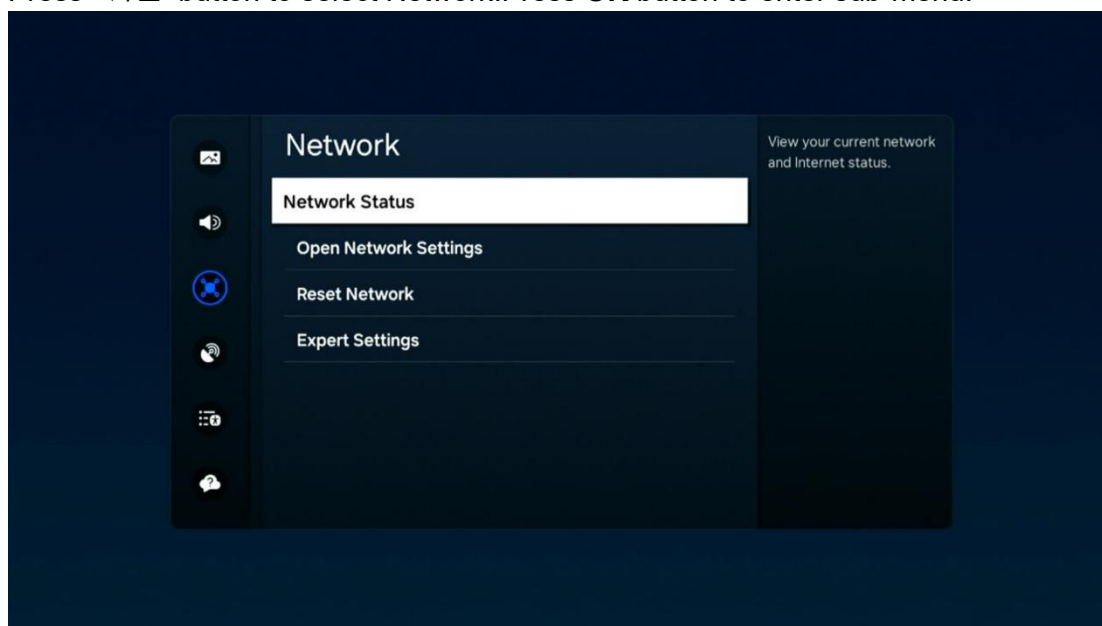

Network Status

Press ▼/▲ button to select Network Status. Press **OK** button to setup.

Open Network Settings

Press ▼/▲ button to select Open Network Settings. Press **OK** button to setup.

Reset Network

Press ▼/▲ button to select Reset Network. Press **OK** button to choose reset or not.

Expert Settings

Press ▼/▲ button to select Expert Settings. Press **OK** button to enter sub-menu.

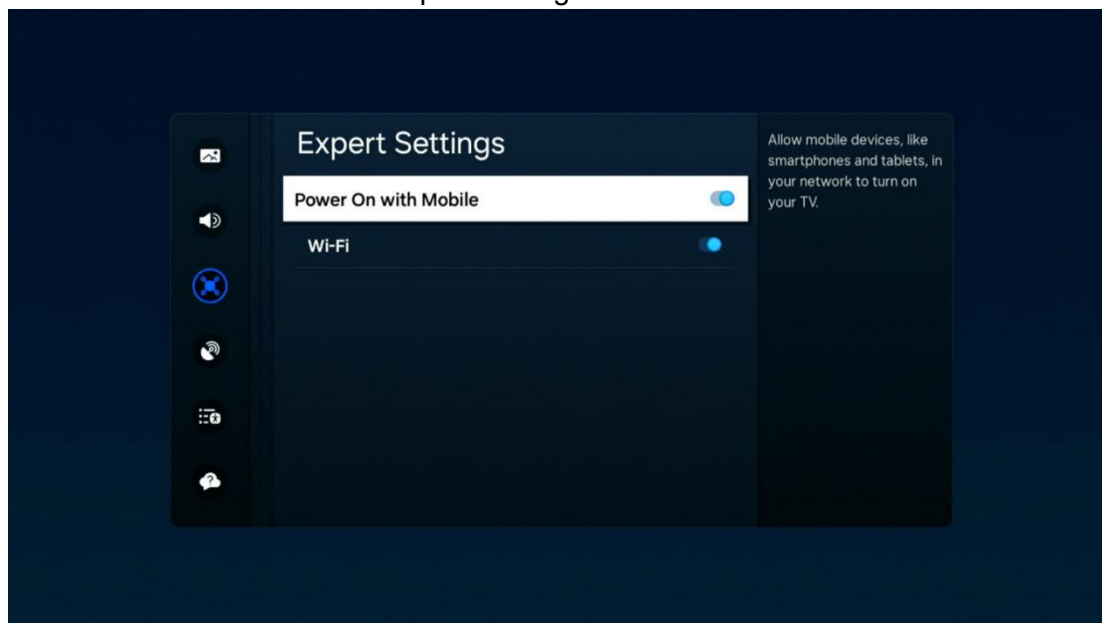

Bluetooth Device List

Press ▼/▲ button to select Bluetooth Device List. Press **OK** button to setup.

External Device Manager

Press ▼/▲ button to select External Device Manager. Press **OK** button to setup.

Broadcasting

Press **SETTINGS** button to enter the main menu.

Press ▼/▲ button to select the Broadcasting.

Press **OK** button to enter the sub-menu.



Press ▼/▲ button to select Auto Tuning Settings/Common Interface/Dual Sound/Expert Settings.

Press **SETTINGS** or **EXIT** button to quit.

Auto Tuning

Automatic search can search for effective program channel automatically.

Press ▼/▲ button to select Auto Tuning, then press **OK** button to start auto search.

If you want to stop searching, press Stop button to stop searching.

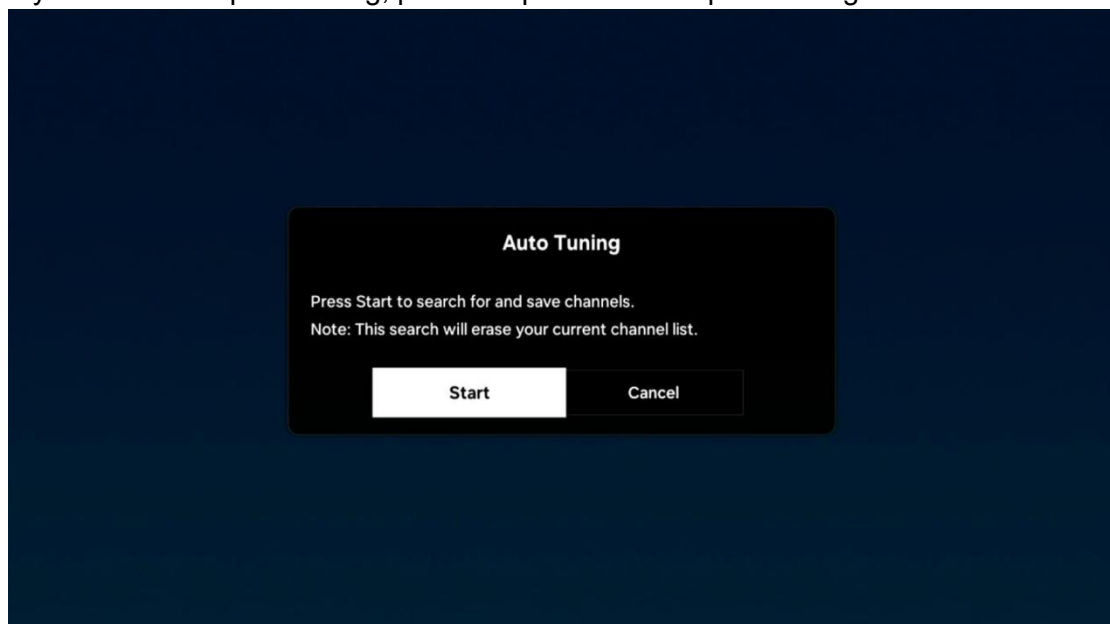

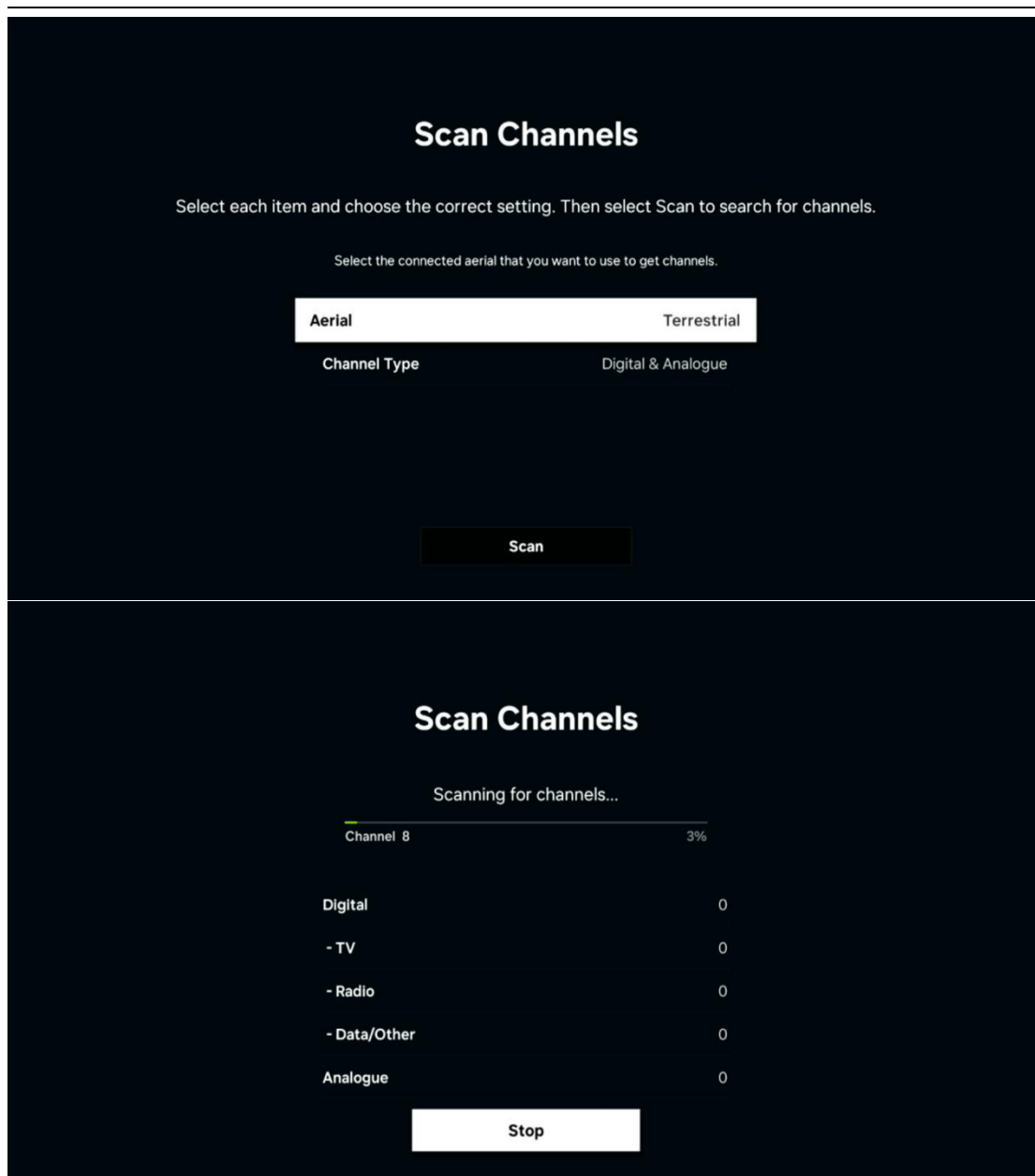

Common Interface

Press ▼/▲ button to select Common Interface, then sign in password to select.

Dual Sound

Press ▼/▲ button to select Dual Sound, then press **OK** button to enter and press ▼/▲ button to select .

Expert Settings

Press ▼/▲ button to select Expert Settings, then press **OK** button to enter sub-menu.

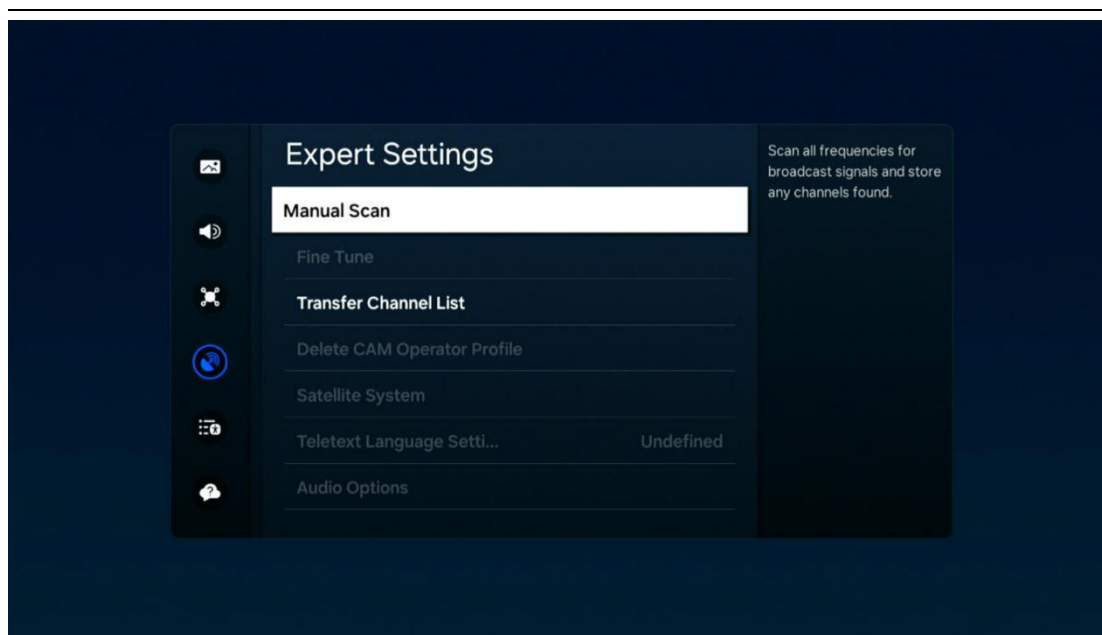

Manual Scan

You can scan for all the channels manually and store the scanned channels in the TV. Press ▼/▲ button to select Manual Scan. Press **OK** button to select.

Fine Tune

Press ▼/▲ button to select Fine Tune.

Fine-tuning analogue broadcasts, this function is only available for analogue broadcasts.

Transfer Channel List

Press ▼/▲ button to select Transfer Channel List. Press **OK** button to enter. (Optional: Import from USB/Export to USB)

Delete CAM Operator Profile

Press ▼/▲ button to select Delete CAM Operator Profile. Press **OK** button to enter.

Satellite System

Press ▼/▲ button to select Satellite System. Press **OK** button to enter.

Teletext Language Settings

Press ▼/▲ button to select Teletext Language Settings. Press **OK** button to enter.

HbbTV Settings

Press ▼/▲ button to select HbbTV Settings. Press **OK** button to enter sub-menu and select.

Audio Options

Press ▼/▲ button to select Audio Options. Press **OK** button to enter sub-menu.

General&Privacy

Press **SETTINGS** button to enter the main menu.

Press **▼/▲** button to select General&Privacy.

Press **OK** button to enter the sub-menu.

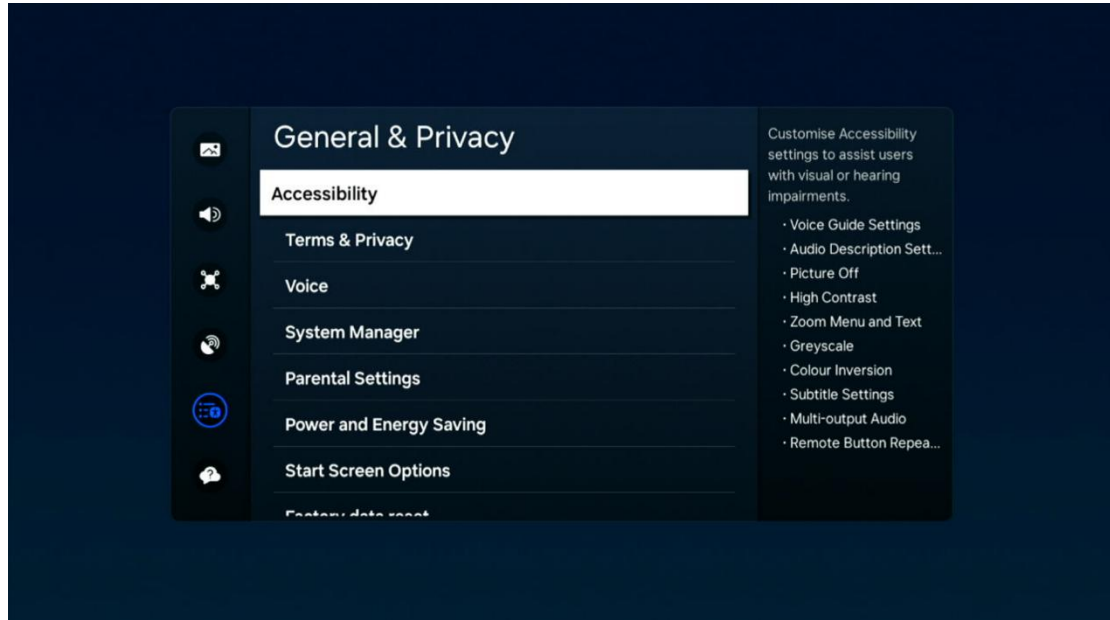

Press **▼/▲** button to select Accessibility/Terms&Privacy/Voice/System Manager/Parental Settings/Power and Energy Saving/Start Screen Options/Factory data reset.

Accessibility

Press **▼/▲** button to select Accessibility. Press **OK** button to enter sub-menu.

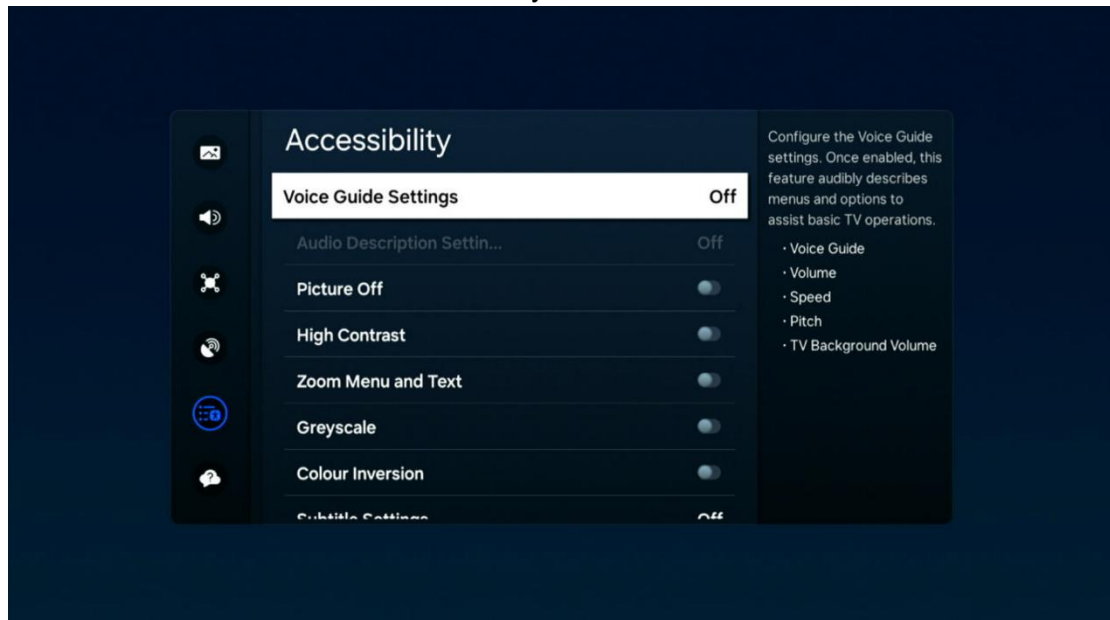

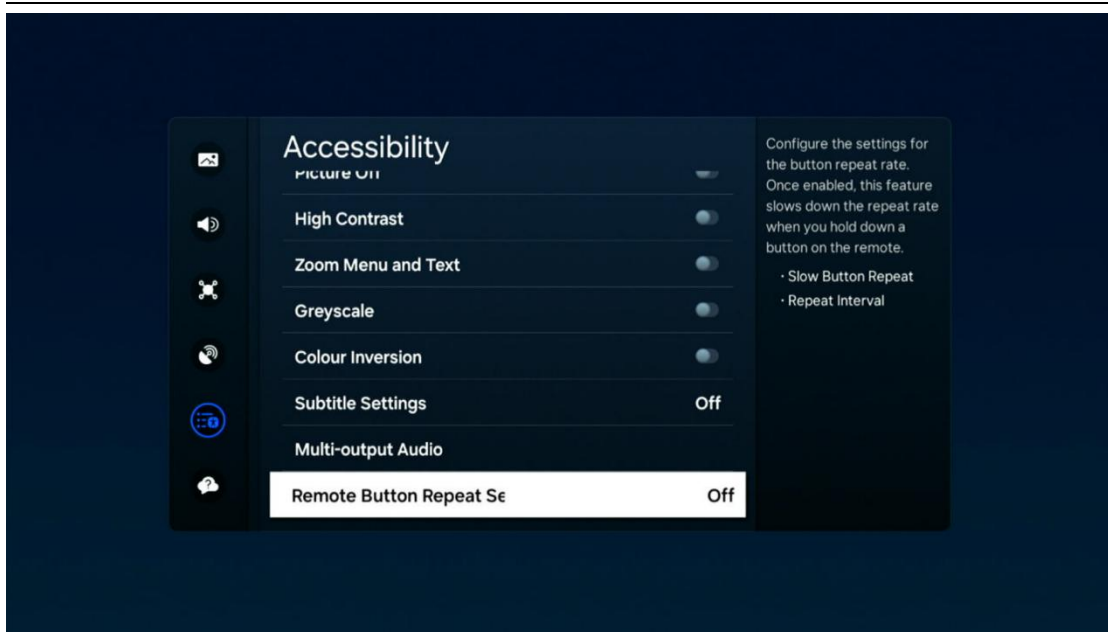

Voice Guide Settings

Press ▼/▲ button to select Voice Guide Settings. Press **OK** button to enter sub-menu.

(Optional: Voice Guide/Volume/Speed/Pitch/TV Background Volume)

Voice Guide

Press ▼/▲ button to select Voice Guide. Press **OK** button to select On/Off.

(The next function is available only if Voice Guide is set to On)

Volume

Press ▼/▲ button to select Volume. Press ▼/▲ button to select Loud/Medium/Soft.

Speed

Press ▼/▲ button to select Speed. Press ▼/▲ button to select Very Fast/Fast/Normal/Slow/Very Slow.

Pitch

Press ▼/▲ button to select Pitch. Press ▼/▲ button to select High/Medium/Low.

TV Background Volume

Press ▼/▲ button to select TV Background Volume.

Press ▼/▲ button to select Very Loud/Loud/Medium/Soft/Very Soft.

Audio Description Settings

Press ▼/▲ button to select Audio Description Settings. Press **OK** button to enter sub-menu to select.

Picture Off/High Contrast/Zoom Menu and Text/Greyscale/Colour Inversion

Press ▼/▲ button to select. Press **OK** button to select On/Off.

Subtitle Settings

Press ▼/▲ button to select Subtitle Settings. Press **OK** button to enter sub-menu to select.

Multi-output Audio

Press ▼/▲ button to select Multi-output Audio. Press **OK** button to enter sub-menu.

Remote Button Repeat Settings

Press ▼/▲ button to select Remote Button Repeat Settings. Press **OK** button to select On/Off.

Terms&Privacy

Press ▼/▲ button to select Terms&Privacy. Press **OK** button to enter sub-menu.
Press ▼/▲ button to select view information.

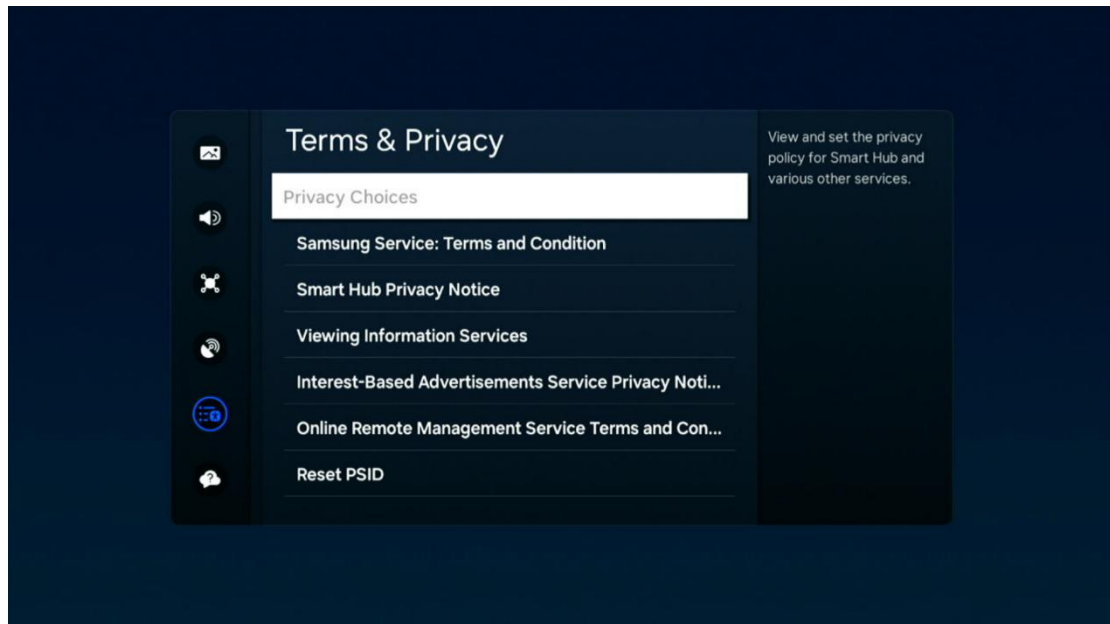

Voice

Press ▼/▲ button to select Voice. Press **OK** button to enter sub-menu.

System Manager

Press ▼/▲ button to select System Manager. Press **OK** button to enter sub-menu.

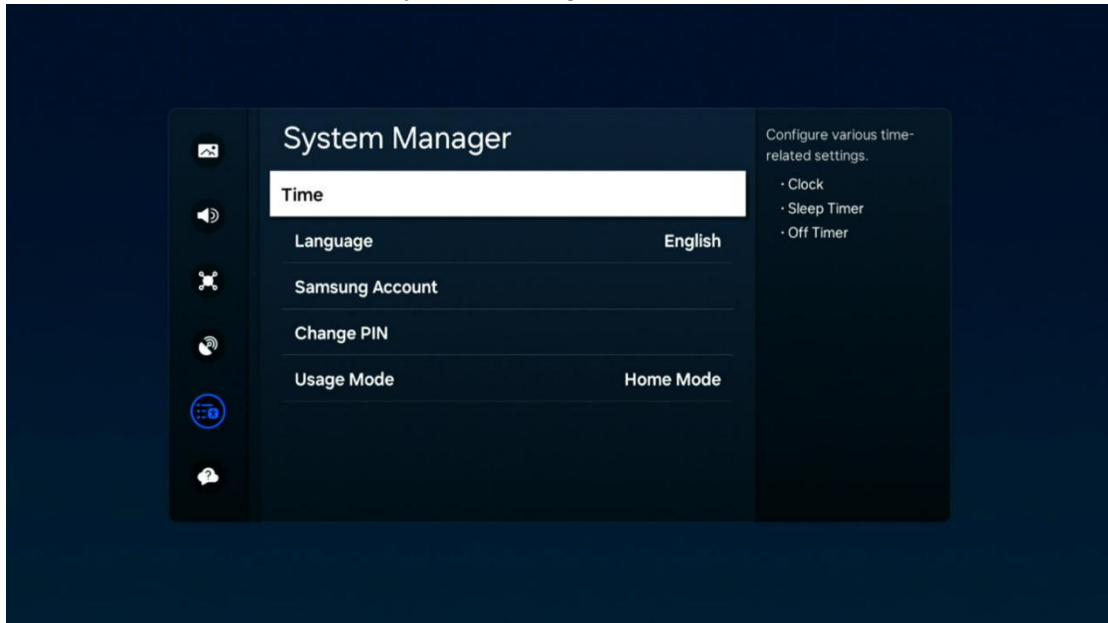

Press ▼/▲ button to select Time/Language/Samsung Account/Change PIN/Usage Mode.

Time

Press ▼/▲ button to select Time. Press **OK** button to enter sub-menu.
(Optional: Clock/Sleep Timer/Off Timer)

Clock

Press ▼/▲ button to select Clock. Press **OK** button to enter sub-menu then press ▼/▲ button to setup.

Sleep Timer

Press ▼/▲ button to select Sleep Timer. Press **OK** button to enter sub-menu.
Press ▼/▲ button to select.
(Optional: Off/30/60/120/180 minutes)

Off Timer

You can set Off Timer to shut off the TV automatically at a specific time.
Off Timer is only available if the Clock has been set.
Press ▼/▲ button to select Sleep Timer. Press **OK** button to enter sub-menu.

Language

Press ▼/▲ button to select Language. Press **OK** button to enter then press ▼/▲ button to select.

Samsung Account

Press ▼/▲ button to select Samsung Account. Press **OK** button to setup.

Change PIN

Press ▼/▲ button to select Change PIN. Press **OK** button to set Password.

Usage Mode

Press ▼/▲ button to select Usage Mode. Press ▼/▲ button to select Home Mode/Retail Mode.

Parental Settings

Press ▼/▲ button to select Parental Settings. Press **OK** button to enter sub-menu.

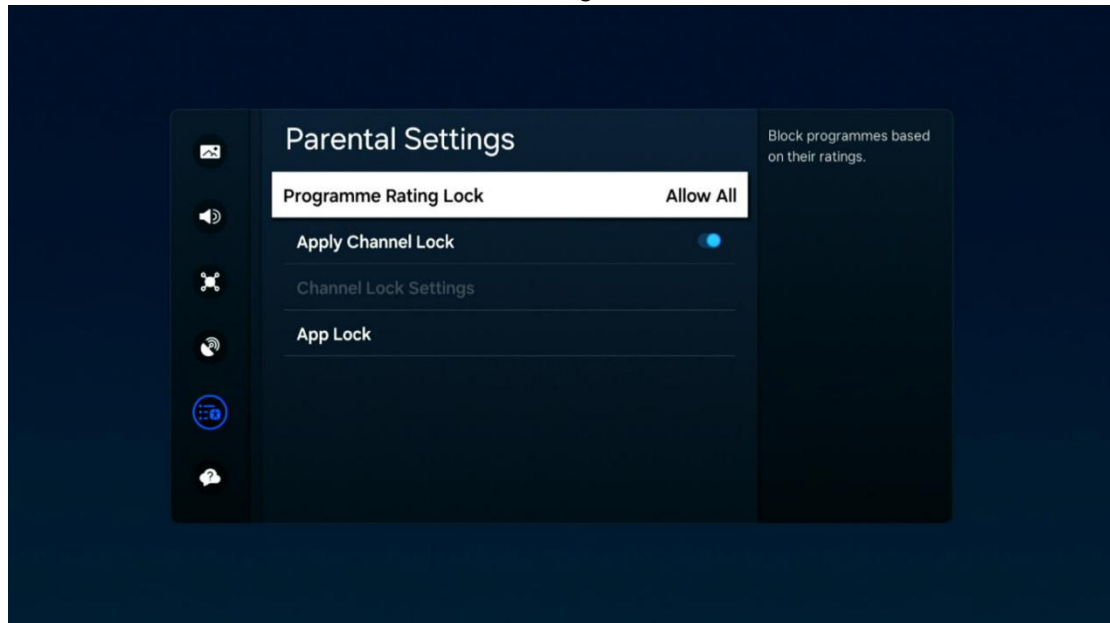

Press ▼/▲ button to select Programme Rating Lock/Apply Channel Lock/Channel Lock Settings/App Lock.

Programme Rating Lock

Press ▼/▲ button to select Programme Rating Lock. Press **OK** button to enter sub-menu.

Apply Channel Lock

Press ▼/▲ button to select Apply Channel Lock. Press **OK** button to select On/Off.

Channel Lock Settings

Press ▼/▲ button to select Channel Lock Settings. Press **OK** button to enter sub-menu.

App Lock

Press ▼/▲ button to select App Lock. Press **OK** button to enter sub-menu.

Power and Energy Saving

Press ▼/▲ button to select Power and Energy Saving. Press **OK** button to enter sub-menu.

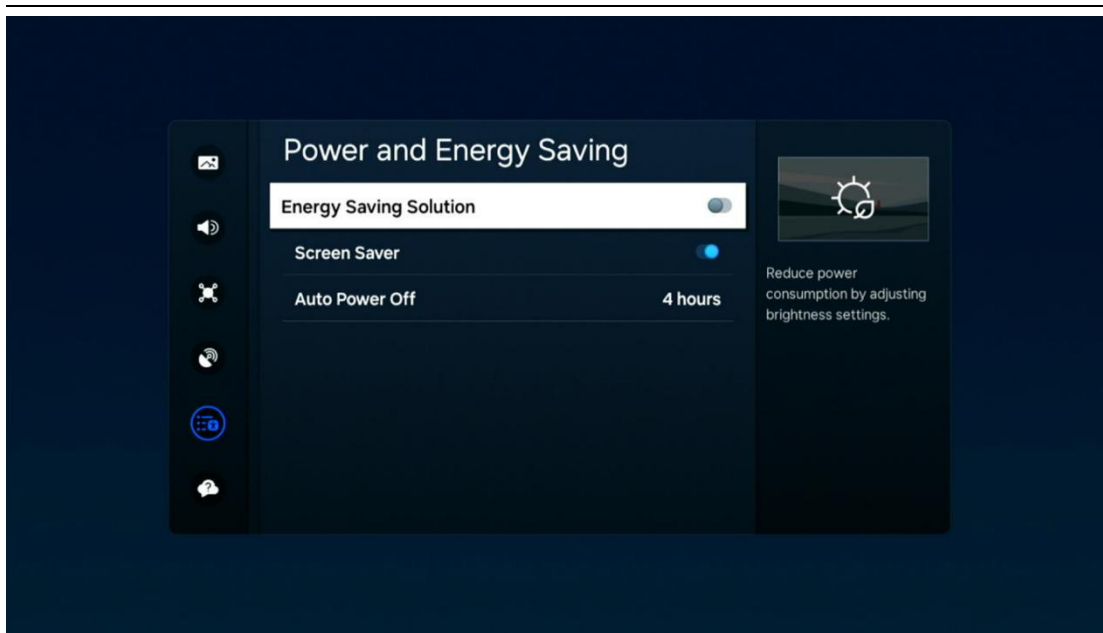

Press ▼/▲ button to select Energy Saving Solution/Screen Saver/Auto Power off.

Energy Saving Solution/Screen Saver

Press ▼/▲ button to select. Press **OK** button to select On/Off.

Auto Power off

Press ▼/▲ button to select Auto Power Off. Press ▼/▲ button to select Off/4 hours/6 hours/8 hours.

Start Screen Options

Press ▼/▲ button to select Start Screen Options. Press **OK** button to enter sub-menu.

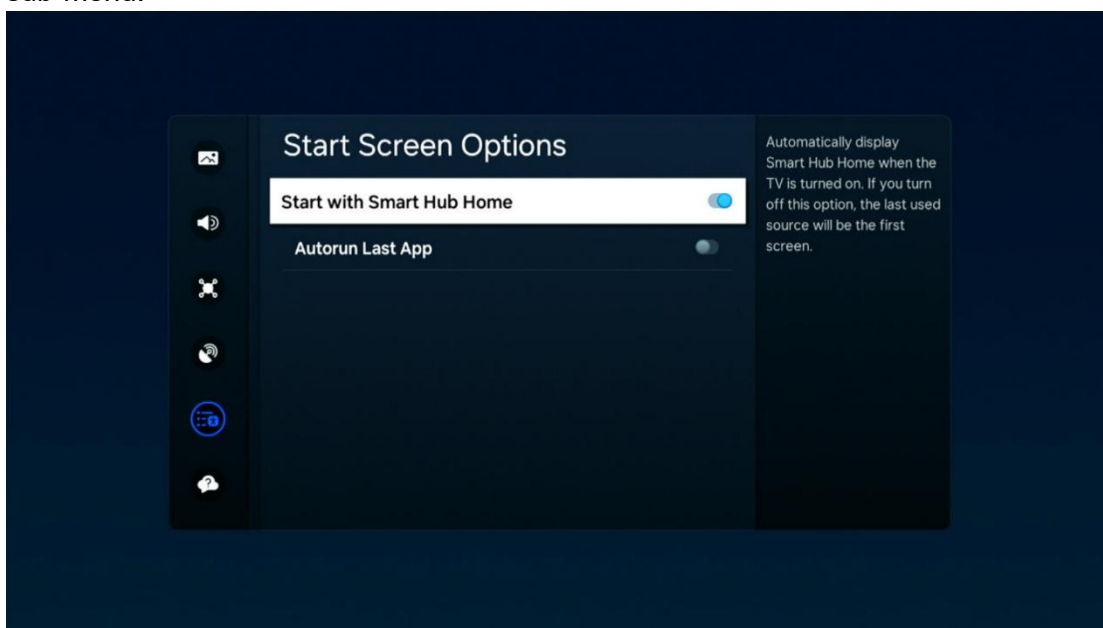

Press ▼/▲ button to select Start with Smart Hub Home/Autorun Last App.

Start with Smart Hub Home/Autorun Last App

Press ▼/▲ button to select. Press **OK** button to select On/Off.

Factory data reset

Press ▼/▲ button to select Factory data reset. Press **OK** button to enter password then choose reset or not. The default password is 0000.

After the reset, the boot screen is displayed again.

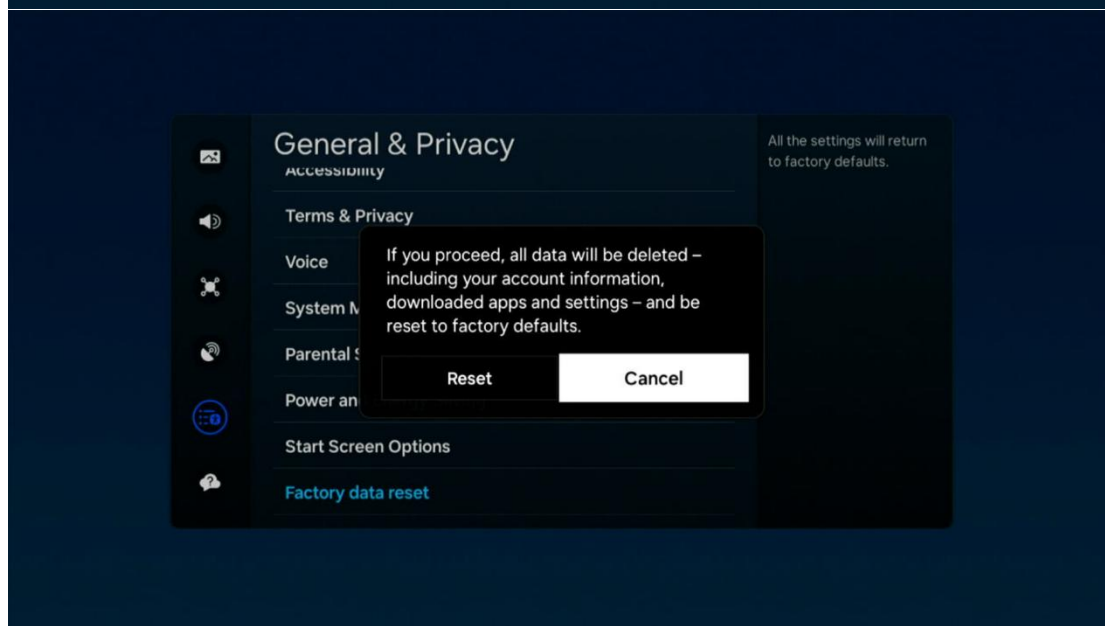
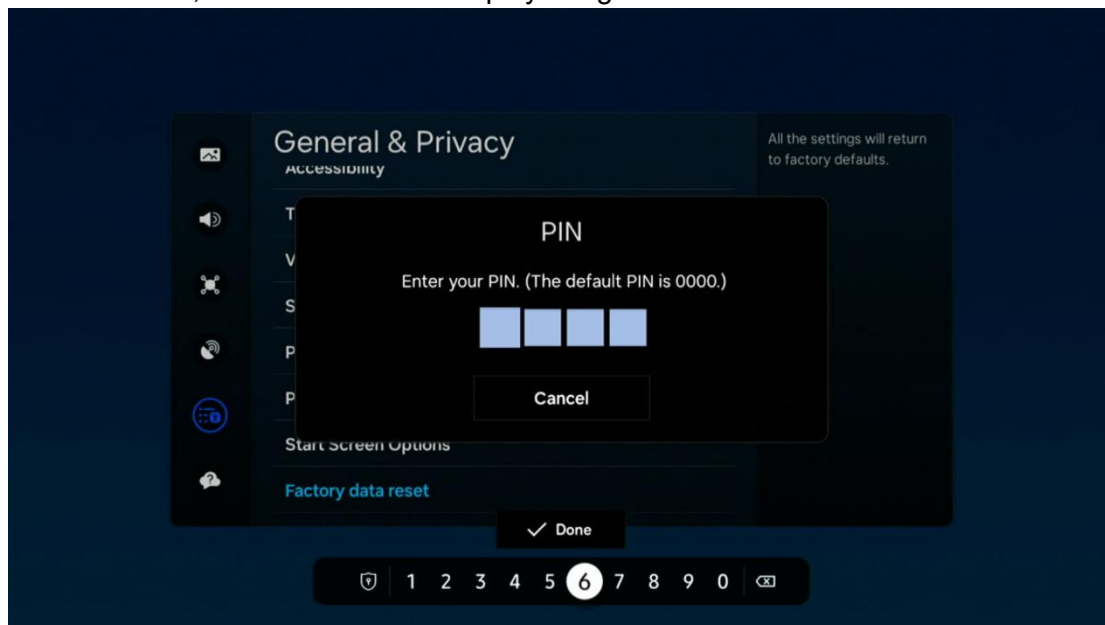

Support

Press **SETTINGS** button to enter the main menu.

Press **▼/▲** button to select Support.

Press **OK** button to enter the sub-menu.

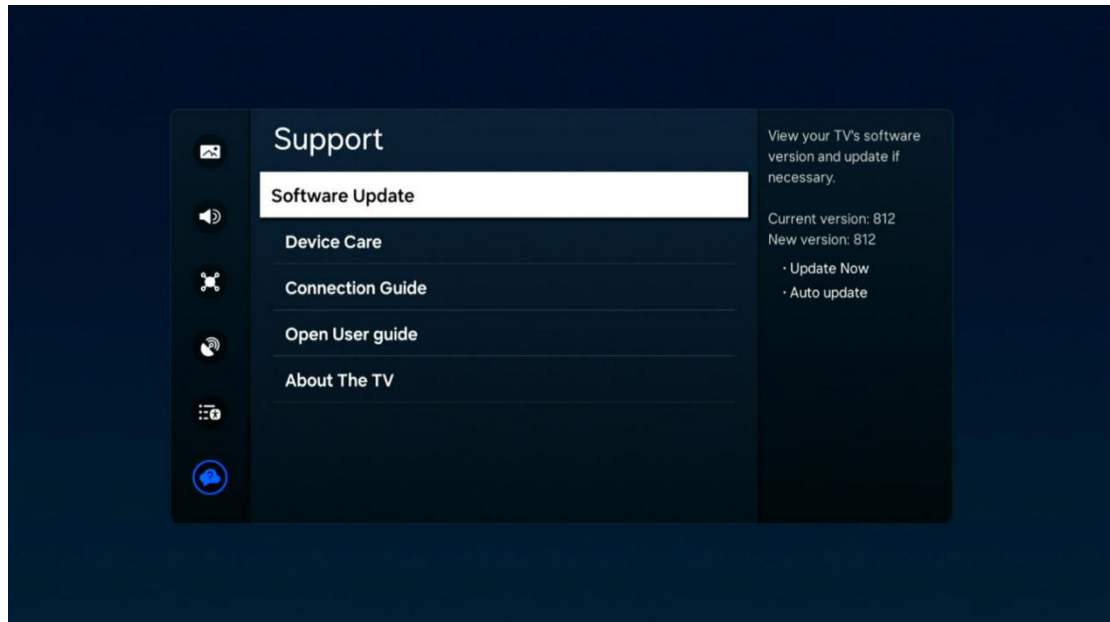

Press **▼/▲** button to select Software Update/Device Care/Connection Guide/Open User guide/About This TV.

Software Update

Press **▼/▲** button to select Software Update. Press **OK** button to enter sub-menu.
(Optional: Update Now/Auto update)

Device Care

Press **▼/▲** button to select Device Care. Press **OK** button to enter sub-menu.

Connection Guide

Press **▼/▲** button to select Connection Guide. Press **OK** button to enter sub-menu.

Open User guide

Press **▼/▲** button to select Open User guide. Press **OK** button to enter sub-menu.

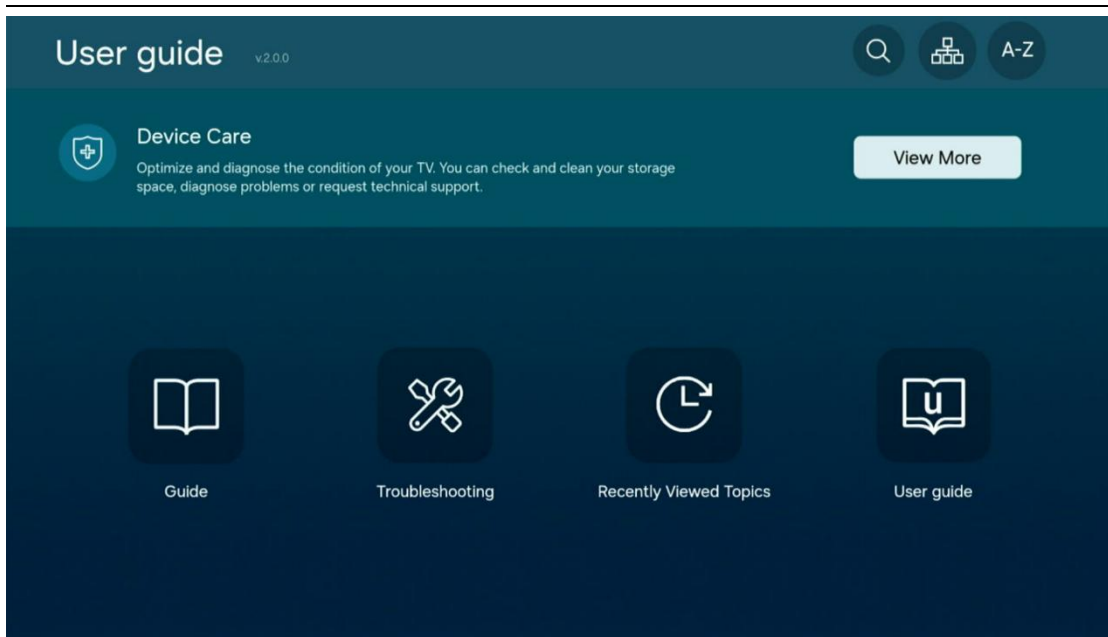

Guide

Press ◀/▶ button to select Guide. Press **OK** button to enter sub-menu.

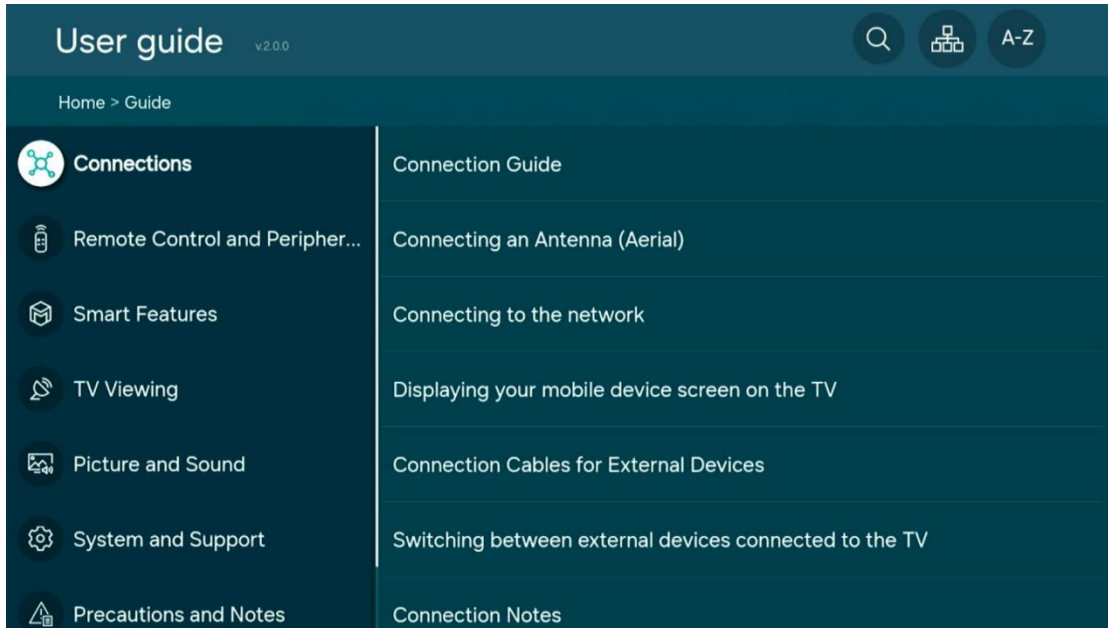

Troubleshooting

Press ◀/▶ button to select Troubleshooting. Press **OK** button to enter sub-menu.

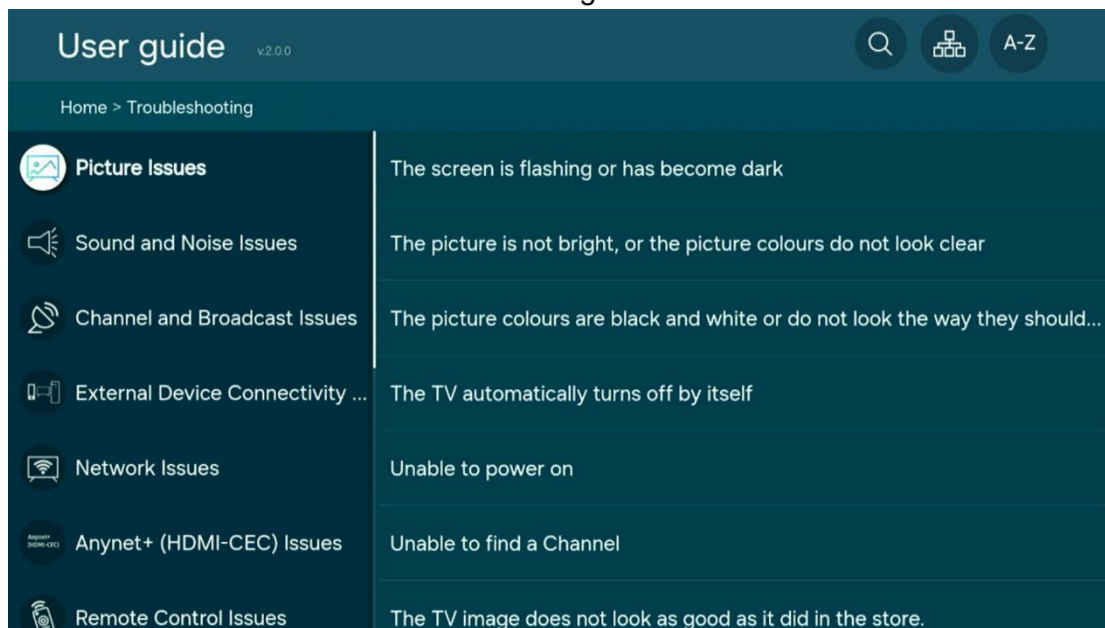

Recently Viewed Topics

Press ◀/▶ button to select Recently Viewed Topics. Press **OK** button to enter sub-menu.

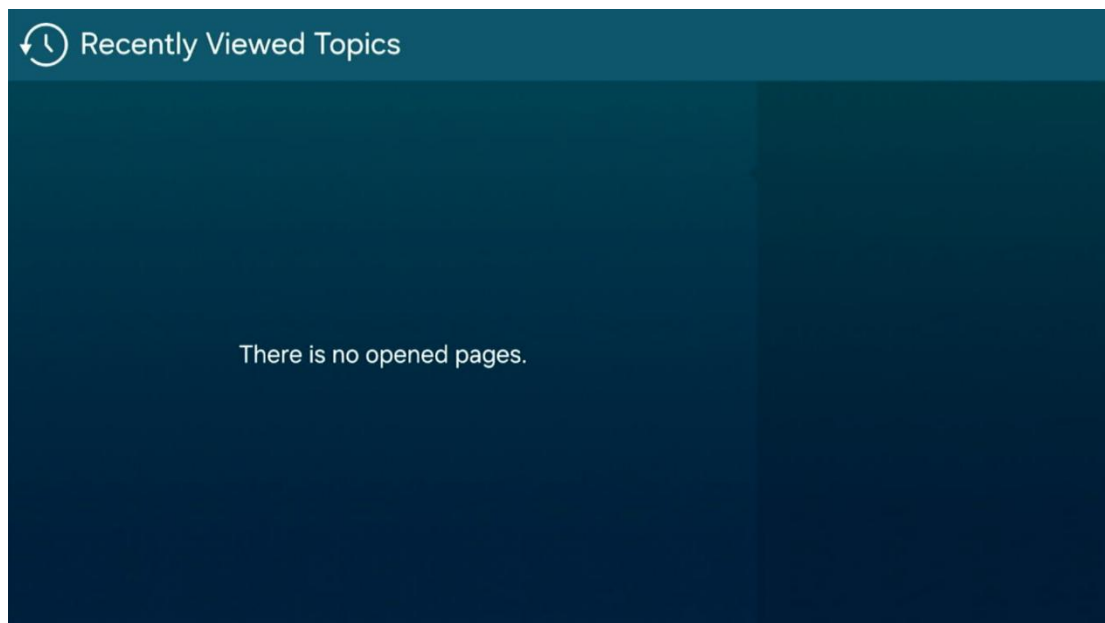

User guide

Press ◀/▶ button to select User guide. Press **OK** button to enter sub-menu. Then press ▼/▲ button to view the embedded e-Manual that contains information about your TV's key features.

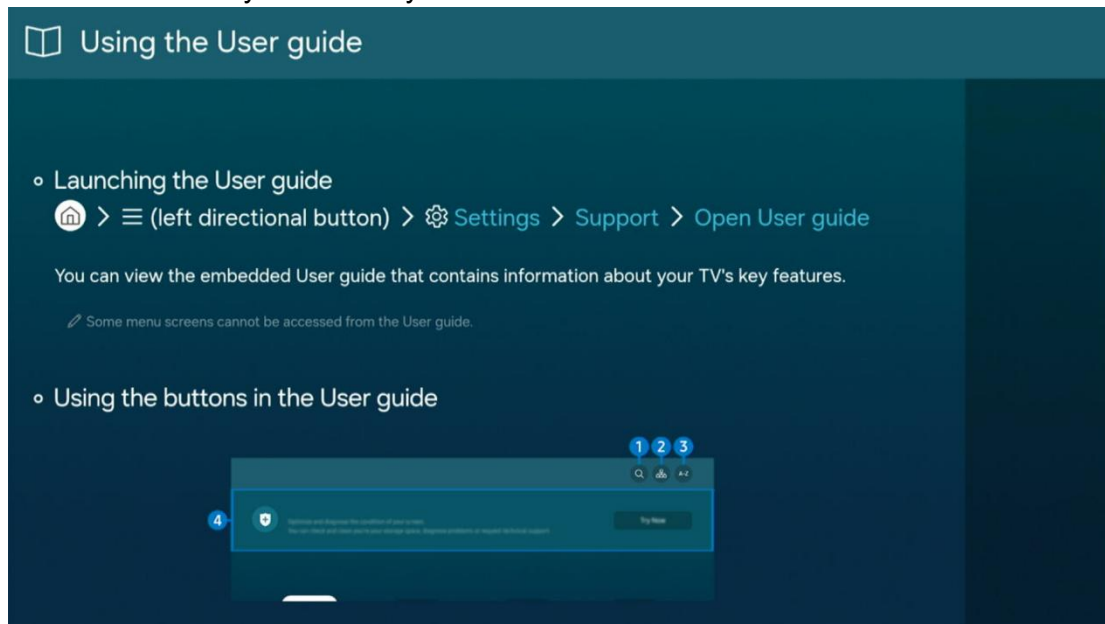

About This TV

Press ▼/▲ button to select About This TV. Press **OK** button to view.

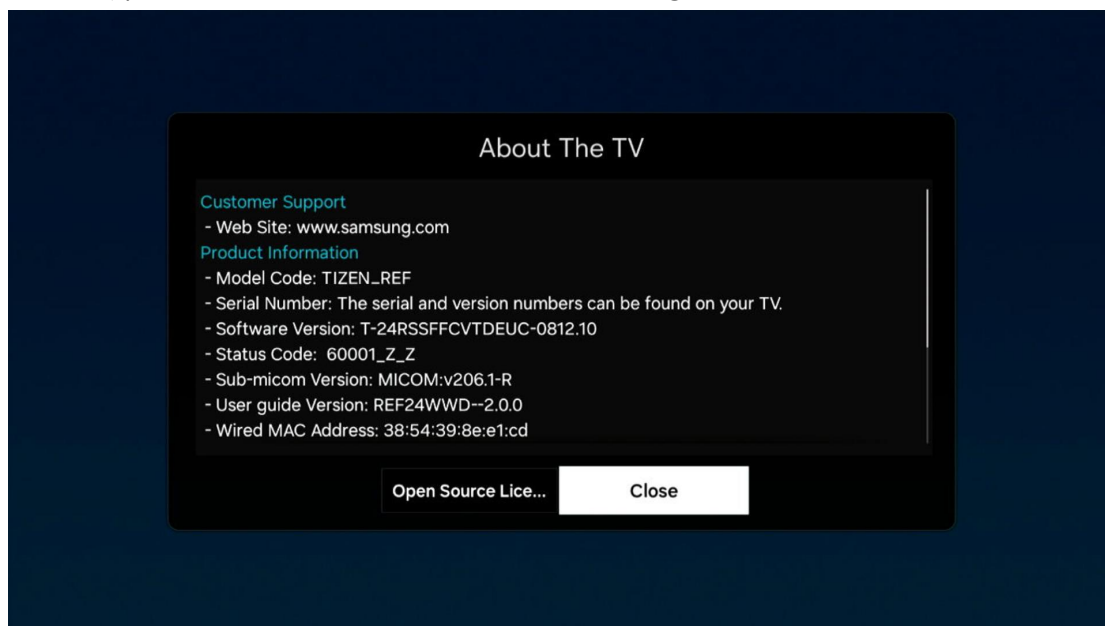

Specifications

EAN	5060750405048
Model No.	C22TZR-VOY
Max. Resolution	1920 x 1080
HD Ready/ Full HD	Full HD
Contrast Ratio	3000:1
Brightness(TYP cd/m2)	180
Display Colors	16.7M
Viewing Angle(L/R/U/D)	89/89/89/89(CR \geq 10)
Cabinet Color	Piano Black
Wall Mounting Support	100 x 100mm(M4 x 8)
TV System	DVB-T & DVB-C & DVB-S2 & DVBT2
Stereo System	Yes
Audio Output	2 x 6W
RF Antenna	2
HDMI	2 (ver1.4a)
CVBS	1
Digital Audio out	1
USB	2
CI	1
RJ45	1
System	Tizen OS
OSD Language	English, Deutsch, Francais, Espanol, Portugese, Italian.
EPG (Electronic Program Guide)	7 days
Automatic Tuning	YES
Sleep Timer	YES(240min)
Power Supply	AC 100V-240V~ 50Hz/60Hz
Operation Power Consumption	15W TV, 6W Router, Combined 22W
Max power Consumption	48W
Standby Power Consumption	<0.5W TV

Safety Warnings

- Read all the instructions carefully before using the unit and keep them for future reference.
- Retain the manual. If you pass the unit onto a third party make sure to include this manual.
- Check that the voltage marked on the rating label matches your mains voltage.

Damage

- Please inspect the unit for damage after unpacking.
- Do not continue to operate the unit if you are in any doubt about it working normally, or if it is damaged in any way - switch off, withdraw the mains plug and consult your dealer.

Location of Unit

- The unit must be placed on a flat stable surface and should not be subjected to vibrations.
- Do not place the unit on sloped or unstable surfaces as the unit may fall off or tip over.
- The mains socket must be located near the unit and should be easily accessible.
- This unit is designed for indoor use only.

Temperature

- Avoid extreme degrees of temperature, either hot or cold. Place the unit well away from heat sources such as radiators or gas / electric fires.
- Avoid exposure to direct sunlight and other sources of heat.

Naked Flames

- Never place any type of candle or naked flame on the top of or near the unit.

Moisture

- To reduce the risk of fire, electric shock or product damage, do not expose this unit to rain, moisture, dripping or splashing. No objects filled with liquids, such as vases, should be placed on the unit.
- If you spill any liquid into the unit, it can cause serious damage. Switch it off at the mains immediately. Withdraw the mains plug and consult your dealer.

Ventilation

- To prevent the risk of electric shock or fire hazard due to overheating, ensure that curtains and other materials do not obstruct the ventilation vents.
- Do not install or place this unit in a bookcase, built-in cabinet or in another confined space. Ensure the unit is well ventilated.
- Make sure that there is a gap of at least 10 cm on both sides and a gap of 20 cm at the top.

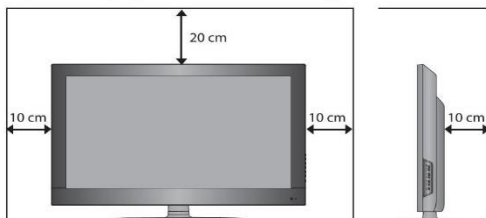

Safety

- Always disconnect the unit from the mains supply before connecting / disconnecting other devices or moving the unit.
- Unplug the unit from the mains socket during a lightning storm.

Mains Cable

- Make sure the unit or unit stand is not resting on top of the mains cable, as the weight of the unit may damage the mains cable and create a safety hazard.
- If the mains cable is damaged it must be replaced by the manufacturer, its service agent, or similarly qualified persons in order to avoid a hazard.

Interference

- Do not place the unit on or near appliances which may cause electromagnetic interference. If you do, it may adversely affect the operating performance of the unit, and cause a distorted picture or sound.

Optimum viewing

- View the unit in moderate light to prevent eye strain. It is recommended to watch the unit from a distance 3-7 times that of the screen height.

LED screen

- The LED screen is manufactured using high-precision technology. However, some tiny black points and / or bright points (red, blue or green in colour) may constantly appear on the LED screen. These points are generated in the manufacturing process and are normal.

Screen Burn

- A characteristic of Plasma and LED TV Panels is that displaying the same image for a long time may cause a permanent after-image to remain on the screen. This is called screen burn. Most pictures shown on the unit will be constantly moving and fill the screen.
- Examples of images that you need to watch out for are as follows (this is not an all-inclusive list):
 1. **Black Bars:** If black bars appear at the left / right or top / bottom of the screen, it is recommended to change the format so that the picture fills the entire screen.
 2. **TV Channel Logos:** e.g. Shopping channel logos and pricing displays - especially if they are bright and stationary. Moving or low-contrast graphics are less likely to cause ageing of the screen.
 3. **Time Displays**
 4. **Teletext:** Do not view a stationary page for long periods of time.
 5. **TV Menus**
 6. **Pause Mode:** Do not leave the screen in pause mode for long periods of time, e.g. when watching videos.
- To prevent screen burn if viewing any of the above for long periods of time, reduce contrast and brightness when viewing. Once burn-in occurs it will never disappear completely.

Headphones

- Listening to loud sounds for prolonged periods of time may permanently damage your hearing.
- Before putting on headphones, turn the volume down then put the headphones on and slowly increase the volume until you reach a comfortable listening level.

Standby

- The  button on the remote control does not switch off the unit completely. The unit will continue to draw electricity from the mains supply while in standby. In the interests of safety and to avoid unnecessary energy consumption, never leave the unit in standby while unattended for long periods of time, e.g. overnight, while on holiday or while out of the house. Switch it off and disconnect the mains plug from the mains socket.

Batteries

- Batteries used in the remote control for this unit are easily swallowed by young children and this is dangerous.
- Keep loose batteries away from young children and make sure that the battery holder tray is secure in the remote control. Seek medical advice if you believe a cell has been swallowed.
- Please dispose of batteries correctly by following the guidance in this manual.

Supervision

- Children should be supervised to ensure that they do not play with the unit and the remote control.
- Never let anyone especially children push anything into the holes, slots or any other openings in the case - this could result in a fatal electric shock.



The lightning flash with arrowhead symbol, within an equilateral triangle, is intended to alert the user to the presence of uninsulated "dangerous voltage" within the unit's enclosure that may be of sufficient magnitude to constitute a risk of electric shock.



The exclamation point within an equilateral triangle is intended to alert the user to the presence of important operating and

Service

- To reduce the risk of electric shock, do not remove screws. The unit does not contain any user-serviceable parts. Please leave all maintenance work to qualified personnel.
- Do not open any fixed covers as this may expose dangerous voltages.

Maintenance

- Ensure to unplug the unit from the mains socket before cleaning.
- Do not use any type of abrasive pad or abrasive cleaning solutions as these may damage the unit's surface.
- Do not use liquids to clean the unit.

Important Note

This TV is fitted with the latest ECO friendly power saving technology. If whilst viewing the TV remote control is not used for a period of 4 hours, the Auto Standby feature will operate and power down the TV. A warning message will be displayed to inform you that the TV is about to power down.



Packaging materials are not toys. Please keep away from

Maintenance

Careful and regular cleaning can prolong the life of your TV.



Be sure to Disconnect the mains cable from the mains socket before any cleaning.

1. Use a soft dry cloth to wipe away the dust from the screen and surfaces.
2. If the surfaces are extremely dirty, clean the TV with a cloth which has been dipped in a weak soapy water. Wring the cloth until it is almost dry, then use it to wipe the TV.
3. Ensure there is no excess water on the screen. Allow any water or dampness to evaporate before switching the TV on.



Never use alcohol, benzene, paint-thinner, cleaning fluid or other chemicals. Do not use compressed air to remove dust.

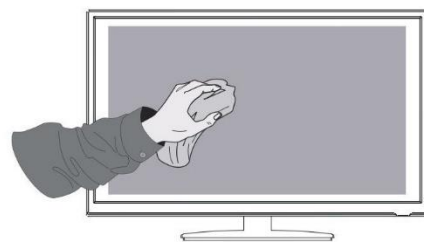

Waste Electrical Recycling

Correct disposal of Product



This sign indicates that this product may not be disposed of with your regular household waste. The recycling and separate collection of such products is your responsibility. Please drop off the above mentioned waste at a designated place for recycling waste electrical and electronic equipment. If you do not know where to drop off your waste equipment for recycling, please contact your local city office or household waste collection service.



Hg Cd Pb

The crossed out wheeled dust bin symbol indicates that batteries and /or accumulators must be collected and disposed of separately from household waste.

If the battery or accumulator contains more than the specified values of lead (Pb), mercury (Hg), and/or cadmium (Cd) defined in the Battery Directive (2006/66/EC), then the chemicals symbols for lead(Pb), mercury (Hg) and/or cadmium (Cd) will appear below the crossed out wheeled dust bin symbol.



Pb

By participating in separate collection of batteries, you will help to assure the proper disposal of products and batteries thus help to prevent potential negative consequences for the environment and human health.

For more detailed information about the collection and recycling programmes available in your country, please contact your local city office or the shop where you purchased this product.



This appliance complies with European Safety and Electrical directives.

It fulfills the following EU regulations:

EN 55032:2015
EN IEC6100-3-2:2019
EN 6100-3-3:2013
EN 55035:2017
EN 60065:2014+A11:2017