



# ROKSAN

## Caspian Series 4G

Caspian Streaming Pre-Amplifier  
Caspian Streaming Amplifier  
Caspian Integrated Amplifier

Product Manual

EN

Register your Roksan products  
to ensure the best possible product and customer support

Register your product using the QR code  
or visit [roksan.com/registration](https://roksan.com/registration)



## Welcome to Caspian Series 4G

Thank you for purchasing Caspian Series 4G, you're now ready to start your journey to breathtaking sound.

Caspian Series 4G is built for the user. Three distinctly sleek, modern, and ultra-minimal Roksan designs, house advanced feature sets aimed at delivering true, high-fidelity audio.

In this product manual, you'll find information about setting up your system and how to maintain your products for a lifetime of enjoyment.

If you need any further assistance, please contact our technical team at:  
[roksan.com/support](https://roksan.com/support)

### Contents

Unboxing	2
Placement	4
Controls overview	6
Connections overview	8
Input connections	10
Output connections	12
Remote control	14
Waking from standby	16
Setting up MaestroUnite	18
Adding additional equipment to your system	20
Input and volume selection	22
Setting up & using BluOS	24
On-screen menu	26
Changing remote battery	28
Care & maintenance	30
Warranty	31
Specifications	32

## Unboxing

Before you unpack your product, please make sure that there is plenty of clean surface area available.

### Inside the box

1. Caspian Amplifier
2. Remote Control (incl. 2 x AAA batteries)
3. Mains Power Cord
4. Quick Start Guide
5. Safety Instructions

### AC Mains Supply

This product operates with an auto-ranging power supply. The mains power cord supplied with this product has an IEC C13 mains plug which is inserted into the mains input socket on the unit's rear panel. The other end is a moulded plug appropriate to that of your country.

If your mains power cord has been damaged, please obtain a replacement cord from your Roksan Authorised Specialist.

**⚠ NOTE: Ensure correct connection of the live (L), neutral (N), and earth (PE) conductors in your mains supply.**

The mains fuses are located on the rear panel below the IEC mains input socket. These must only be replaced by the fuse type and rating as described on the fuse rating label on the rear panel of the unit.

If the equipment is likely to be unused for some time, unplug it from the mains power supply.

**⚠ NOTE: This unit contains no user serviceable parts. Do not remove any panels or attempt to service it yourself. Unauthorised servicing will void the warranty.**

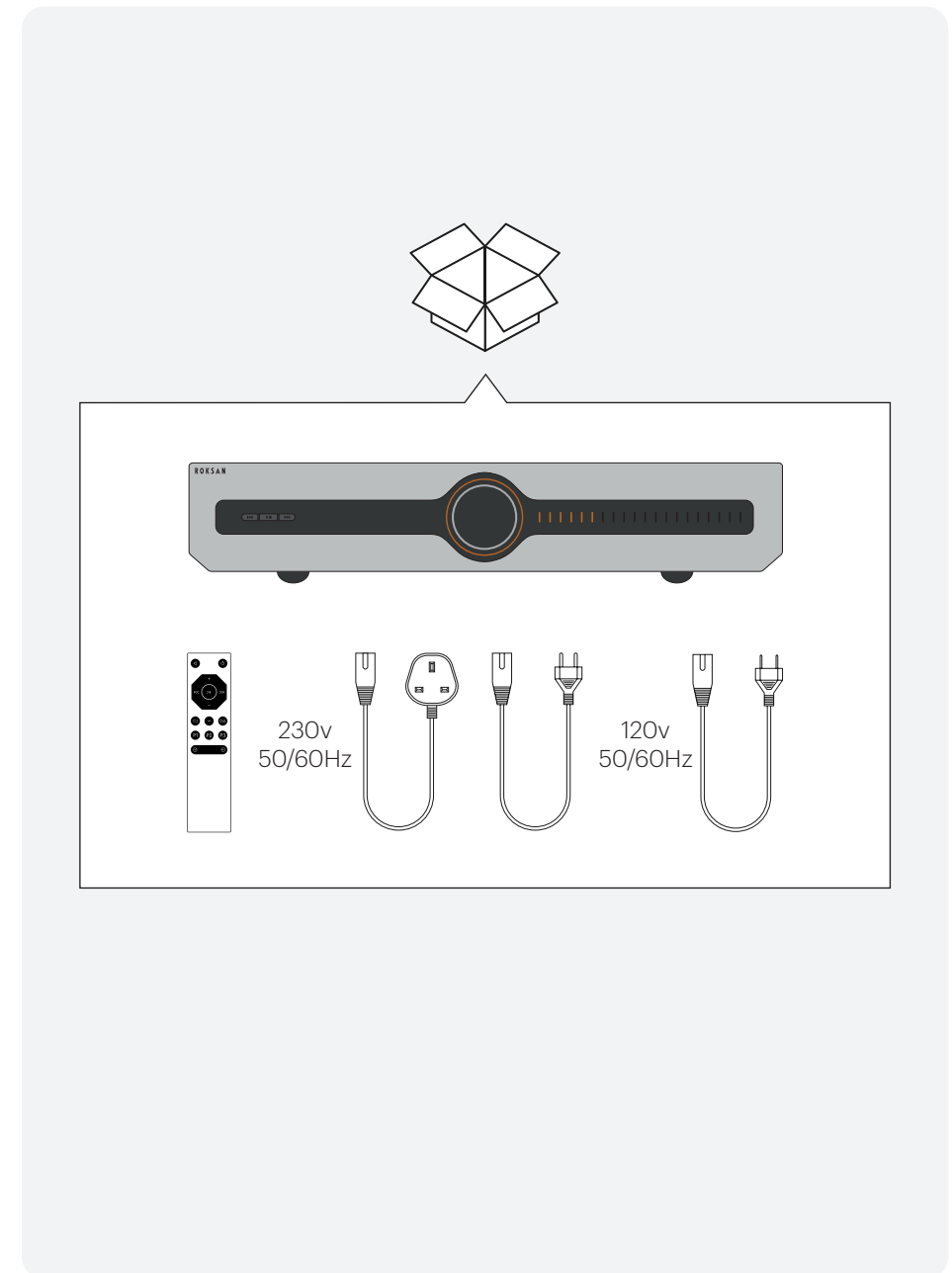

## Placement

---

Your Caspian 4G amplifier should be located in a well ventilated area and kept away from sources of heat, dust, humidity and direct sunlight.

The Caspian Amplifier may be positioned either as a free standing unit or alongside other audio/video product(s). Never place the amplifier under other electronic equipment, carpet or on any surface likely to hinder normal ventilation.

Never allow liquids or other objects to fall into the unit.

We recommend a minimum of 25mm air space all around the amplifiers.

If you have an Integrated or Streaming Amplifier/ Pre Amplifier and Power Amplifier(s) do not place them on top of each other. They should be sited on different shelves of the equipment rack, or side by side.

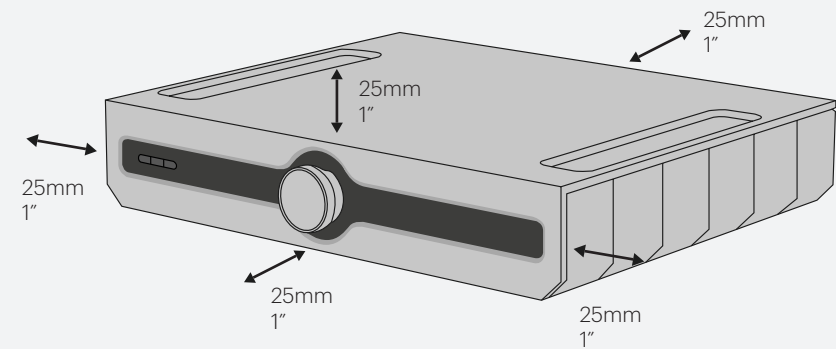

Caspian Streaming Amplifier FRONT

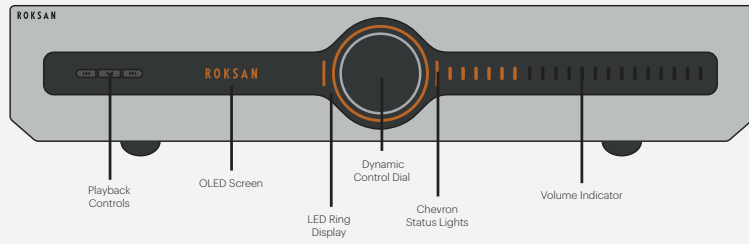

Caspian Integrated Amplifier FRONT

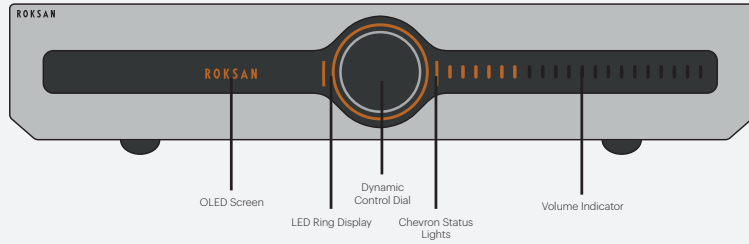

Caspian Streaming Pre-Amplifier FRONT

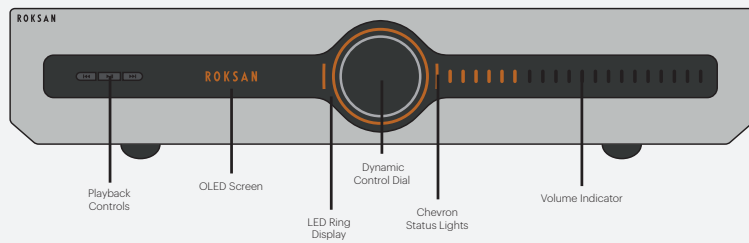

Caspian Streaming Amplifier REAR

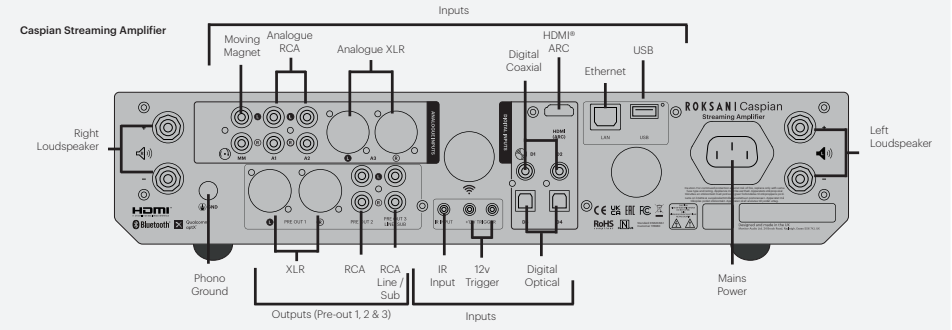

Caspian Integrated Amplifier REAR

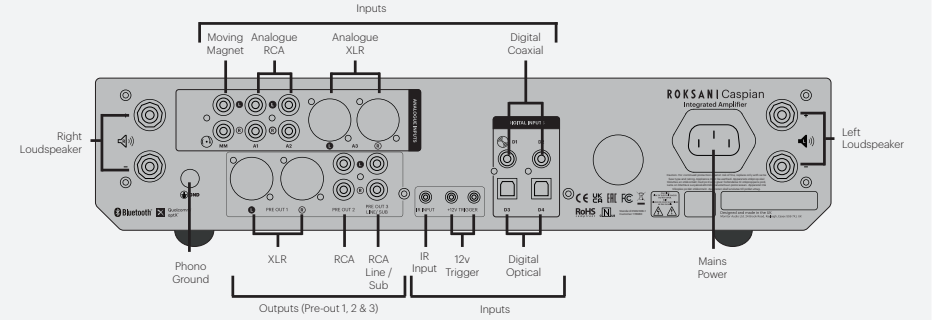

Caspian Streaming Pre-Amplifier REAR

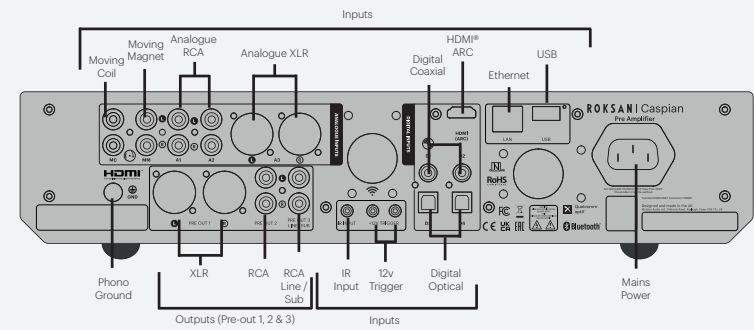

### Moving Coil Input (Caspian Streaming Pre-Amplifier Only)

This product has a built-in Moving Coil phono stage for use with turntables with a moving coil cartridge.

### Moving Magnet Input

This product has a built-in Moving Magnet phono stage for use with turntables with a moving magnet cartridge.

If you have a moving coil cartridge and the Caspian Integrated or Streaming Amplifier, you will need an external phono stage.

### RCA Analogue Inputs

The Caspian Streaming / Integrated Amplifier has 2 x RCA analogue inputs for connecting your sources. The A2 input also supports Music Sense, which can be configured using MaestroUnite to wake your amplifier when an audio signal is detected. If you would like to use your amplifier as a power amplifier in an AV system, connect your source pre-amplifier/AVR to the A2 input and enable AV Bypass in MaestroUnite.

### Balanced XLR Inputs

Balanced XLR inputs provide the highest quality analogue signal over long cable runs exceeding 10m. When connecting to the XLR inputs, ensure that the standard wiring configuration for a plug is followed:

Female connector

Male connector

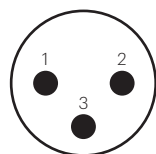
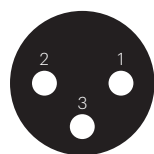

1 - Chassis ground

2 - Positive polarity (Hot)

3 - Negative polarity (Cold)

When only short runs are required, RCA inputs can be used. If using longer cable runs or greater noise rejection is required, then XLR connections would be better.

### HDMI ARC Input (not on the Integrated Amplifier)

Connect the HDMI cable from your TV's ARC output direct to the Caspian Streaming Pre-Amplifier to play the TV sound through your stereo speakers. Use HDMI cables that have Ultra High Speed HDMI Certification Label to be able to benefit from the higher bandwidth and high bit rate audio files.

CEC control over HDMI (control of the amplifier over HDMI from the TV remote) is possible and allows the TV to send commands to the amplifier and control the volume, mute and power. Due to the nature of CEC commands, not all TV's are compatible with CEC power commands.

NOTE: If a Dolby Digital, DTS or non-PCM signal is sent to the amplifier, it cannot be decoded and the output will mute. Set the audio output settings on the TV/ source to PCM.

NOTE: Only the audio signal from the source device is supported by HDMI ARC port.

### Ethernet / LAN (not on the Integrated Amplifier)

For optimum network connectivity, Roksan recommend using a wired network connection. A network connection is needed for streaming audio via BluOS (wired or Wi-Fi).

### USB Input (not on the Integrated Amplifier)

Connect a USB stick or external hard drive with music stored for playback via the BluOS app. We recommend using a NAS drive to store music rather than a USB drive for improved reliability and longevity.

### Phono Ground

This grounding terminal is to be used to ground the RCA phono connection from the cartridge/ tonearm where a separate ground is required on the interconnect.

### Wired IR Remote Control Input

If the product is in a different room or cabinet, IR commands can be sent to the unit via the rear panel jack socket labelled IR Input. Wired IR Input is compatible with many home automation installations including Logitech Harmony, early Crestron and Control 4 installations. The Wired IR jack socket is an input only and does not provide power, therefore, unsuitable for some remote IR-eye connections that are not self-powered.

### 12 V Trigger

These 3.5 mm jack connections can be used to remotely turn the amplifiers on and off by supplying a 12v signal to them. The two 12V trigger connectors enable chaining of multiple devices. Each connector can function as either an input or an output in the chain; however, the output will only work when an input is connected.

It is possible to select a preferred input when turning on the amplifier with the 12v Trigger. This is configured in MaestroUnite.

### Digital Audio Inputs

There are 4 digital inputs on the amplifier, 2 coaxial and 2 optical. Use these for connecting the output from your digital source. If using the Attessa CD Transport with the amplifier, connect this to D1. The 2 products can be configured to work and communicate with each other within MaestroUnite, refer to page 16 for further information.

Stereo digital audio sources can be connected using coaxial or optical cable. The PCM stereo format up to 24-bit / 192 kHz is supported by the coaxial digital inputs and optical up to 24-bit / 96 kHz. If using sources that have an option for selecting between PCM and Bitstream or Dolby Digital audio output, select PCM.

### Power

The moulded IEC plug of the supplied mains lead should be plugged into the socket on the rear of the unit first and then plugged into the mains supply. The appliance must have a safety earth connection.

The mains fuse is located here in the small drawer attached to the mains input socket. The fuse is a T1AL type for the Pre Amplifier and T6.3AL for the Integrated and Streaming Amplifiers.

## Output connections

### Balanced XLR Outputs - Pre-Out 1

These connections may be used for connecting a power amplifier or subwoofer. It is recommended to use balanced outputs over long cable runs over 10m. If the system is configured to be Stereo + Sub in MaestroUnite, then the output will be filtered according to the settings in MaestroUnite.

### RCA Analogue Outputs - Pre-Out 2 & 3

There are 2 pairs of RCA outputs on the amplifier. One pair (Pre-Out 2) is a mirror of the loudspeaker outputs (not on Pre-Amplifier) and Pre-Out 1. If the system is configured to be Stereo + Sub in MaestroUnite, then the output will be filtered according to the settings in MaestroUnite.

The other pair (Pre-Out 3) can be configured to be either full range, filtered to partner a subwoofer, line out (fixed for headphone amplifiers or other audio equipment with a volume control downstream) or even filtered as part of a preset speaker profile. All these settings can be configured within MaestroUnite.

### Wiring Your Loudspeakers

Connect the loudspeakers to the terminals on the amplifier. Banana plugs can be used, but the red and black plastic caps need to be removed first. Once removed, insert the banana plug directly in to the terminal. Alternatively bare wire can also be used by unscrewing the terminal and placing the cable through the through hole in the terminal and clamping it firmly in place.

Carefully observe polarity ensuring that the red (+) speaker terminal/ cable is connected to the red (+) amplifier terminal and the black (-) speaker terminal/ cable to the black (-) amplifier terminal.

When both left and right loudspeaker outputs are connected to their respective loudspeakers the amplifier is ready for use.

**IMPORTANT:** Please ensure the unit is disconnected from the mains power supply before connecting the loudspeaker cables.

**NOTE:** Litz-wound loudspeaker cables or those with a complex plaited construction can present a highly capacitive load to an amplifier and may cause damage to the amplifier and/ or degrade the sound of your system. Choose a cable of simple construction, manufactured from high-quality materials. Your Roksan retailer will be able to advise.

**NOTE:** If using bare wire, DO NOT use speaker cable with conductor size less than 16 AWG (1.6 mm diameter) or greater than 12 AWG (2.05 mm diameter).

**NOTE:** We strongly recommend that you use professionally terminated speaker cables using 4 mm plugs. Any attempt to connect cables which are not terminated may result in damage to the amplifier if not done correctly.

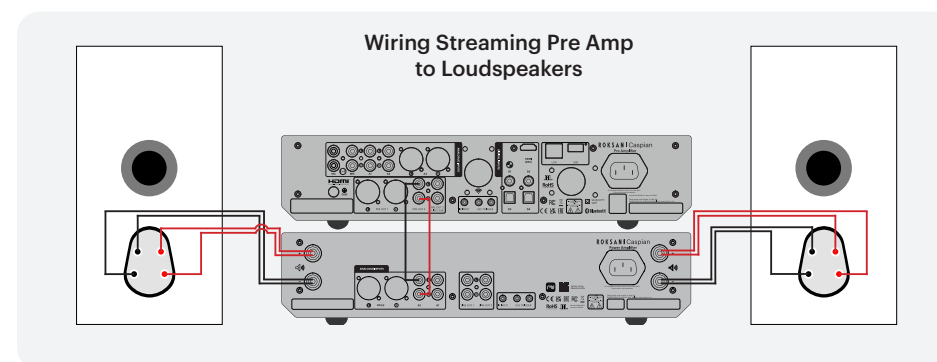
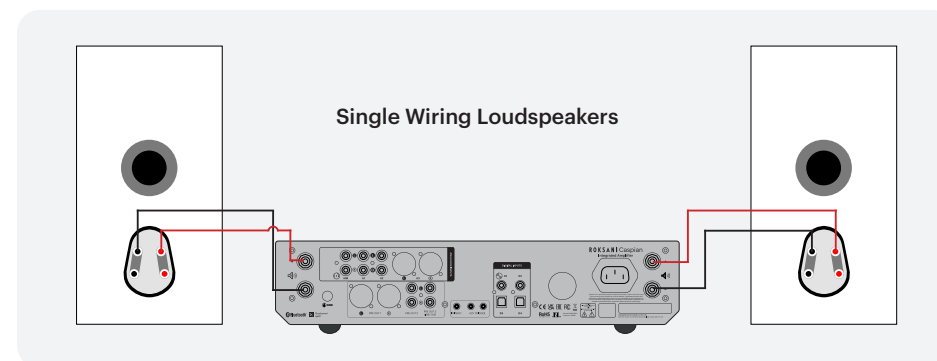

## Remote control

1	Mute	Toggles the mute on and off. The display will change to show there is no output.
2	Volume Up	Adjusts the output volume of the amplifier. The number of bars on the display will increase to show the volume is increasing, as well as a numerical value on the left display.
3	Previous Track/ Scan Backwards	Go to the start of the track or the previous track. Continued pressing will scroll back through the previous tracks. This works on both Bluetooth and when using BluOS on the Caspian Streaming Pre-Amplifier. It will also control the Attesa CD Transport when a Caspian Amplifier and Attesa CD Transport are in the same system on MaestroUnite.
4	Volume Down	Adjusts the output volume of the amplifier. The number of bars on the display will decrease to show the volume is decreasing.
5	Repeat/ Shuffle	Using Attesa CD Transport: Repeated presses cycles through the repeat/ shuffle options - Single track, full album/ playlist, shuffle. Using BluOS: Repeated presses cycles through the repeat options - Single track, full album/ playlist. Long press to toggle shuffle.
6	Presets 1, 2 & 3	These buttons correspond to the presets stored in BluOS. They do not have any function on the Integrated Amplifier.
7	Previous Input	Scrolls through the inputs enabled on the amplifier. Inputs can be hidden in MaestroUnite.
8	Standby	Toggles the power of the amplifier. The display will turn on and the amplifier will initialise starting in the last used input.
9	Play/ Pause	Starts or pauses playback of current track.
10	Next Track/ Scan Forward	Go to the start of the next track. Continued pressing will scroll forward through the next tracks. This works on both Bluetooth and when using BluOS on the Caspian Streaming Pre-Amplifier. It will also control the Attesa CD Transport when a Caspian Amplifier and Attesa CD Transport are in the same system on MaestroUnite.
11	Settings menu	Brings up the amplifier's settings menu. This is a limited menu with more configuration and customisation available in MaestroUnite.
12	Stop/ Eject	Press to stop playback on the stream or track on CD Transport. A Second press will eject the disk when partnered with an Attesa CD Transport.
13	Next Input	Scrolls through the inputs enabled on the amplifier. Inputs can be turned on and off in MaestroUnite.
14	Battery Drawer	Accepts 2 x 1.5 V AAA Batteries

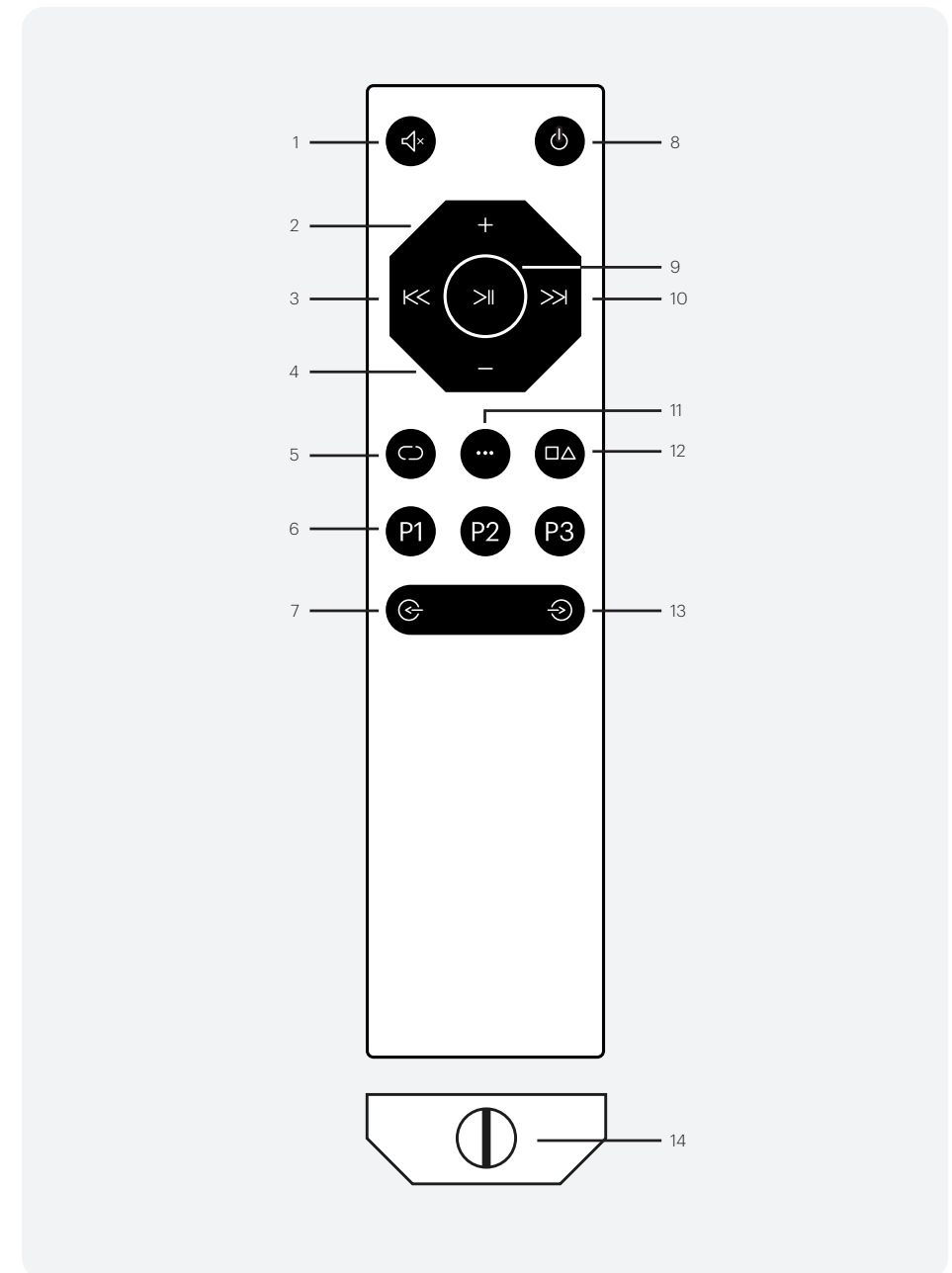

## Waking from standby

---

When first connecting the mains power to your amplifier, it will go through the self-check process, then enter standby mode (see illustration below).

To wake the amplifier from standby, there are a number of options.

- Pressing the standby button on the remote control
- Pressing the dynamic control dial
- Receiving a signal from the 12v Trigger
- Using the MaestroUnite app
- Using the BluOS Controller app  
(Caspian Streaming Pre-Amplifier and Integrated Amplifier only, when Standby Plus is setup and configured)

Additionally, if you have a source connected to A2 and Music Sense enabled, simply playing that source will wake the amplifier from standby.

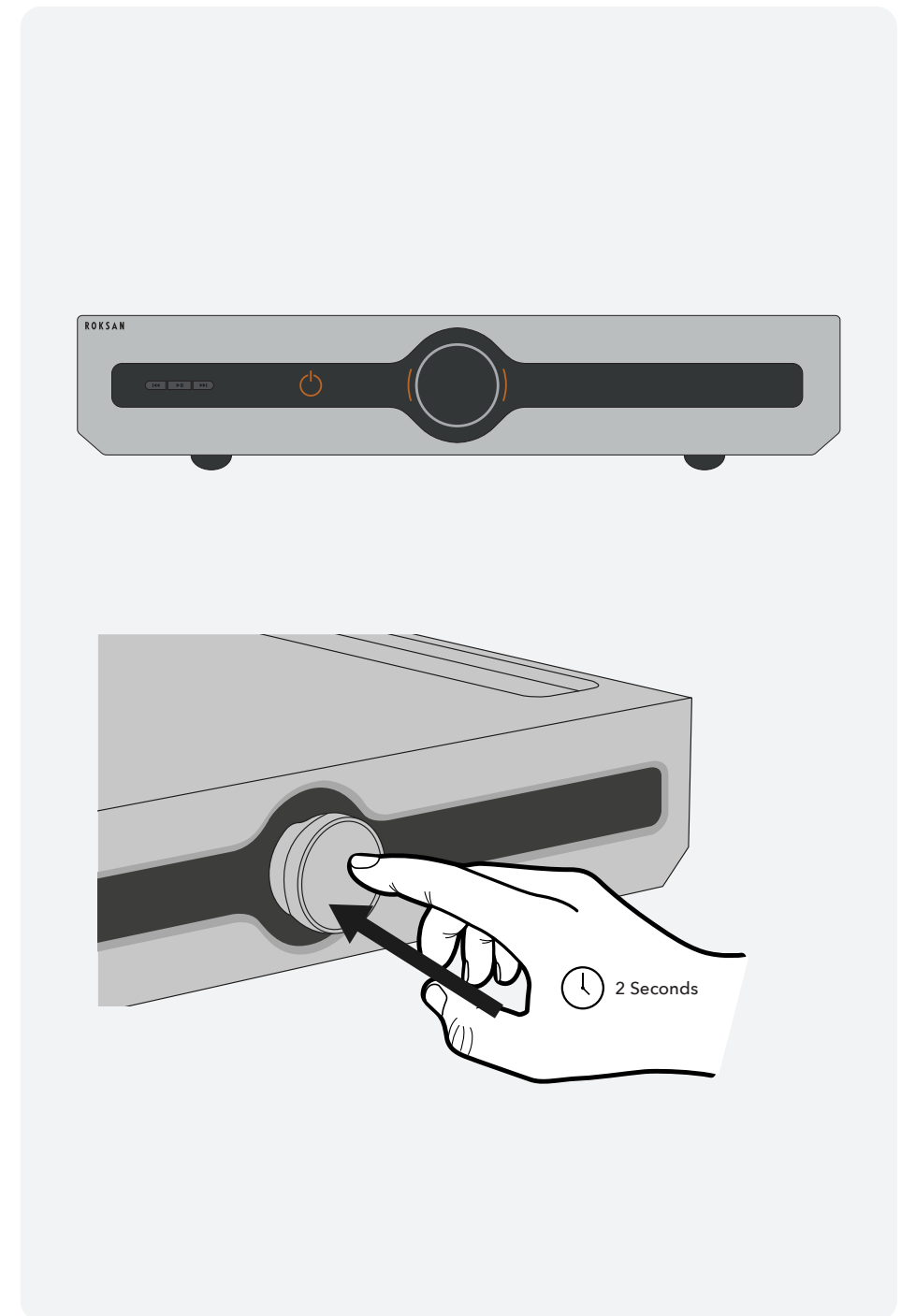



## Setting up MaestroUnite

The MaestroUnite app will allow you to enjoy your Caspian system to its fullest potential. The app allows for Wi-Fi setup, input/output configuration, audio adjustments, firmware updates and system creation with additional Roksan or Monitor Audio products.

### Download MaestroUnite app

Visit [roksan.com/maestrounite](https://roksan.com/maestrounite)



Once installed, follow these steps to connect to your amplifier, configure the Wi-Fi and create your "System". A system can be an amplifier by itself or a combination of Caspian Amplifiers or the addition of an Attesa CD Transport.

When in a system together the products will talk to each other, with the amplifier being the master controller sending commands to the other products within the system.



**NOTE** - When creating a system with a Pre/ Integrated/ Streaming Amplifier and a Power amplifier, always set the Pre/ Integrated/ Streaming Amplifier up before the Power Amplifier.

If the Power Amplifier is set up first, you will not be able to add the Pre Amplifier. The Pre Amplifier needs to be the primary product in the system.

To add the power amplifier from an existing system to a new system, either delete the previous system or remove the Power Amplifier from it if the system contains multiple devices.

Tap on the + symbol in the top right corner

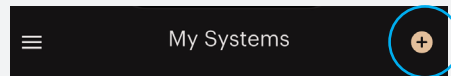

Select the product you want to connect to from the list of available products in range.

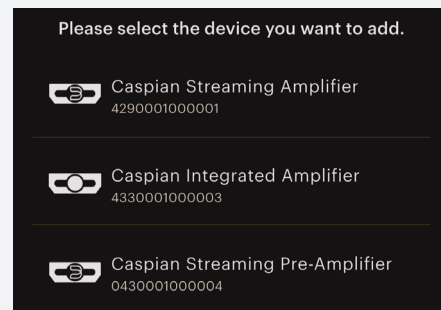

Insert the name of your system. e.g. Living Room, and tap next.

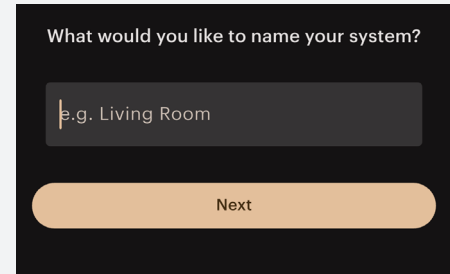

Enter the Bluetooth pairing code shown on the front of the amplifier. If the wrong code is entered or the request times out, this will be displayed on the amplifier and on MaestroUnite.

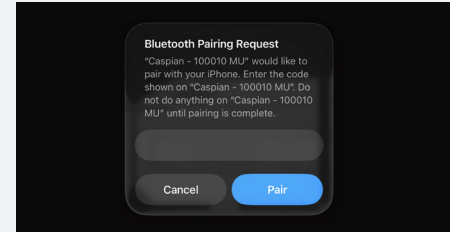

Select the Wi-Fi network from the list of available networks and enter the password.

NOTE: Only 2.4GHz networks are supported by MaestroUnite and the Caspian Amplifier.

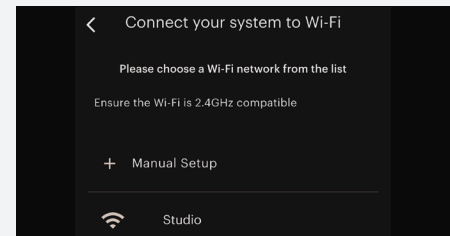

Follow the on-screen instructions to carry out an Auto Firmware Update.

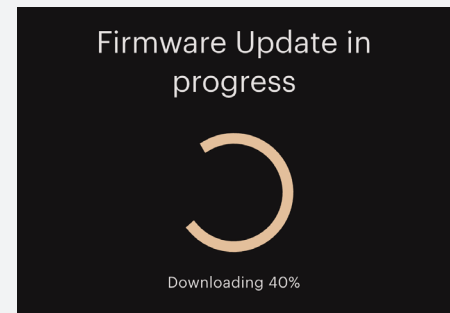

Once the firmware update has completed, tap on the "Home" screen or continue to setup BluOS if you have a Pre/ Streaming Amplifier.

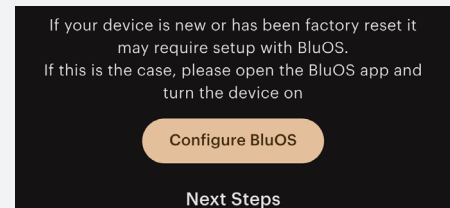

## Adding additional equipment to your system

---

### Adding a Caspian 4G Power Amplifier

You can create a system using a Caspian Streaming Pre-Amplifier and a Caspian Power Amplifier in the MaestroUnite app.

**NOTE: You'll need to set up your Caspian Streaming Pre-Amplifier in the MaestroUnite first before adding the Caspian Power Amplifier.**

Connect the Caspian Power Amplifier to either the Pre-Out 1 or Pre-Out 2 output on your Caspian Streaming Pre-Amplifier.

In the MaestroUnite app, select Outputs, then the configuration mode you'd like to use:

Stereo – Use this mode for Caspian Streaming Pre-Amplifier.

Bi-Amp Stereo – Use this mode if you are using more than one Caspian Power Amplifier.

### Adding a subwoofer

If adding a subwoofer to your stereo system to create a 2.1 system connect the subwoofer to Pre-Out 3 of the Caspian Amplifier and follow the MaestroUnite configuration instructions below:

1. In MaestroUnite, under "Outputs", select "Mode" and change it to Stereo + Sub (2.1).
2. If using Monitor Audio loudspeakers, touch on the "Speaker" option and select your loudspeakers from the drop-down list. If your speakers aren't in the list, select "Generic" and then enter the nominal impedance and power rating of the speakers.
3. If you want the bass to be handled by just the subwoofer, turn on "Crossover High Pass". This will remove the bass from the main left and right speakers, giving more control to the way the speaker and subwoofer crossover and therefore improving the sound.
4. We would recommend experimenting with this option as not all rooms and personal tastes will be the same.
5. Turn on the "Crossover Low Pass" to enable the customisation of the Subwoofer output.
6. Select the Crossover type, slope and frequency for your room and tastes. A good starting point is 80 Hz with both the High Pass and Low Pass filters turned on.
7. This will again require some experimentation to getting it sounding right to your ears.

### Adding an Attessa CD Transport

If you wish to listen to CD's then the Attessa CD Transport can be used with the Caspian Streaming Pre-Amplifier. When it is added into the same system as the amplifier it will be able to decode MQA CD's, synchronise the power with the amplifier - CD Transport will turn on when the CD input is selected and turn off when the amplifier is turned off.

### Selecting Inputs

All inputs can be selected using either the rotary encoder on the front of the amplifier, the remote or BluOS (Except for the Integrated Amplifier). Unused inputs can be hidden in MaestroUnite.

### Bluetooth

To stream to the amplifier via Bluetooth, you will need to put it into Bluetooth mode before it will be visible to your Bluetooth source. Once visible it will show up as Caspian - <serial number> A2DP, e.g. Caspian-100101 A2DP under the available Bluetooth devices.

### Selecting Volume

Volume adjustment is achieved by either rotating the dynamic control dial (clockwise to increase the volume and anticlockwise to decrease the volume) or by pressing the buttons on the remote. The Volume LED's will be illuminated on the right-hand side of the dynamic control dial showing the current volume.

The volume can be muted by turning the dial anticlockwise continuously until the Mute icon is displayed, a brief press of the dial or by pressing the Mute button on the remote control.

 **NOTE: If the unit is turned off with the volume above 60%, it will restart at a lower level to protect the speakers and the Caspian Amplifier. This can be configured and turned off in MaestroUnite.**

### Change Source

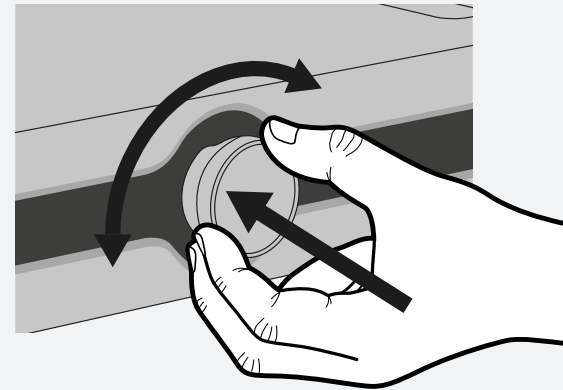

### Volume

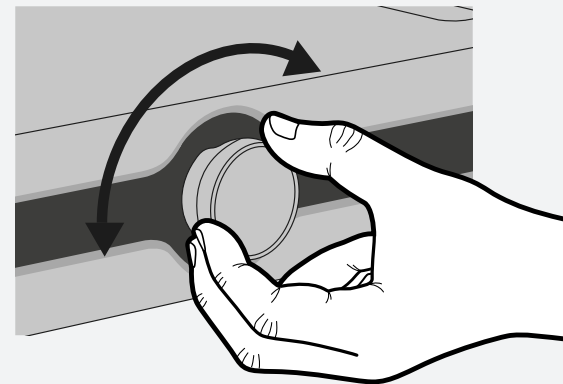



To take full advantage of the Caspian Streaming Pre-Amplifier and Caspian Streaming Amplifier's capabilities and features, you can use it as a music streamer with the BluOS app. The app can be downloaded from the App Store or Google Play.

Once downloaded follow the on-screen instructions to install and set up the app for use with your Amplifier.

When Standby Plus is enabled, the Caspian Amplifier will be visible within the BluOS app and can be woken from standby using it and begin playback.

BluOS has several streaming services by default as well as Apple AirPlay 2, Spotify Connect, Tidal Connect and others.

You can also stream sources connected to the Caspian Amplifier to other BluOS enabled devices on the network. For example, you can stream the music from your CD Player connected to the Caspian Amplifier to an Atessa Streaming Amplifier in a different room.

The chevrons around the dynamic control dial indicate the BluOS status when the BluOs input is selected. These colour indicators are:

**Solid Green:** The Player is in Hotspot Mode and is ready to be connected to the network. To setup your player from Hotspot Mode, check out the wired or wireless setup options in the following support article.

**Flashing Green:** The Player is attempting to connect to the network, or the network cable is disconnected.

**Solid Purple:** The Player is not set up, but Hotspot Mode has timed out after 15 minutes of idle.

**Solid Blue:** The Player is in Ready Mode connected to the network and ready to stream music. These will fade out after a certain period and re-appear when the amplifier receives a command.

**Flicker Blue:** Receiving IR Codes from a remote

**Solid White:** The Player is indexing the local music library on your network

**Alternating White and Blue:** Player is replicating or receiving an updated Index from other players

**Solid Red:** The Player is in Upgrade Mode waiting to perform an upgrade. If your player has entered Upgrade Mode unexpectedly, please check out the following support article for additional help

**Alternating Red/Green:** The Player's BluOS firmware upgrade is in progress.



## On-screen menu

The on-screen menu of the Caspian Amplifiers opens quick access to several features. To access them, press the Settings Menu button on the remote (item 11 on page 12). All settings can be toggled by pressing the Play/ Pause button on the remote. The features are:

- Auto On
- Auto Standby
- Standby Plus
- Balance
- Sensitivity MC (Pre-Amplifier only), MM, A1, A2 & A3
- Power Amplifier Toggle (Not on Pre-Amplifier)
- AV Bypass
- Unpair BLE Connections
- Reset Audio Settings
- Factory Reset
- Serial Number
- Firmware & Hardware versions
- Firmware Update
- BluOS Version & Status (Streaming Amplifier only)
- BluOS USB Upgrade (Streaming Amplifier only)
- Caspian MAC Addresses
- BluOS Wi-Fi MAC and IP Address (Streaming Amplifier only)
- BluOS Ethernet MAC address (Streaming Amplifier only)

### Auto On

Enables the selection of how the amplifier automatically turns on. You can choose from Music Sense, 12 V Trigger or Off. When set to Music Sense, it will turn on automatically when a signal is received on A2 only. If 12 V Trigger is selected, the amplifier will turn on when receiving the trigger command from another attached device. If linking on to another amplifier, then the 12 V trigger output will also be active.

Auto On via HDMI is available via MaestroUnite (where the TV /AV equipment supports it).

NOTE: The 12 V Trigger link will only be active when a source device is connected to the 12 V Trigger input. The amplifier will not produce a 12 V Trigger signal.

### Auto Standby

When enabled, if the amplifier isn't used for 20 minutes it will automatically go into standby. You can also turn this feature off, so that the amplifier will never go into standby automatically.

NOTE: If using the 12 V trigger to control turning the amplifier on and off, Auto Standby will be disabled, and power control will be handled by the 12 V trigger signal.

### Standby Plus

Integrated Amplifier - This enables the amplifier to be woken from standby a little quicker than normal.

Streaming Amplifier - When Standby Plus is turned on, the amplifier will be visible on BluOS and will automatically turn on when playing something via BluOS, or a preset selected.

When Standby Plus is enabled, power consumption when in standby will increase from less than 0.5 W to approximately 2 W.

### Balance

Here, the balance across the left and right channels can be altered in 1dB increments up to 3 dB on either channel.

### Sensitivity

If the input level on the analogue devices is different to other inputs, the sensitivity can be adjusted accordingly to counteract this difference. There are Low, Mid (default) and High options.

### Power Amplifier Toggle (Not on Pre-Amplifier)

If the Caspian Streaming / Integrated Amplifier is being used as a pre-amplifier connected to a separate power amplifier then, it is recommended to turn the internal power amplifier stage off. This mutes the input to the power amplifiers.

### AV Bypass

If you have your amplifier connected to an AV Receiver to power the front left and right speakers, enable AV Bypass and connect your AVR outputs to the A2 Input on the Caspian. Whenever A2 is selected, it will be in AV Bypass mode, and this will be displayed on the screen.



If you turn AV bypass on with speakers connected, they will play at full volume. And the volume can't be changed or muted!

### Unpair BLE Connections

By removing the Bluetooth Low Energy pairings, the Amplifier forgets the list of paired bluetooth devices it knows about, including other devices in the system. You still need to delete the system / device in MaestroUnite if you wish to start all over again.

### Reset Audio Settings

This will reset any changes made to the balance, sensitivity, tone controls, speaker presets or crossover settings (changed in MaestroUnite). It will not reset the Wi-Fi or BluOS settings. Press the Play/ Pause button on the remote to reset the audio settings.

If there are any Audio settings configured, a single dot will be displayed on the amplifier's display screen next to the input.

### Factory Reset

This resets everything back to factory defaults including Wi-Fi and BluOS settings. Press the Play/ Pause button on the remote and then Repeat button to confirm and reset all settings. There will be a progress update on the display of the amplifier and the dynamic control dial will give haptic feedback when complete. The amplifier will then go into standby when complete.

### Serial Number

Displays the serial number of the amplifier.

### Firmware & Hardware versions

Displays the current firmware version and the version of the hardware fitted.

### Firmware Update

By pressing the Play/ Pause button on the remote will start a firmware update of the Roksan firmware (BluOS firmware is updated separately). Wi-Fi will need to be configured before carrying out a FW update. During the update, the "Ring Indicator" will show the progress of the update along with the percentage of completion on the main display. When completed, the display will confirm that the amplifier has successfully been updated and go into standby.

### BluOS Version & Status

Shows the current BluOS firmware version and its connectivity status.

### BluOS USB Upgrade

The BluOS firmware can be updated by USB. First the firmware file will need to be downloaded from the BluOS website and loaded onto the USB. Once the USB stick is inserted into the amplifier, press the repeat button on the remote to instigate the update.

### MAC Addresses

The screens show the various MAC addresses for the Wi-Fi, Ethernet and Bluetooth modules within the amplifier.

## Changing remote battery

---

To access the battery compartment and change the battery, use a coin to rotate the locking mechanism at the bottom of the remote (circled below) clockwise to release it.

Once released, the batteries are accessible. The remote accepts 2 x AAA 1.5 V batteries.

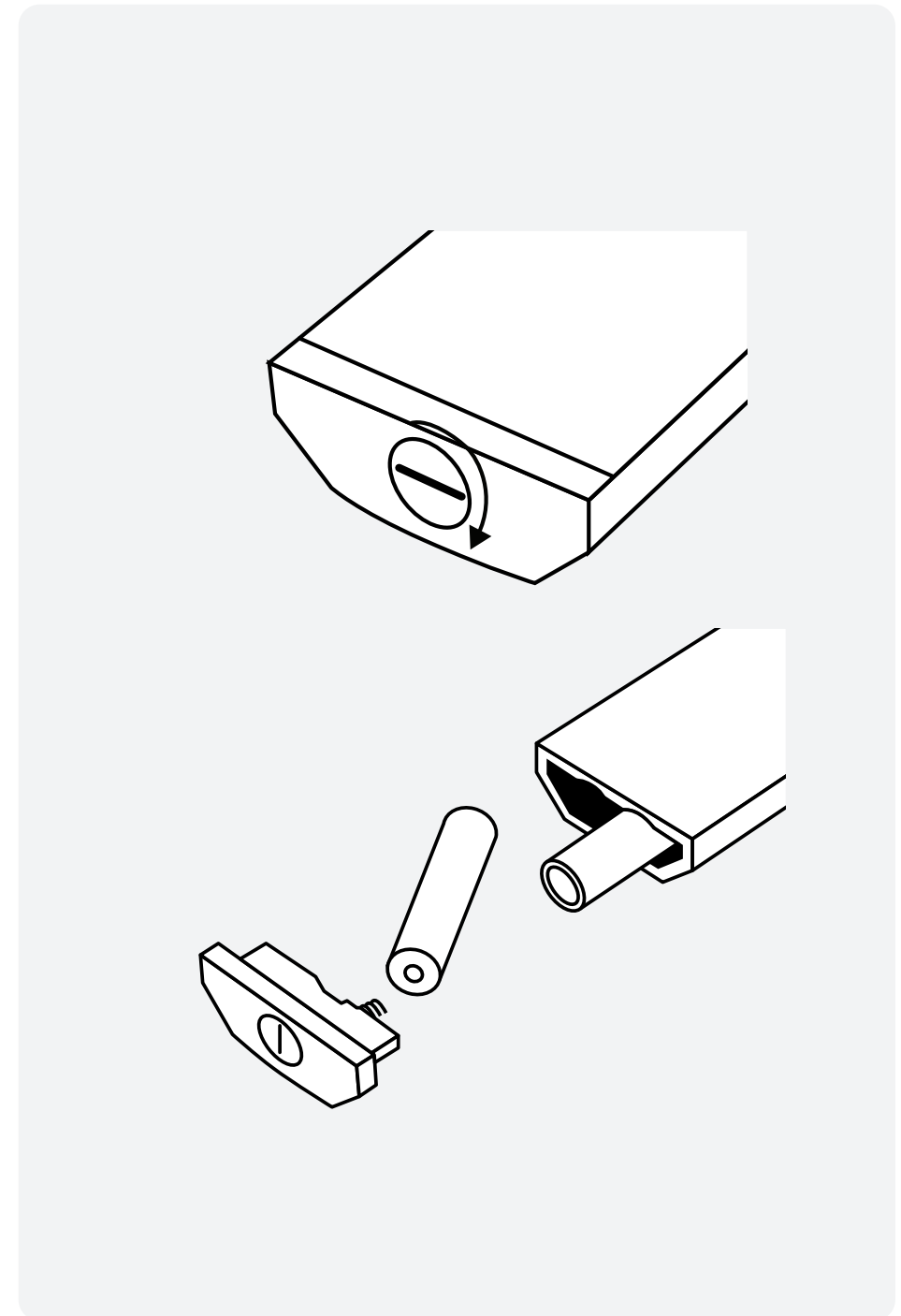

## Care & maintenance

---

### **Cleaning your product**

After disconnecting the product from the mains supply, the casing and front panel may be cleaned with a lint-free cloth. Avoid using abrasive substances or solvents.

### **Preserving the OLED display**

To preserve the life of the OLED display, there is an automatic display saver mode. If there are no commands received for 2 minutes the display will turn off until a command is received.

### **Keeping your Caspian Amplifier up-to-date**

For the best continued performance and latest features, please ensure that your Caspian Amplifier is up-to-date with the latest firmware.

To receive “over the air” (OTA) updates, your product needs to be connected to the Wi-Fi using the MaestroUnite app. For details please see page 16.

You can access BluOS functionality via the Ethernet port, however this cannot be used for Roksan OTA updates. You will need to use the MaestroUnite app to connect your amplifier to your Wi-Fi network to receive Roksan updates, this also enables BluOS functionality via Wi-Fi.

## Warranty

---

In the unlikely event that there is a defect with this product, it is covered by the Roksan manufacturer's warranty, provided that the product was supplied by an authorised Roksan retail specialist.

For the period of cover please refer to the product page on our website at [roksan.com/warranty](https://roksan.com/warranty).

**Register your Roksan product**  
to ensure the best possible product and customer support

Register your product using the QR code  
or visit [roksan.com/registration](https://roksan.com/registration)



# Specifications

Connectivity Summary	Integrated	Streaming	Streaming Pre
Analogue Inputs	2x RCA Stereo (A1, A2), 1x Balanced XLR (A3), 1x MM Phono (MM)	2x RCA Stereo (A1, A2), 1x Balanced XLR (A3), 1x MM Phono (MM)	2x RCA Stereo (A2, A3) 1x Balanced XLR (A1), 1x MM Phono (MM), 1x MC Phono (MC)
Digital Inputs	2x Coax (D1, D2) 2x Optical (D3, D4) Bluetooth Audio	2 x Coax (D1, D2) 2 x Optical (D3, D4) Bluetooth Audio BluOS HDMI eARC	2x Coax (D1, D2) 2x Optical (D3, D4) Bluetooth Audio BluOS HDMI eARC
Analogue Outputs	1x Balanced XLR (Pre1), 1x RCA Stereo (Pre2), 1x RCA Stereo (Pre3)	1 x Balanced XLR (Pre1) 1 x RCA Stereo (Pre2) 1 x RCA Stereo (Pre3)	1x Balanced XLR (Pre1), 1x RCA Stereo (Pre2), 1x RCA Stereo (Pre3)
Amplifier Output	1x Pair of Speaker binding posts (L&R)	1 x Pair of Speaker binding posts (L&R)	N/A
Other Inputs / Outputs	Wi-Fi 4, BLE, 12V Trigger, Wired IR	Gigabit Ethernet RJ45, Wi-Fi 5, Wi-Fi 4, BLE, 12 V Trigger, Wired IR	Gigabit Ethernet RJ45, W-Fi 5, Wi-Fi 4, BLE, 12V Trigger, Wired IR
Power	IEC C14, Fused 6.3AT - 250V	IEC C14, Fused 6.2AT	IEC C14, TBC Fused 1AT - 250V
User Interface			
Primary Interface (on unit)	Dynamic Control Dial (with haptic feedback) to control volume, inputs & power	Dynamic Control Dial (with haptic feedback) to control volume, inputs & power	Dynamic Control Dial (with haptic feedback) to control volume, inputs & power
Secondary Interface (on unit)	-	Backward, Play/Pause, Forward	Backward, Play/Pause, Forward
Remote Control	Black, 15 button IR remote. Bead blasted & anodised aluminium extruded case with laser etched logo.	Black, 15 button IR remote. Bead blasted & anodised aluminium extruded case with laser etched logo.	Black, 15 button IR remote. Bead blasted & anodised aluminium extruded case with laser etched logo.
Phono Section			
Inputs	MM	MM	MM & MC
Gain MM	53dB	53 dB	53dB
Gain Adjustment MM	Low (-3dB), Mid (0dB default), High (+3dB)	Low (-6 dB), Mid (0 dB default), High (+6 dB)	Low (-3dB), Mid (0dB default), High (+3dB)
Input Impedance MM	47k Ohms/100pF	47 k Ohms/ 100 pF	47k ohms/100pF
Gain MC	N/A	N/A	77dB
Gain Adjustment MC	N/A	N/A	Low (-3dB), Mid (0dB default), High (+3dB)
Input Impedance MC	N/A	N/A	100 ohms/470pF
RIAA response accuracy MM/MC	N/A	N/A	N/A
Rapture DAC			
DAC Technology	Rapture DAC, Dual Mono Balanced	Rapture DAC, Dual Mono Balanced	Rapture DAC, Dual Mono Balanced
Format Support	PCM	PCM	PCM
Sampling Rate	up to 24 bit / 192 kHz	up to 24 bit / 192 kHz	up to 24 bit / 192 kHz
Pre-Amplifier Section (Amp, Pre1, Pre2)			
Volume Control Technology	Hybrid Digital Analogue	Hybrid Digital Analogue	Hybrid Digital Analogue
Volume Control Matching	<0.25 dB	<0.25 dB	<0.25 dB
THD+N (3.9 VRMS, A-Weighted)	<0.0008%	<0.0008%	<0.0008%
Signal to Noise Ratio (3.9 VRMS, A-Weighted)	>108 dB	>108 dB	>108 dB
Maximum Output Level	3.9 VRMS	3.9 VRMS	3.9 VRMS
Supported Features	Pre-Output, Intelligent DSP	Pre-Output, Intelligent DSP	Pre-Output, Intelligent DSP

Pre-Amplifier Section (Pre3)	Integrated	Streaming	Streaming Pre
Volume Control Technology	Digital	Digital	Digital
Volume Control Matching	<0.25dB	<0.25 dB	<0.25dB
THD+N (3.9 VRMS, A-Weighted)	<0.003%	<0.003 %	<0.003%
Signal to Noise Ratio (3.9 VRMS, A-Weighted)	>108dB	>108 dB	>108dB
Maximum Output Level	3.9Vrms	3.9 VRMS	3.9Vrms
Supported Features	Pre-Output Line Level Output (Fixed Level) Sub-Woofers Output (Low-Pass Filtered) Intelligent DSP	Pre-Output Line Level Output (Fixed Level) Sub-Woofers Output (Low-Pass Filtered) Intelligent DSP	Pre-Output Line Level Output (Fixed Level) Sub-Woofers Output (Low-Pass Filtered) Intelligent DSP

Bluetooth			
Protocol	A2DP Audio Profile	A2DP Audio Profile	A2DP Audio Profile
Codecs	SBC, aptX & AAC	SBC, aptX & AAC	SBC, aptX & AAC
Range	>15 m	>15 m	>15 m

Digital Inputs			
Coax Inputs (D1, D2)	up to 24 bit / 192 kHz (Stereo)	up to 24 bit / 192 kHz (Stereo)	up to 24 bit / 192 kHz (Stereo)
Optical Inputs (D3, D4)	up to 24 bit / 96 kHz (Stereo)	up to 24 bit / 96 kHz (Stereo)	up to 24 bit / 96 kHz (Stereo)
HDMI ARC & eARC	No	Yes (2.0)	Yes (2.0)

Analogue Inputs			
Maximum Input Level	6.7Vrms	6.7 VRMS	6.7Vrms
Music Sense	A2 Input	A2 Input	A2 Input
AV Mode	A2 Input	A2 Input	A2 Input

BluOS Section			
BluOS Streaming Supported	No	Yes	Yes
Audio Formats	-	MP3, AAC, WMA, OGG, WMA-L ALAC, OPUS	MP3, AAC, WMA, OGG, WMA-L ALAC, OPUS
Hi-Resolution Audio Formats	-	MQA, FLAC, WAV AIFF, Supports converted DSD playback via the desktop app only.	MQA, FLAC, WAV AIFF, Supports converted DSD playback via the desktop app only.
Sampling Rate	-	up to 192 kHz	up to 192kHz
Bit Depth	-	16 - 24	16 - 24
Network Connectivity	-	*Gigabit Ethernet RJ45, Wi-Fi 5*	*Gigabit Ethernet RJ45, Wi-Fi 5*
Supported Network File Storage Protocol	-	Server Message Block (SMB)	Server Message Block (SMB)
USB	-	1 x Type-A port for connection to USB memory stick (FAT32 or NTFS formatted) and supported peripherals	1x Type-A port for connection to USB memory stick (FAT32 or NTFS formatted) and supported peripherals
Supported Operating System	-	Music playback from network shares on the following desktop operating systems: Microsoft Windows XP, 2000, Vista, 7, 8 to current Windows Operating Systems and macOS versions**	Music playback from network shares on the following desktop operating systems: Microsoft Windows XP, 2000, Vista, 7, 8 to current Windows Operating Systems and macOS versions**
Mobile Application	-	Free BluOS Controller App available for download from the respective App stores of Apple iOS devices (iPad, iPhone and iPod), Android devices, Kindle Fire and Windows or macOS desktops	Free BluOS Controller App available for download from the respective App stores of Apple iOS devices (iPad, iPhone and iPod), Android devices, Kindle Fire and Windows or macOS desktops
Supported music services and partners	-	Over 20 natively integrated streaming services. For more information go to <a href="https://bluos.io/">https://bluos.io/</a>	Over 20 natively integrated streaming services. For more information go to <a href="https://bluos.io/">https://bluos.io/</a>
Third Party Certified Services	-	Apple Airplay, Spotify Connect, Tidal Connect	Apple Airplay, Spotify Connect, Tidal Connect
ROON Ready	-	Yes	Pending ROON Ready, ROON tested TBC
Control Integrations	-	Creston, Control4 (OS3), Control4 (OS2), RTI, URC, BluOS URC Driver, URC, Lutron, NICE, GIRA, BluOS Integration Utility, BluOS Custom Integration API	Creston, Control4 (OS3), Control4 (OS2), RTI, URC, BluOS URC Driver, URC, Lutron, NICE, GIRA, BluOS Integration Utility, BluOS Custom Integration API

MaestroUnite	Integrated	Streaming	Streaming Pre
MaestroUnite Supported	Yes	Yes	Yes
Network Connectivity	Bluetooth LE Wi-Fi 4 (Only connects for Over-the-Air Updates)	Bluetooth LE Wi-Fi 4 (Only connects for Over-the-Air Updates, BluOS Network does not support updates to Caspian firmware)	Bluetooth LE Wi-Fi 4 (Only connects for Over-the-Air Updates, BluOS Network does not support updates to Caspian firmware)
Mobile Application	iOS, Android	iOS, Android	iOS, Android
Over-the-Air Updates	Firmware Updates are available via the MaestroUnite configured Wi-Fi connection. This can be setup to connect & update on user request or during periods of inactivity.	Firmware Updates are available via the MaestroUnite configured Wi-Fi connection. This can be setup to connect & update on user request or during periods of inactivity.	Firmware Updates are available via the MaestroUnite configured Wi-Fi connection. This can be setup to connect & update on user request or during periods of inactivity.
Other			
Wi-Fi Protocol	Only supports 2.4GHz networks	Only supports 2.4GHz networks	
Wired IR Input	5 - 14V, Mono 3.5mm jack plug, any polarity	5 - 14 V, Mono 3.5 mm jack plug, any polarity	5-14V, Mono 3.5mm jack plug, any polarity
12 V Trigger Input	5 - 14V, 3.5mm jack dual polarity (On / Standby)	5 - 14 V, 3.5 mm jack dual polarity (On / Standby)	5 - 14V, 3.5mm jack dual polarity (On / Standby)
12 V Trigger Pass-through	3.5mm jack Pass through from input only	3.5mm jack Pass through from input only	3.5mm jack Pass through from input only
Nominal Mains Voltage	*Auto-Selecting Power Supply 100-120VAC & 220-240 VAC*	Auto-Selecting Power Supply 100 - 120 VAC & 220 - 240 VAC	*Auto-Selecting Power Supply 100-120VAC & 220-240 VAC*
Power Consumption	610VA Standby 0.5W Network Standby 2W (Standby Plus, allows fast boot)	Max 610 VA Standby 0.5 W Network Standby 2 W (Standby Plus, allows fast boot)	85VA Standby 0.5W Network Standby 2W (Standby Plus, allows wakeup from BluOS and fast boot)
Mechanical			
Available Finishes	Silver Black	Silver Black	Silver Black
Construction	Extruded and machined Aluminium front & top cover with extruded Aluminium heat sinks.	Extruded and machined Aluminium front & top cover with extruded Aluminium heat sinks.	Extruded and machined Aluminium front & top cover with extruded Aluminium heatsinks.
External Dimensions with all Accessories Fitted (H x W x D)	93 x 432 x 378mm (3 11/16 x 17 x 14 7/8") See downloads for CAD drawings	93 x 432 x 378 mm (3 7/8" x 17 x 14 7/8") See downloads for CAD drawings	93 x 432 x 378mm (3 11/16 x 17 x 14 7/8") See downloads for CAD drawings
Weight (Product, Each)	15.2 kg (33 lb 8 oz)	15.5 kg (34 lb 3 oz)	101 kg (22 lb 4 oz)
Sold As	Single	Single	Single

## Directives

**CE** Monitor Audio Group declares that the apparatus "Caspian Streaming Pre-Amplifier", "Caspian Streaming Amplifier" and "Caspian Integrated Amplifier". in conformity with the essential requirements and other relevant provisions of Directive 2014/53/EU".



**NOTE:** This product must be earthed. Please ensure that other equipment connected to it is earthed according to the manufacturer's instructions.

Monitor Audio Group declare in own responsibility, that the Roksan products described in this manual is in compliance with the following Standards and is in conformity with the essential requirements of the Radio Equipment Regulations 2017.

Listen Again.

Roksan  
24 Brook Road  
Rayleigh, Essex  
SS6 7XJ  
England  
Tel: +44 (0)1268 740580  
Email: [info@monitoraudio.group](mailto:info@monitoraudio.group)

**[roksan.com](http://roksan.com)**

©Monitor Audio Ltd. | VI-2025 - Caspian Series 4G