

Contents

- 3 First time installation
- 13 How to switch between satellite and TV
- 15 Changing Source
- 17 How to download apps from the WebOS store
- 20 How to access FreeviewPlay catchup
- 22 How to set up and manage Favourites
- 28 How to move channels in your favourite list

WebOS TV First Time Installation Instructions

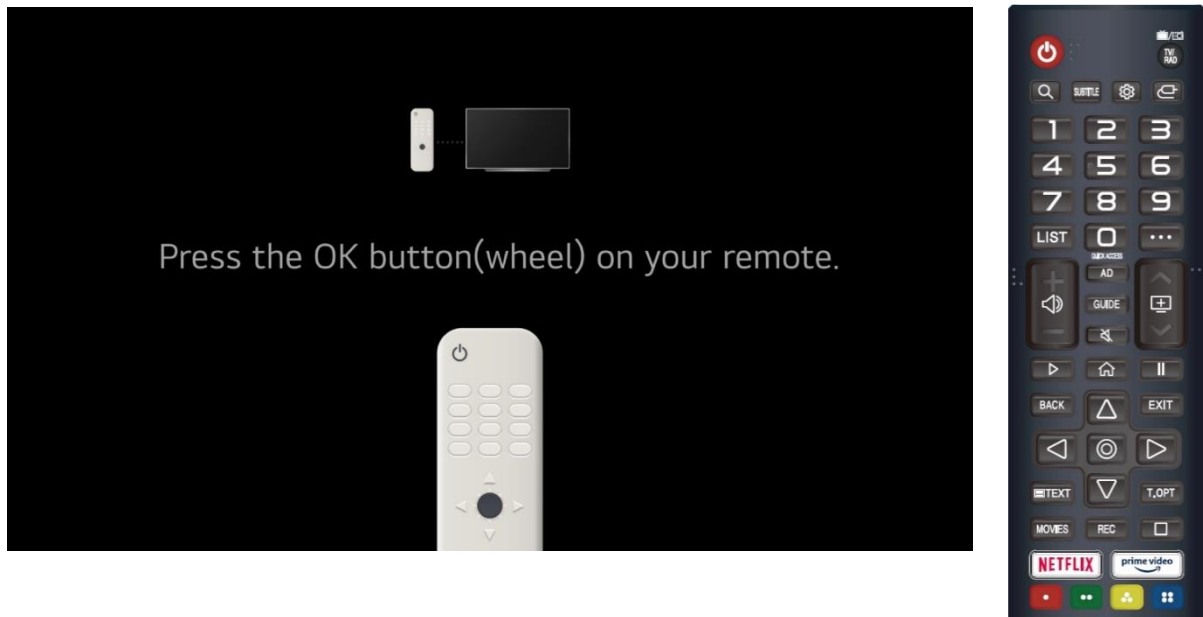

After switching on this screen will be displayed, press the 'wheel' button on the remote

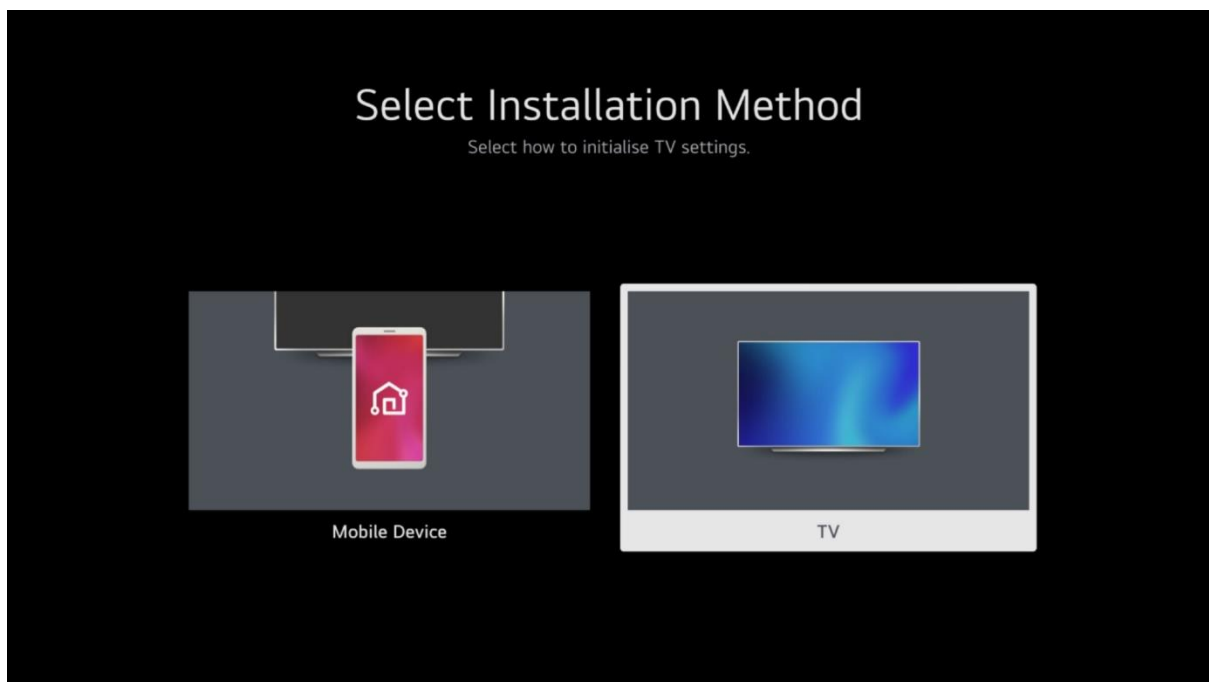

Select TV and press the 'wheel' button on the remote

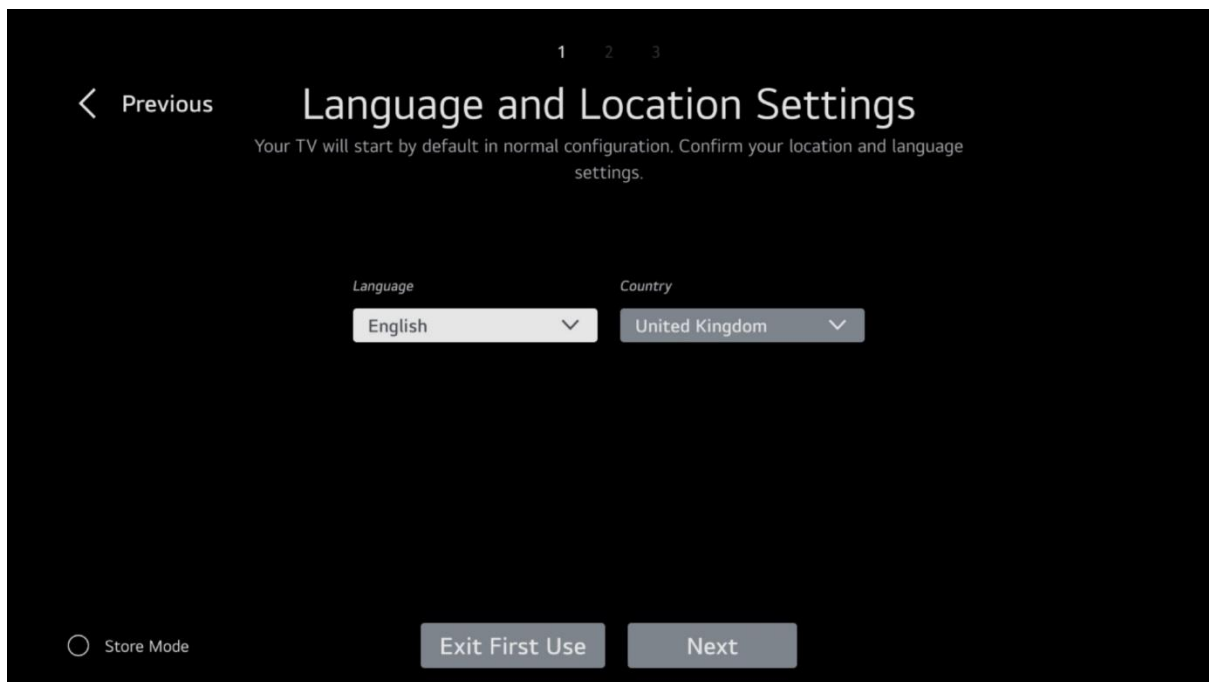

Select your language and country and then press Next

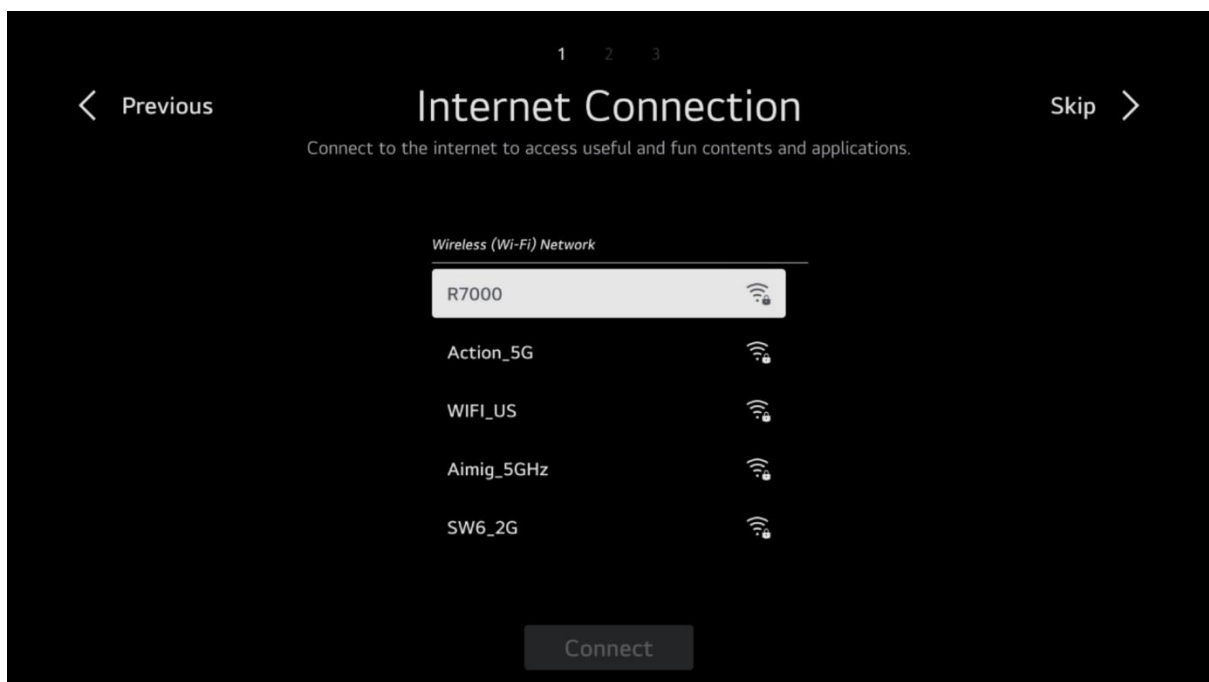

Select your WiFi service and input the password

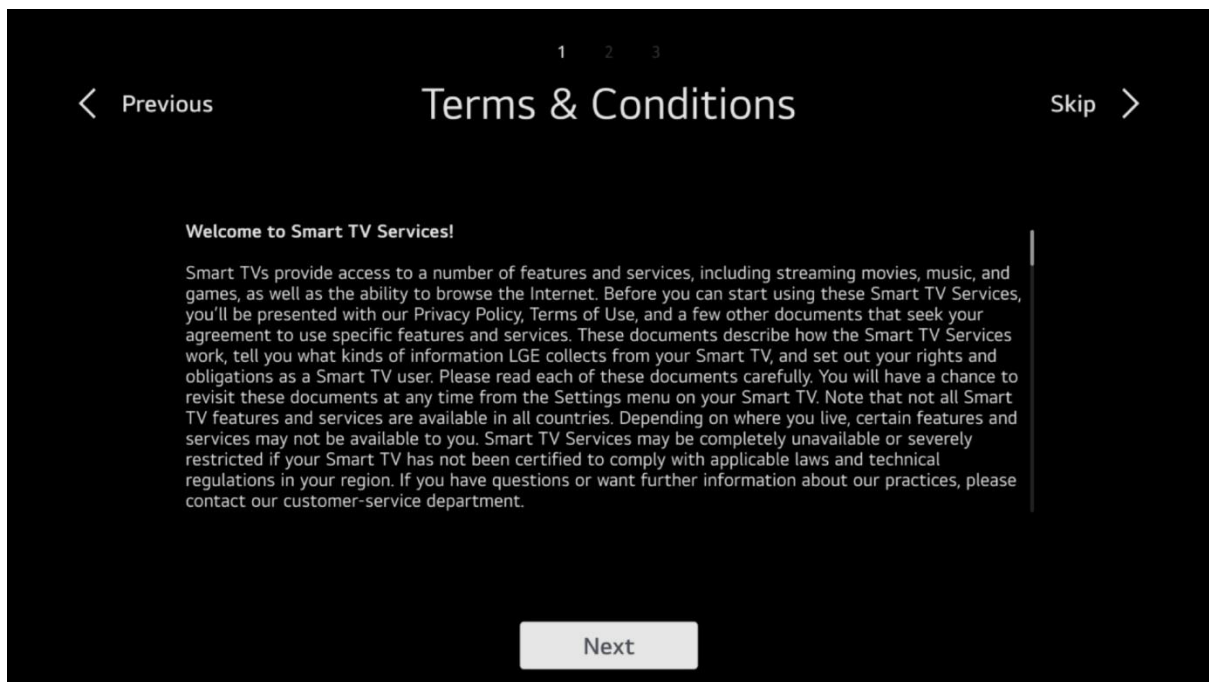

Once you have connected to the internet you need to accept the terms & conditions, click next

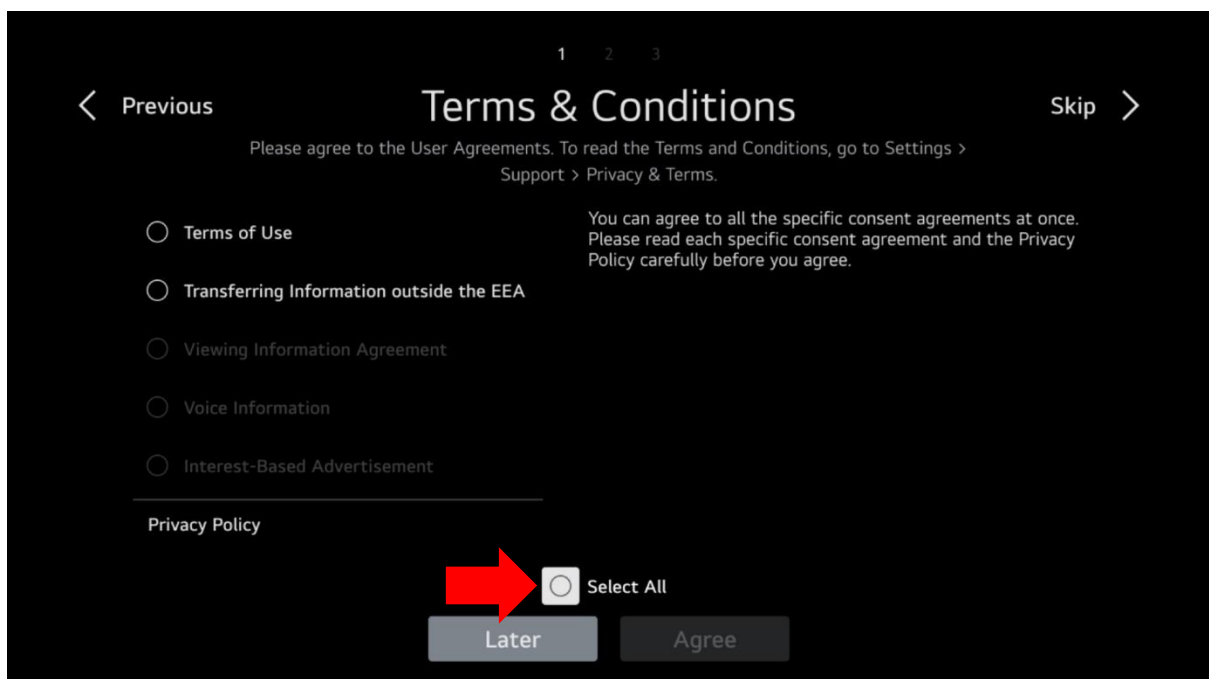

Click Select All

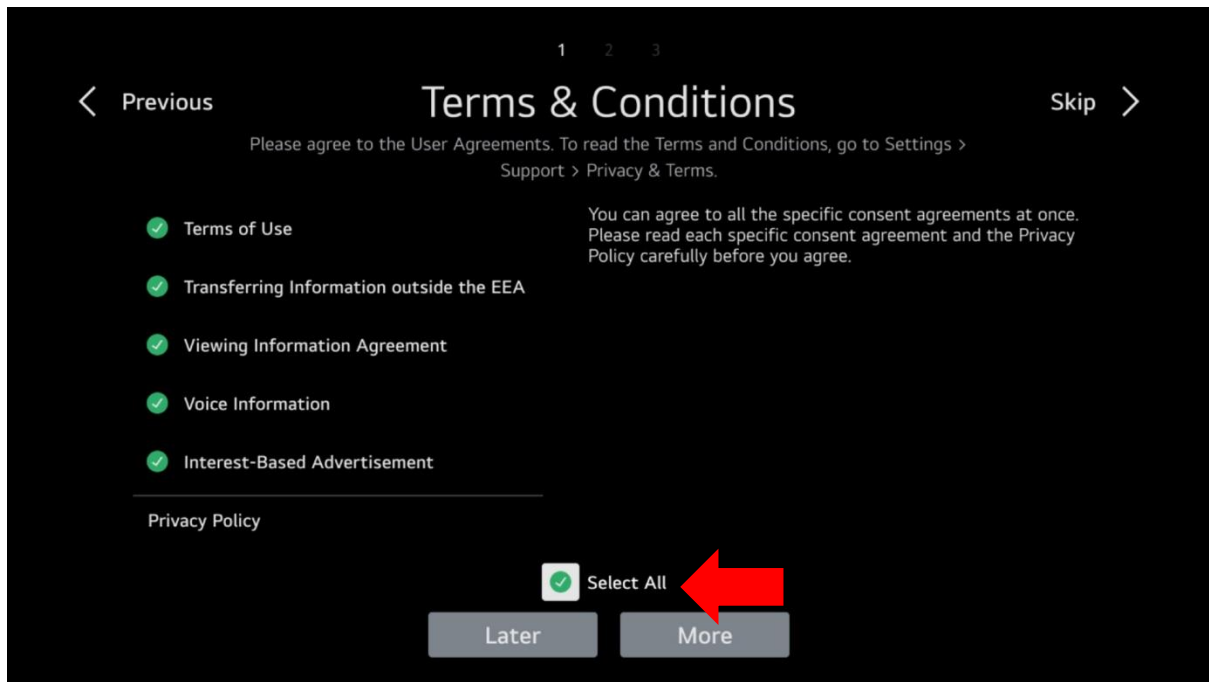

Then Click More

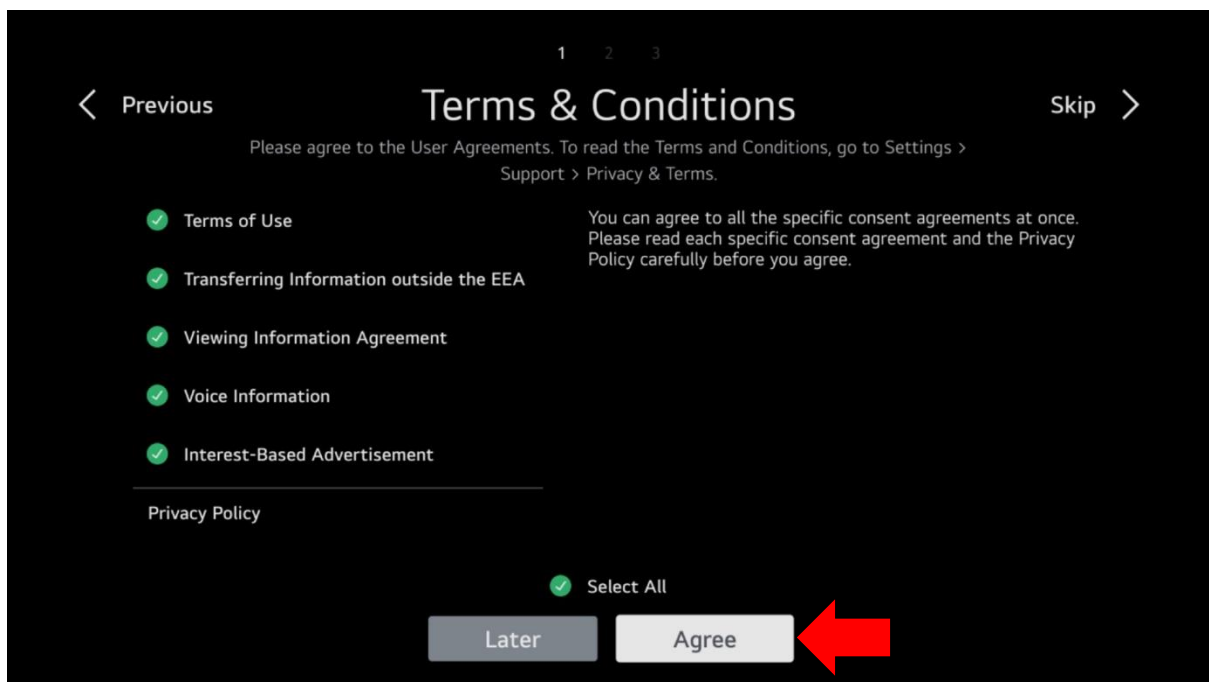

Then Click Agree

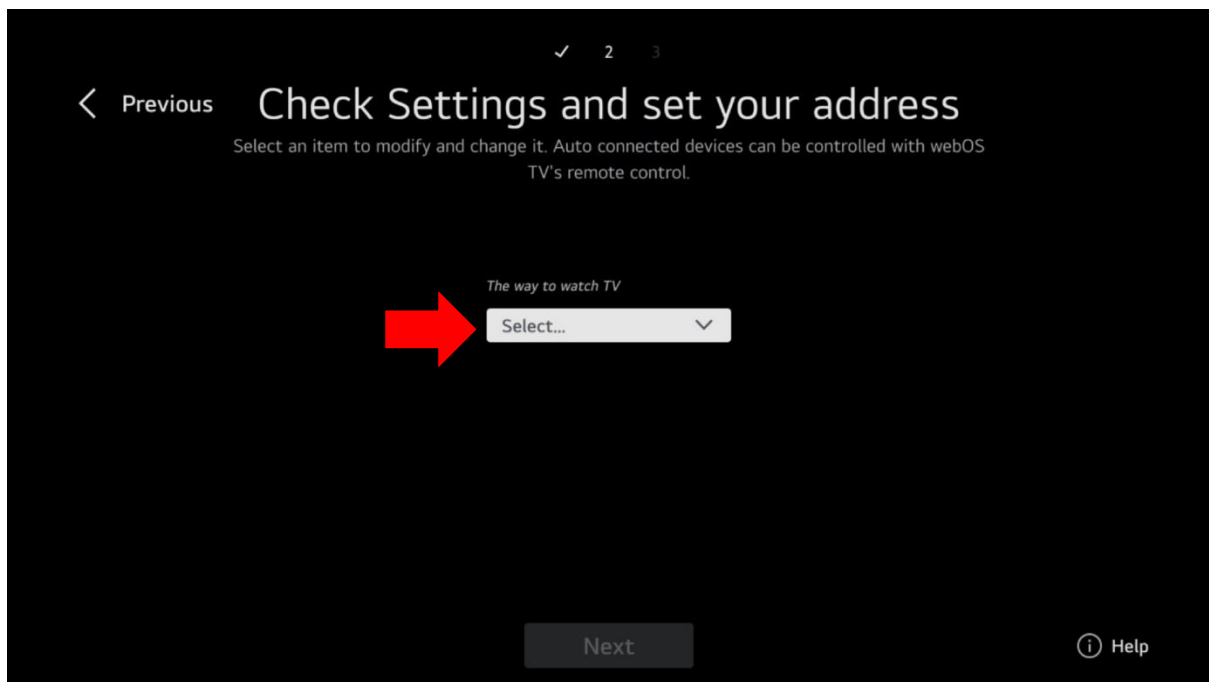

Click on Select to reveal the drop down box

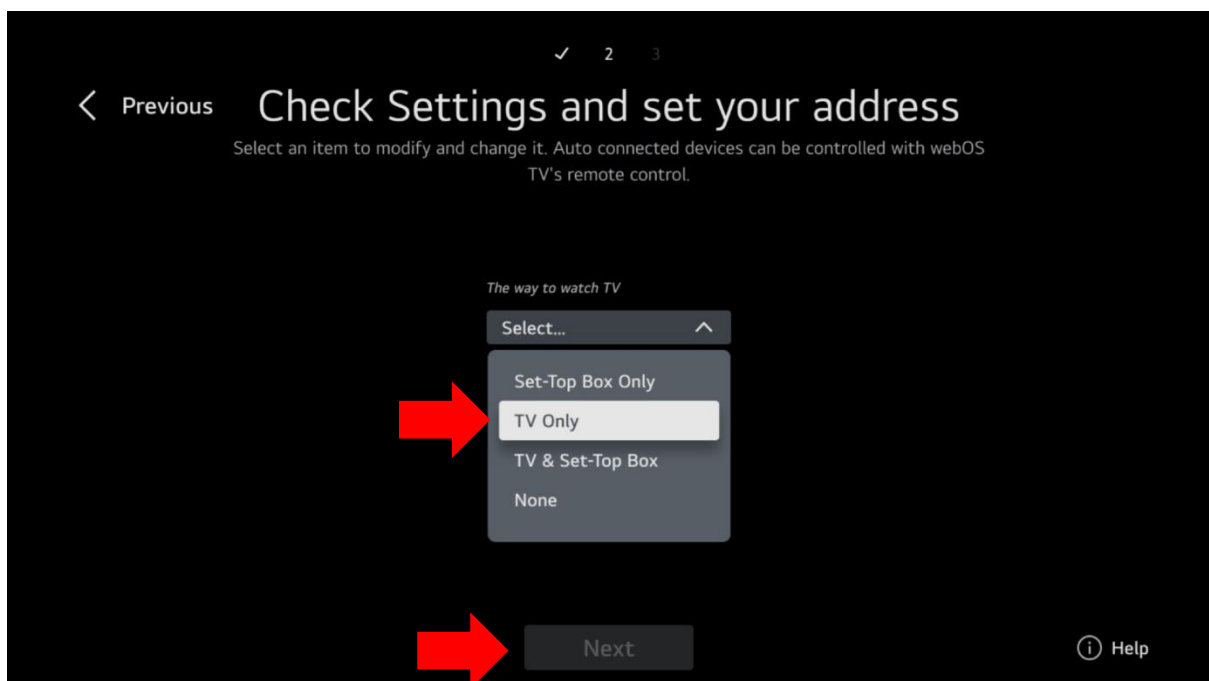

Select TV only and click Next

✓ 2 3

< Previous **Check Settings and set your address**

Select the following setting item and set it.

Service Area Postcode

Enter...

ENG	1	2	3	4	5	6	7	8	9	0	⌫
\$%^	q	w	e	r	t	y	u	i	o	p	Enter
Àà	a	s	d	f	g	h	j	k	l	?	🔊
⬆	@	z	x	c	v	b	n	m	,	.	Clear All

⌂ ⏪ ⏩

Enter your postcode, this is used to get the correct regional programmes on satellite

✓ 2 3

< Previous **Check Settings and set your address**

Select the following setting item and set it.

Service Area Postcode

dl14 6xw

Next

ⓘ Help

After entering your postcode click Next

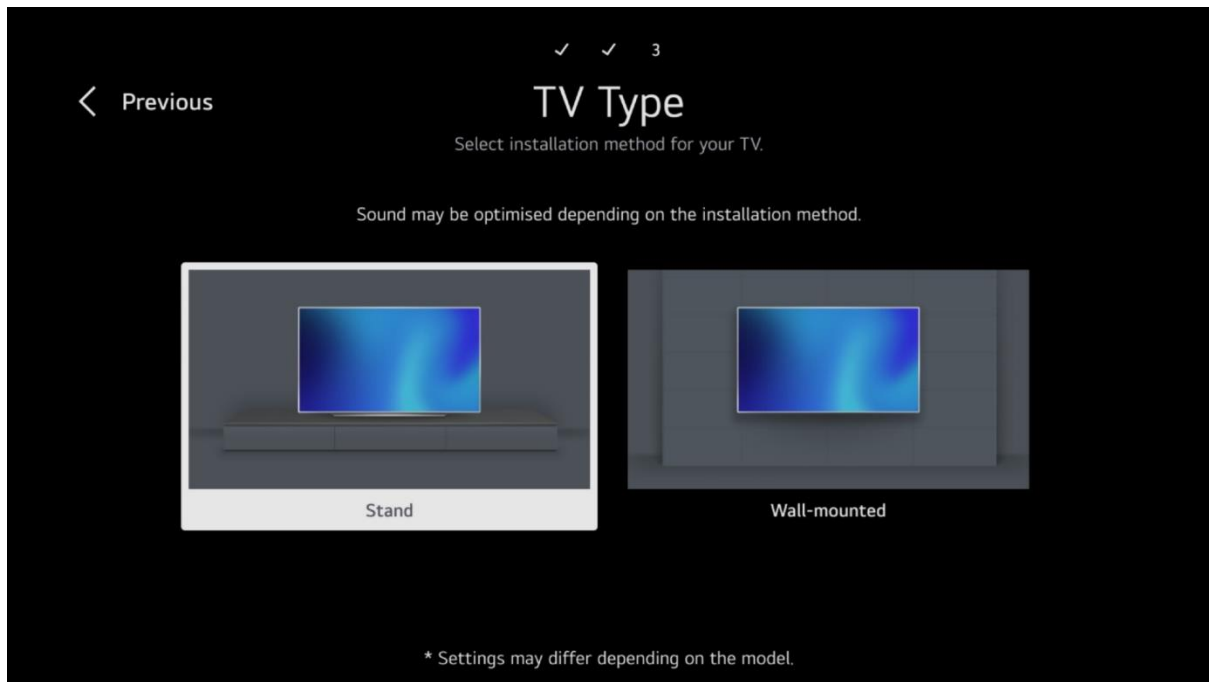

Select whether your TV is fitted to the stand or wall mounted

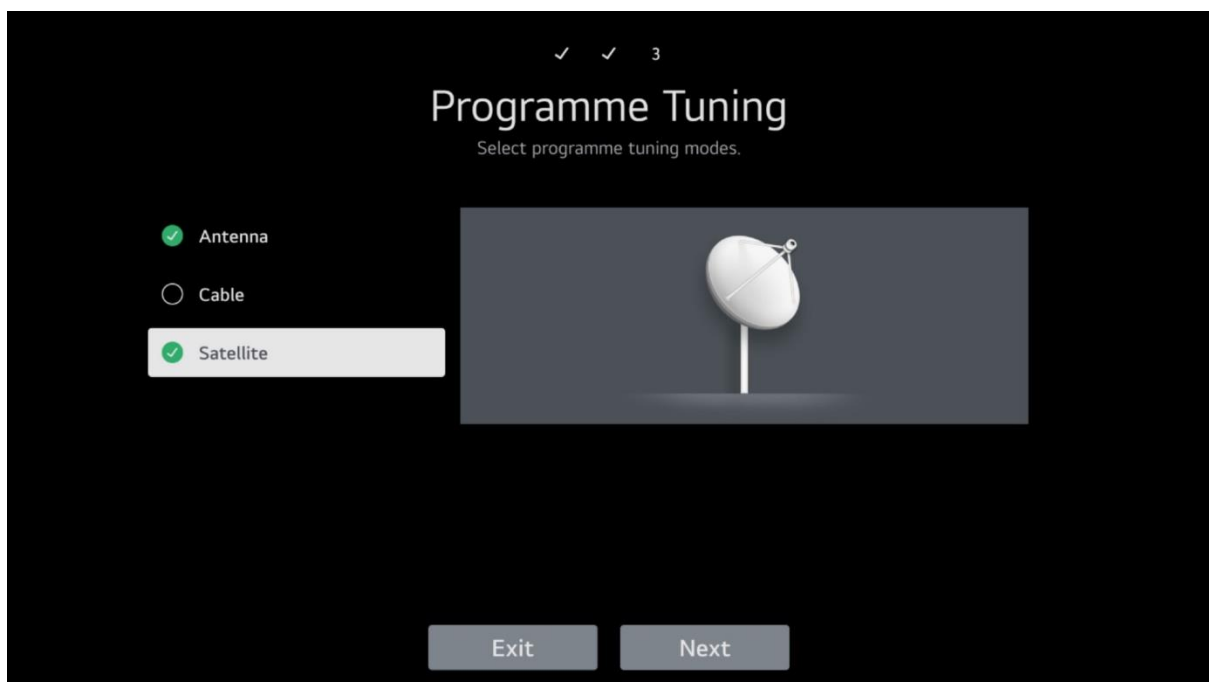

Select what antennas you are using, Antenna & Satellite or Just Antenna or Just Satellite. Do not select Cable in the UK (If you have cable TV in the UK you will use an external box and connect via HDMI, the same is true if you have SKY TV).

✓ ✓ 3

< Previous

Programme Tuning

Select antenna tuning options.

☒ Digital Only Search Skip analogue programmes and tune digital programmes only.

☐ Smart Retuning

Next

Select Digital Only Search and then click Next

✓ ✓ 3

< Previous

Programme Tuning

Select satellite service operator.

☒ Freesat ** If post code you've entered is invalid, post code will be corrected from broadcast signal.

☐ Other Operators

Next

If you selected Satellite then you need select service operator in the UK we only have Freesat in other countries there are more options. Then click Next

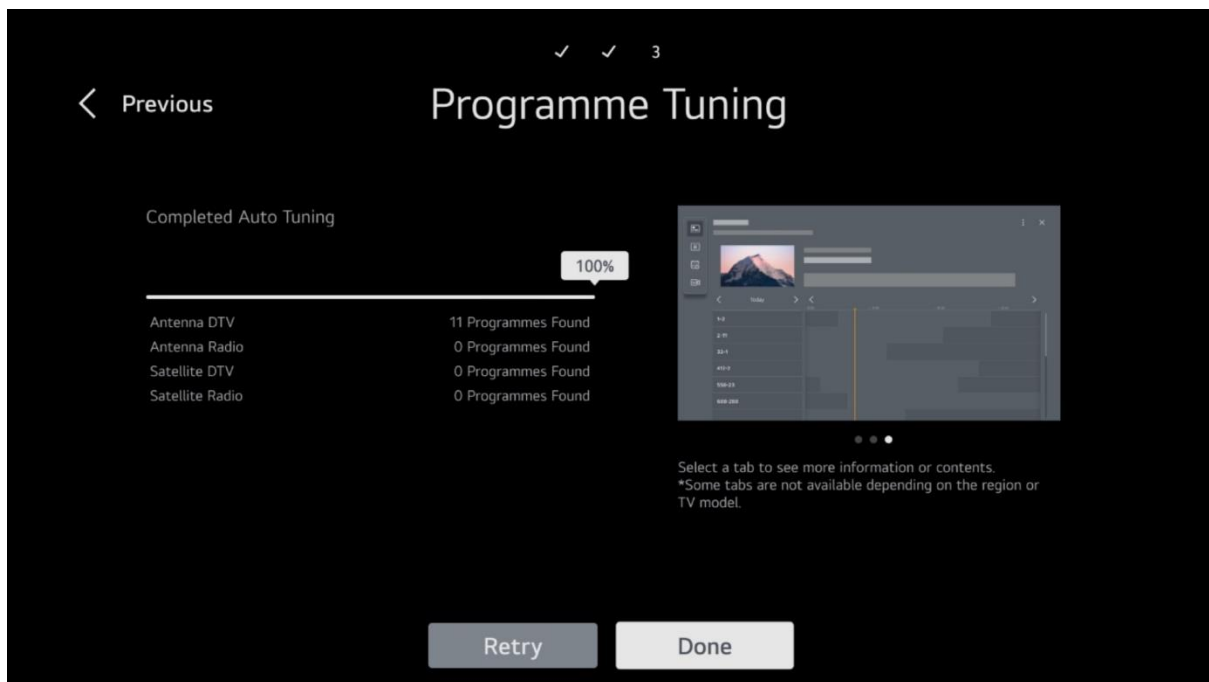

The Tv will tune all the channels, this may take a few minutes. When it is finished click Done

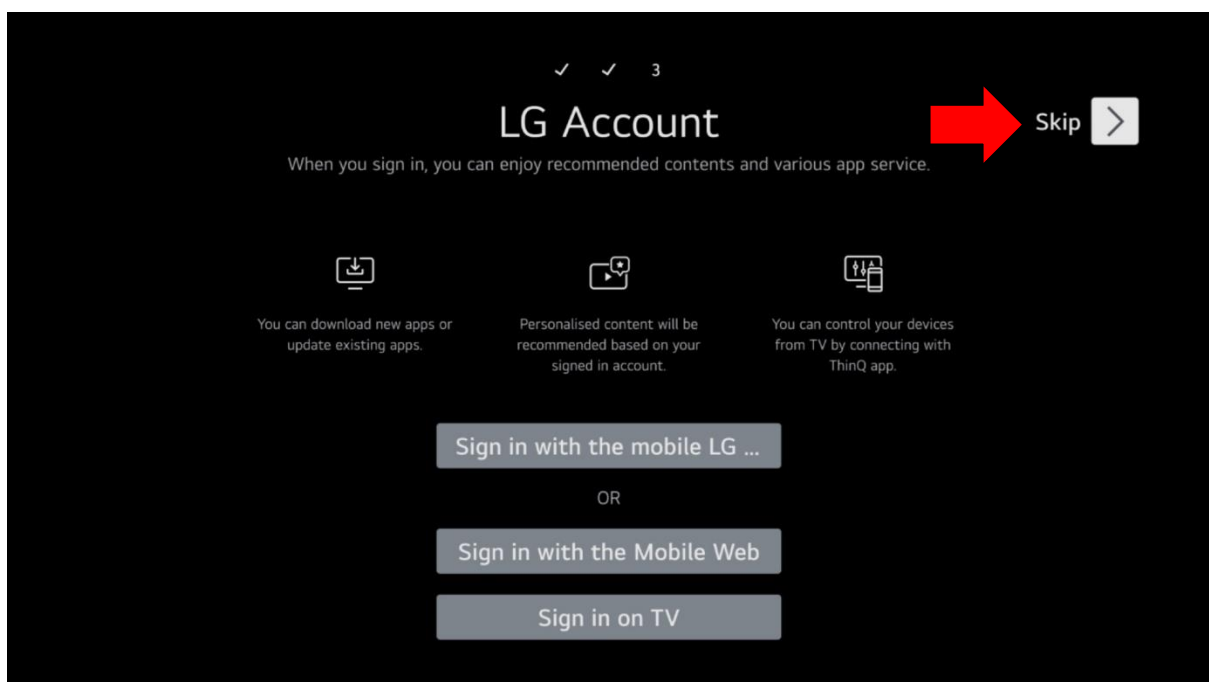

If you have an LG account you can use this page to sign in if you don't then you can select Skip at the top right of the screen

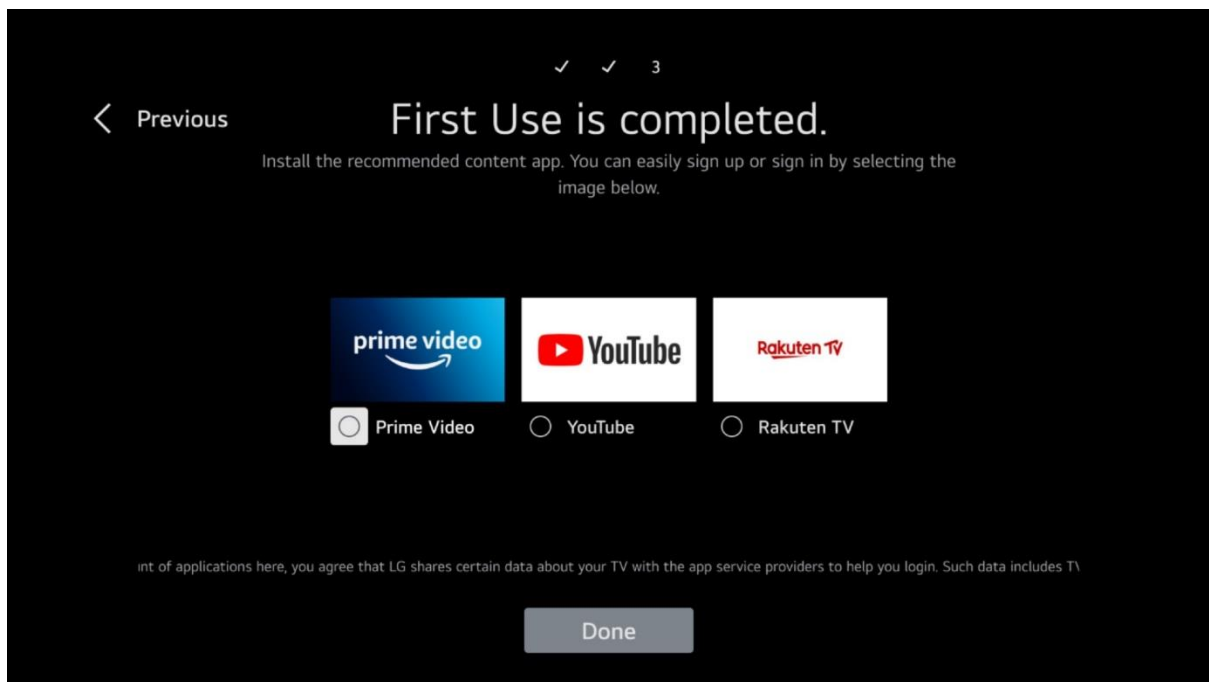

You can use this page to sign into some apps but this can be done later when launching the app.
Click Done



The TV will display BBC 1 the installation is complete.

WebOS TV how to switch between TV and Satellite

When watching TV press List or Guide on the remote control

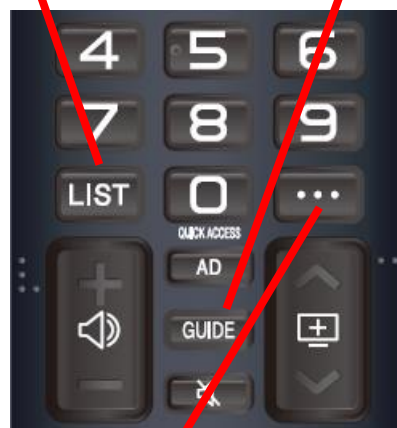
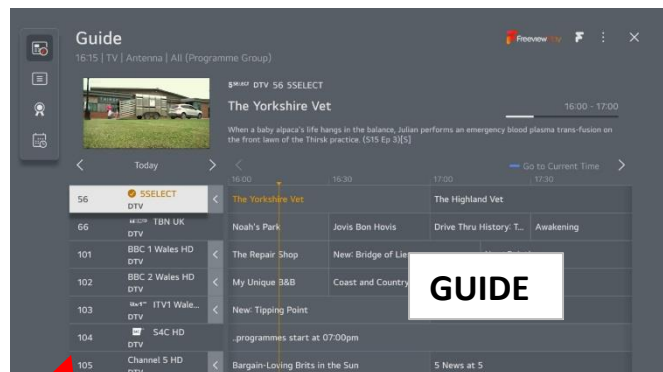
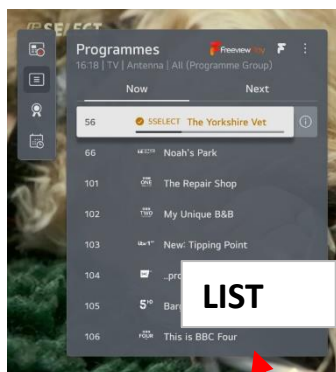

Then press
the 3 dots
... Button

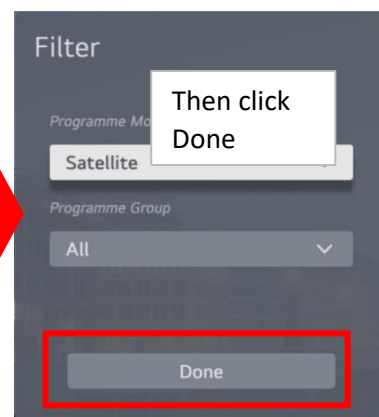
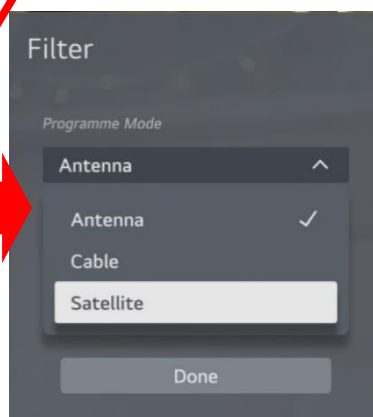
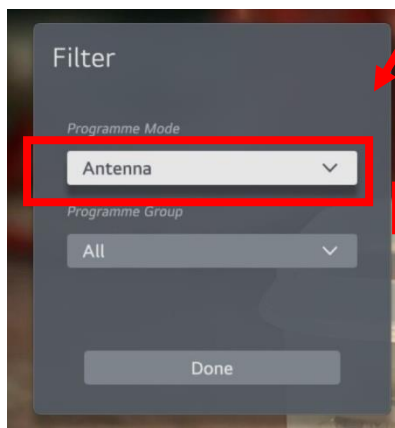

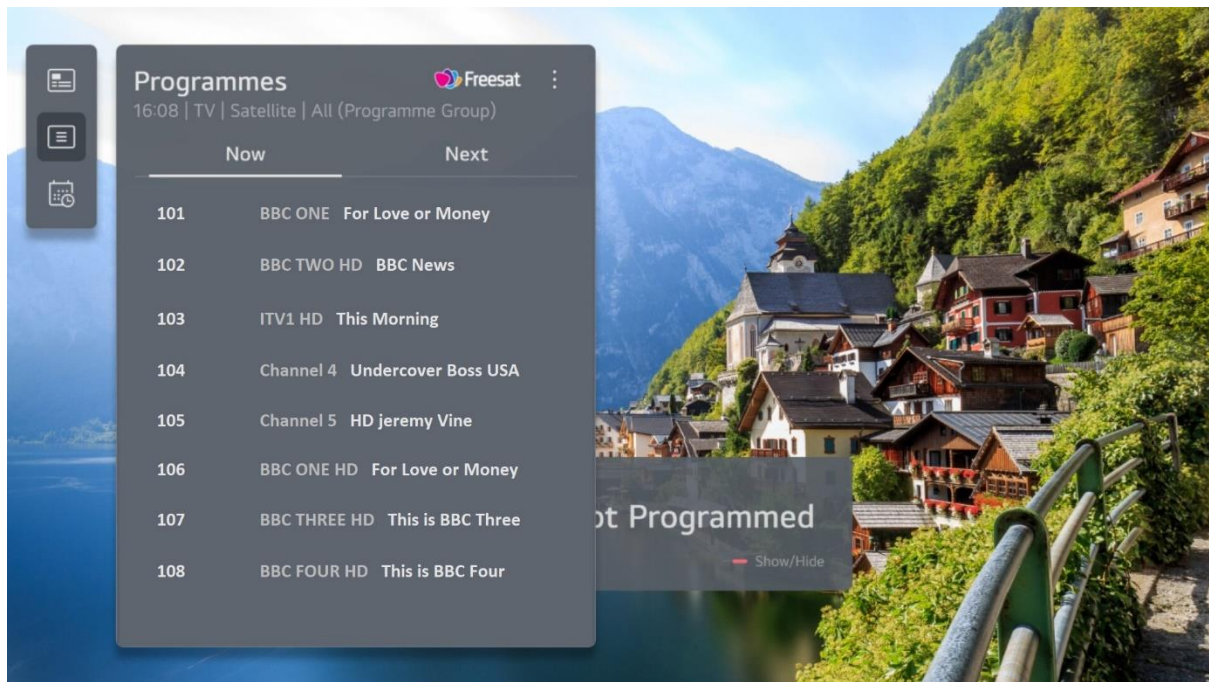

The Tv will now be showing the satellite programmes.

Reverse the process to go back to TV.

WebOS TV Changing Source

Whatever screen you are on press Home button on the remote

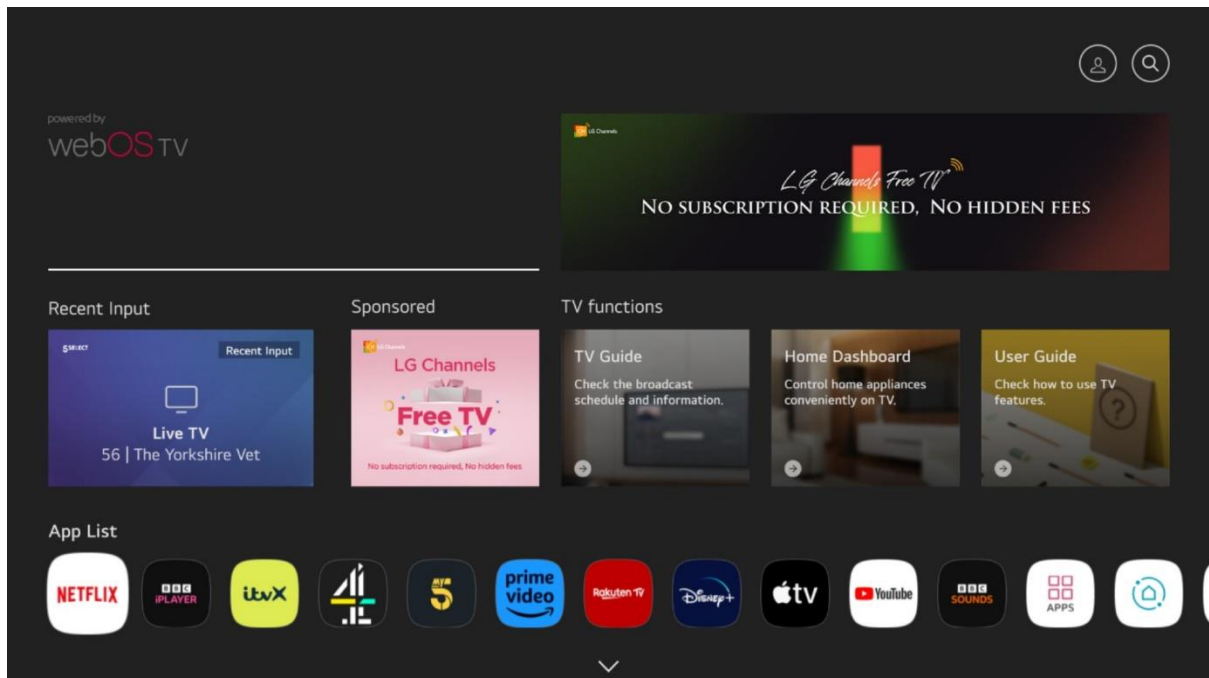

Then Press the down button

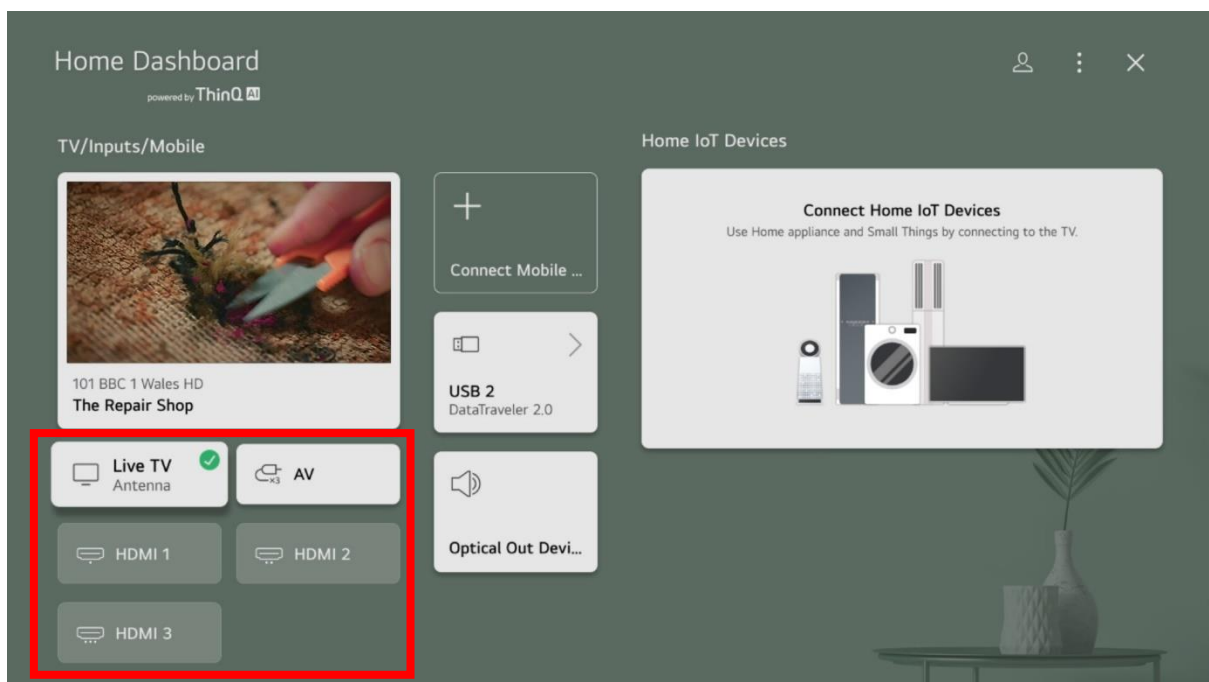

Then select the correct input from the ones shown.

Alternatively if you are watching TV or Satellite then press this button:



Then select Home Dashboard

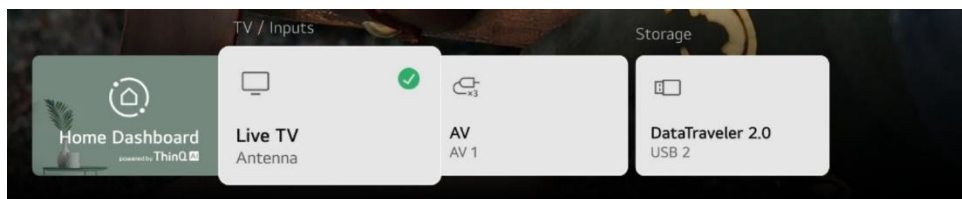

Then select the required input as before.

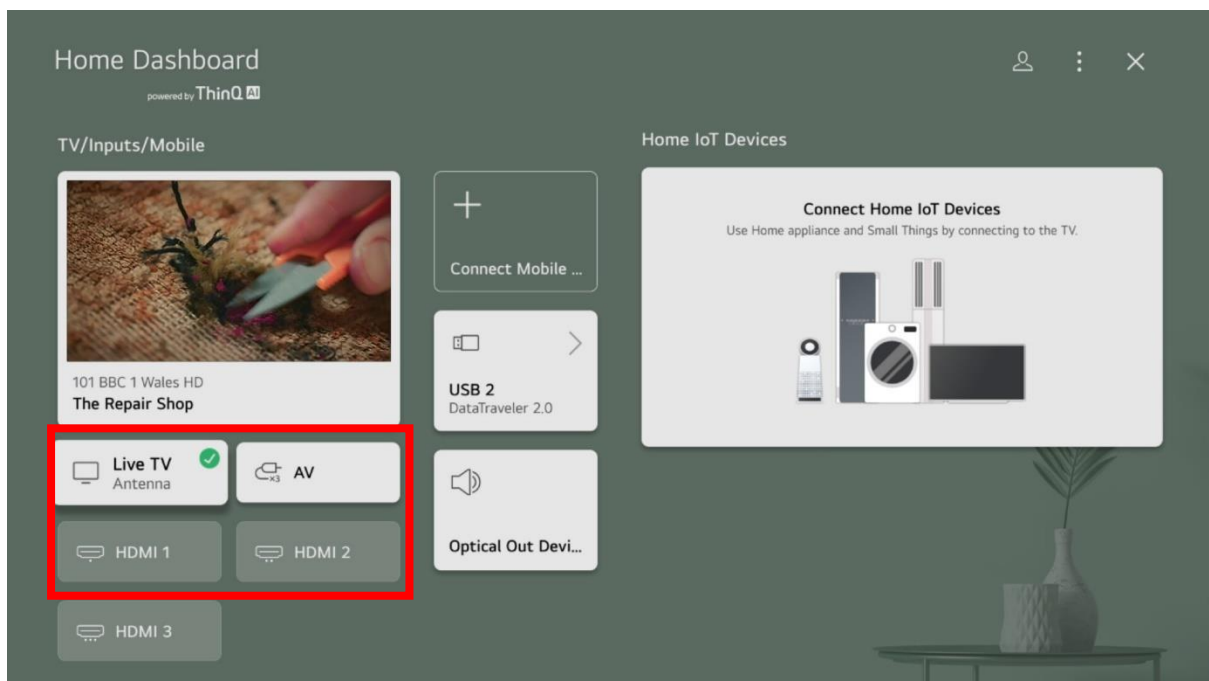

How to download apps from the WebOS App Store

In order to use the FVP features and for catchup TV you will need to download the catchup apps. Apps like Netflix, YouTube and Prime video are already installed but BBCiPlayer, ITVX, All4, My5 and UKTVPlay need to be installed.

Press the home Key on the remote to get this screen

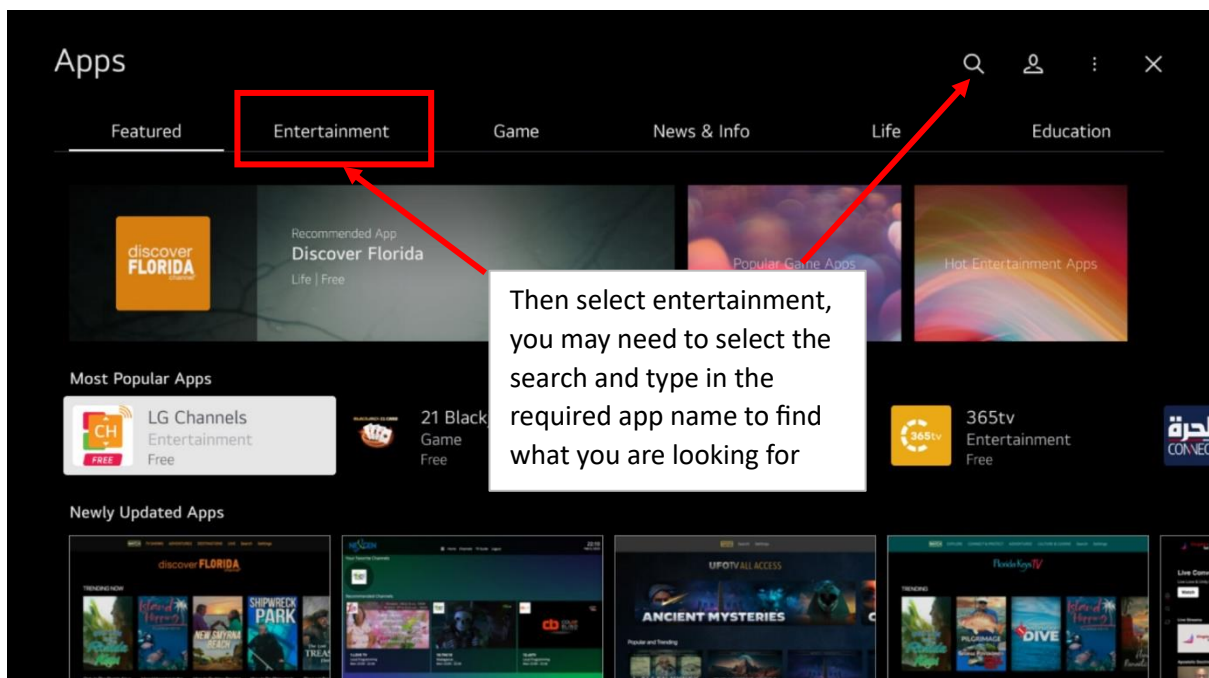
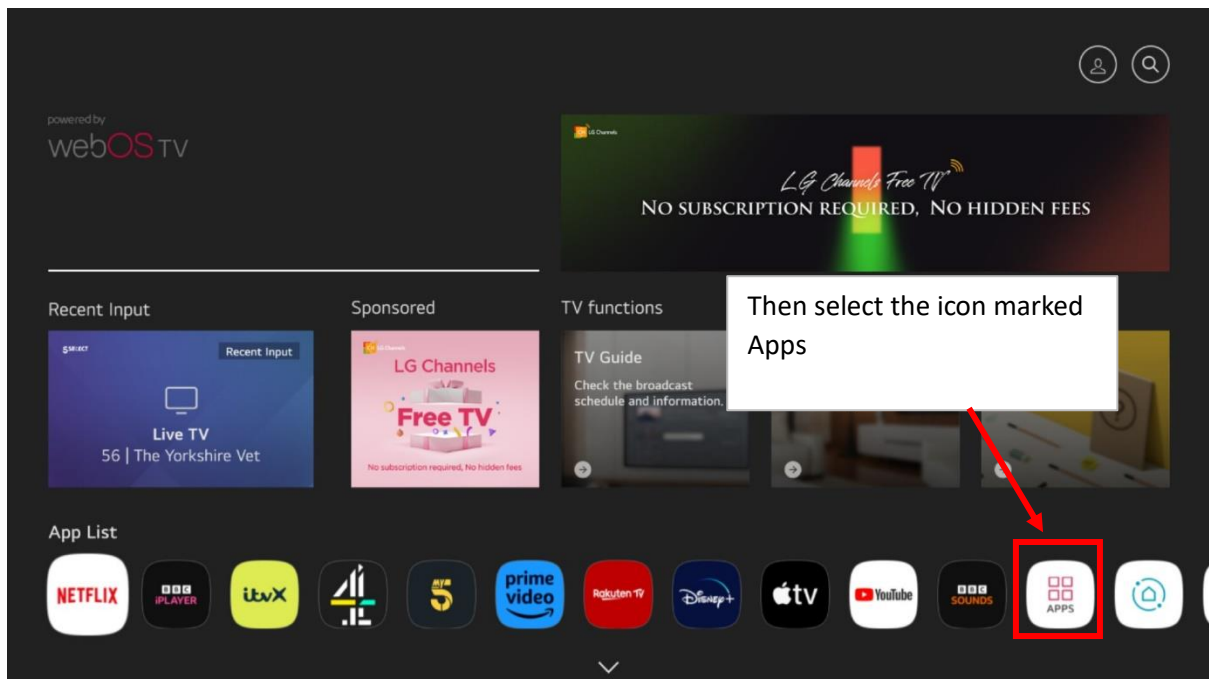

Once you have found the app you want click on it and then click Install

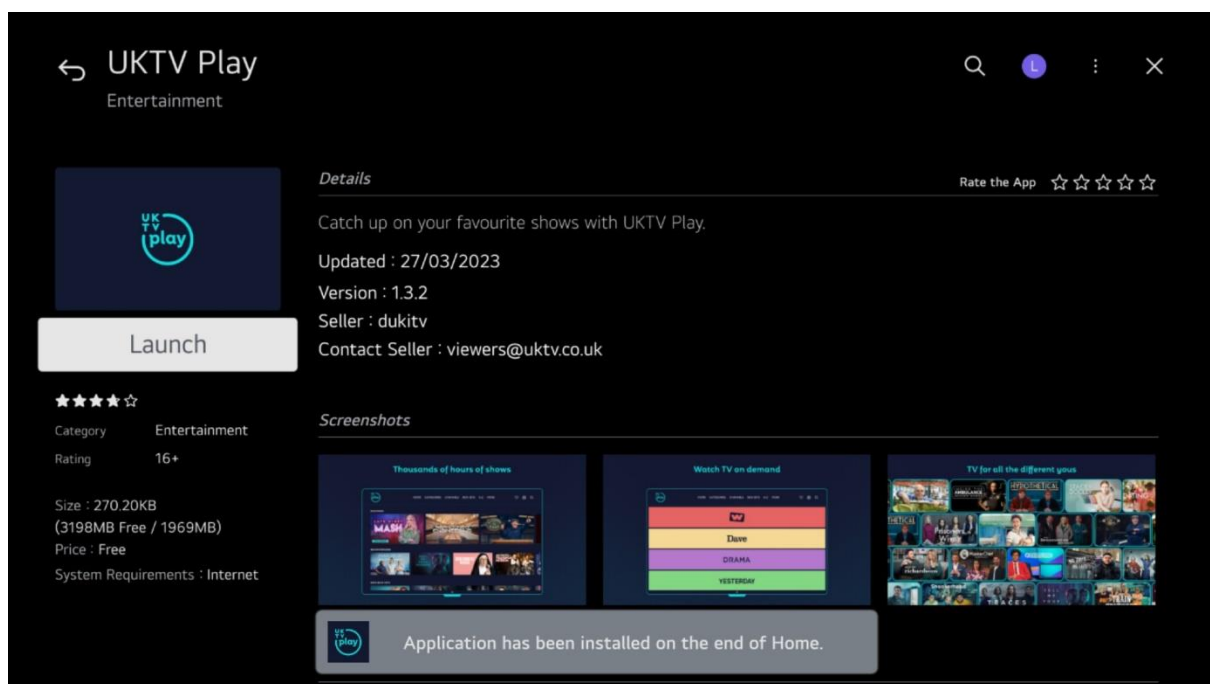
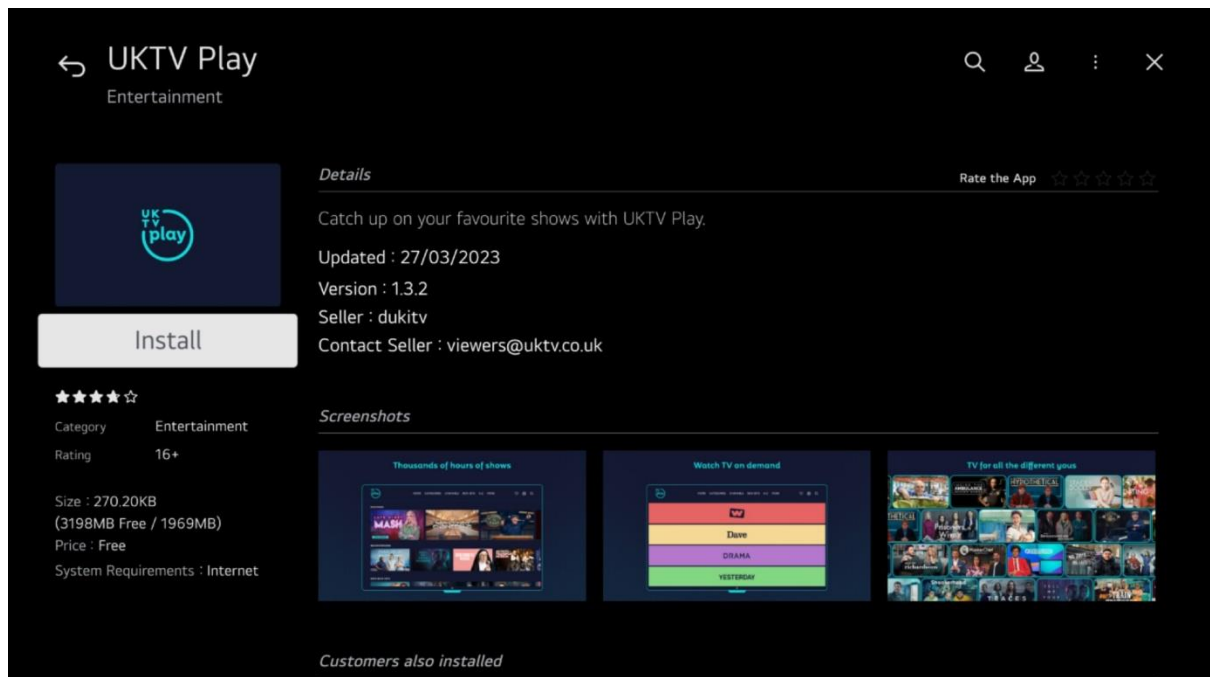

The installed apps will appear on the line of apps at the bottom of the home screen

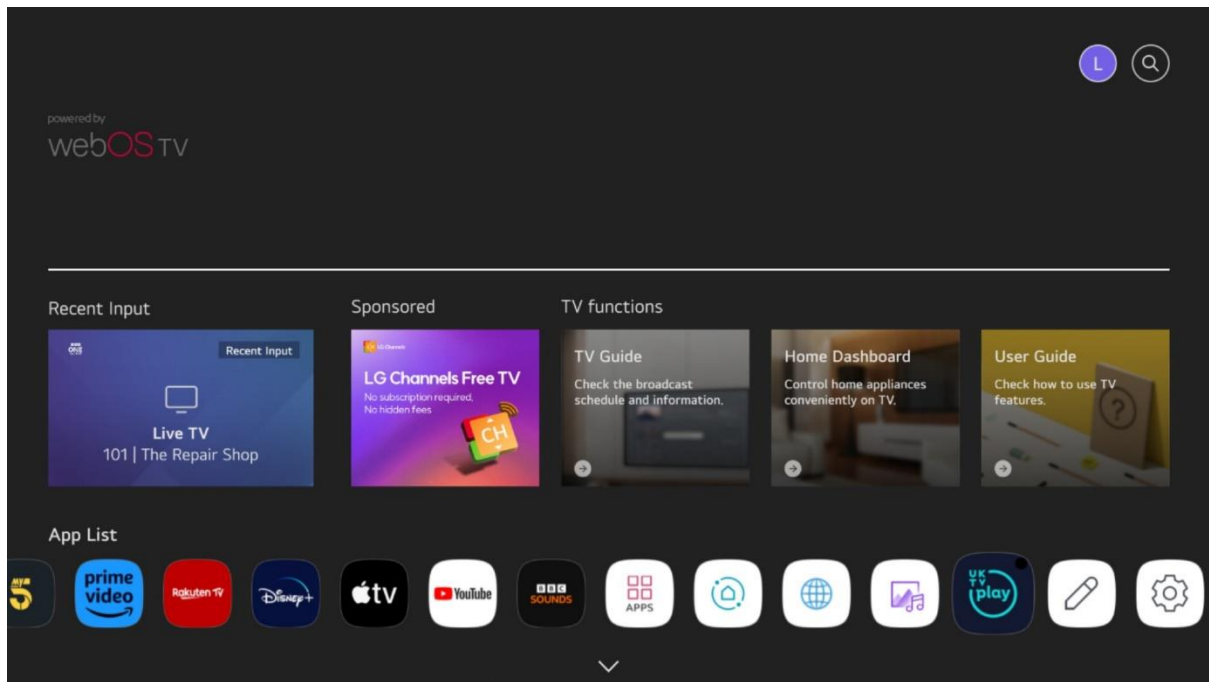

You can also set the apps into the Quick Access Menu

If you enter for instance BBCiPlayer then press and hold the 0 button, then the Quick access edit will appear move the highlighted segment to the button you want to store it on (1-9) then click OK and the app will then be on that for quick access. Then to access it from anywhere press and hold the button for the app (so if you stored BBCiPlayer on 1 then press and hold 1 and the BBCiPlayer app will open. You can store up to 9 things in the quick access menu.

How to access FreeviewPlay catchup on the WebOS TV

When watching TV press the Guide button on the remote

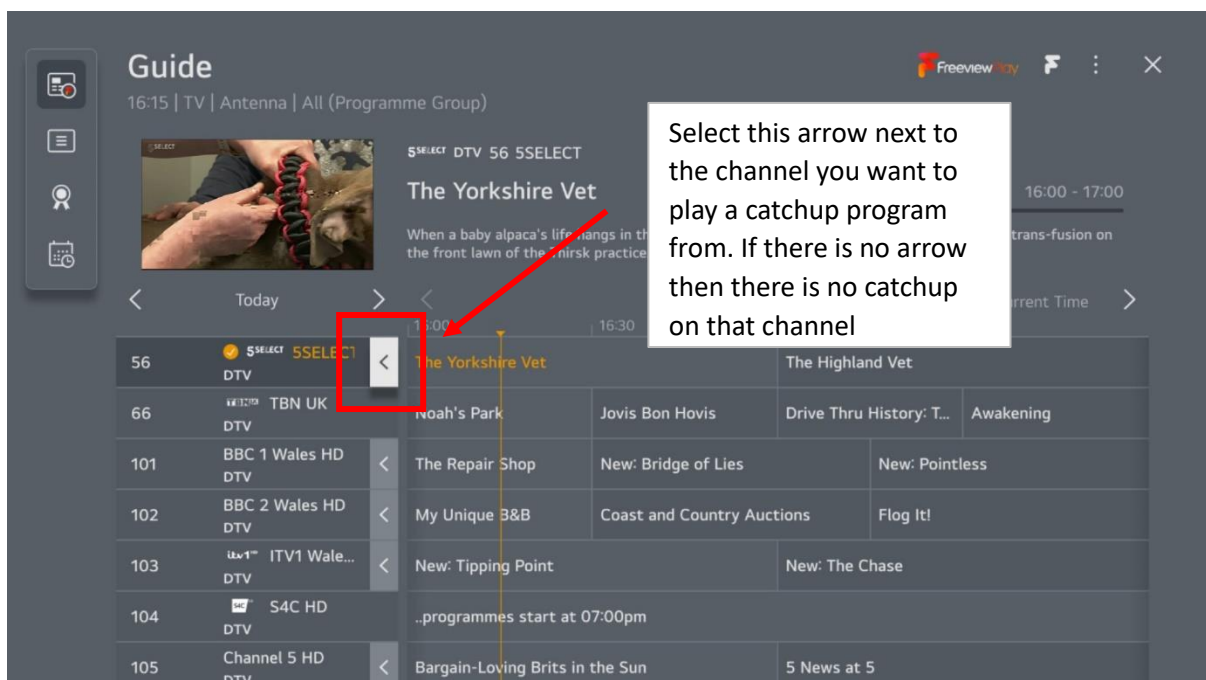
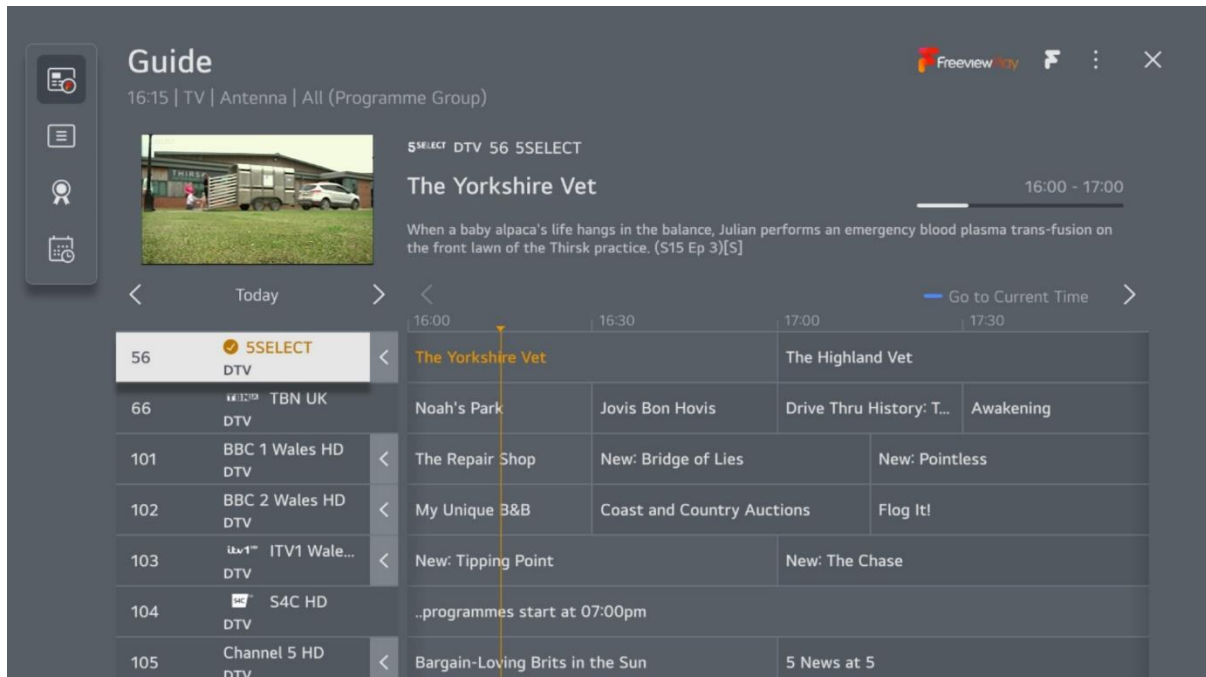

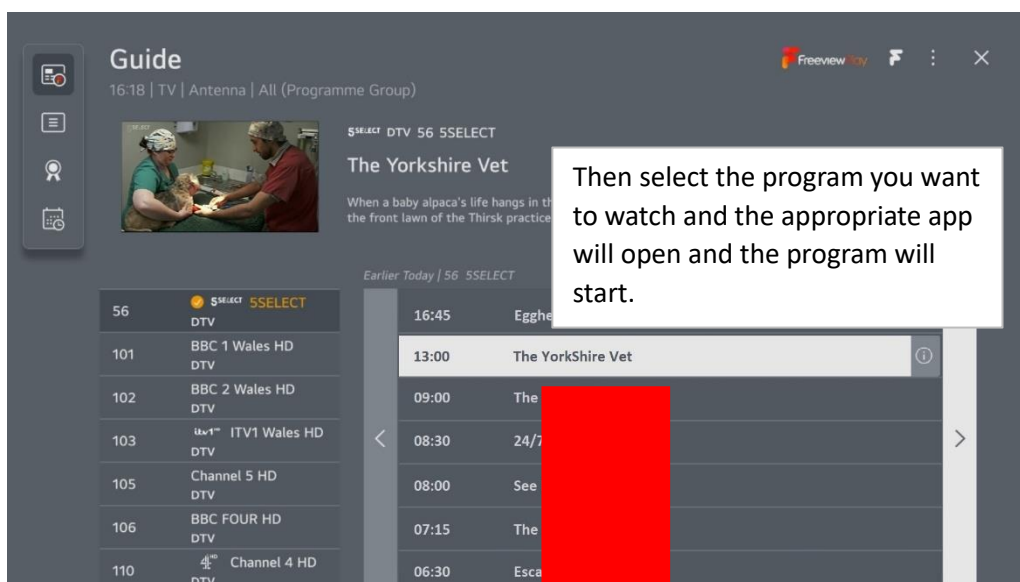
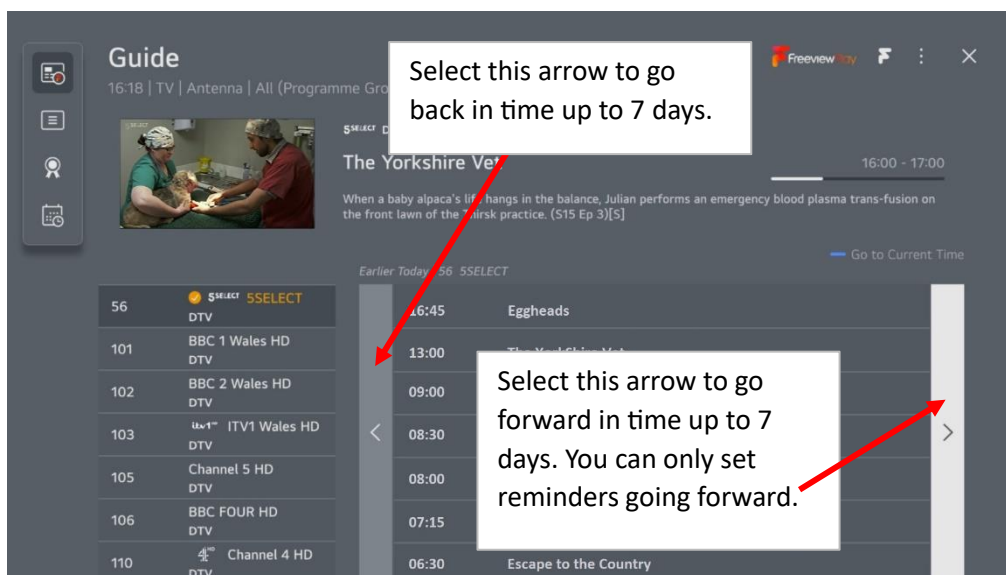

WebOS TV How to set up and manage Favourites

While watching TV or satellite press either LIST or GUIDE buttons on the remote:

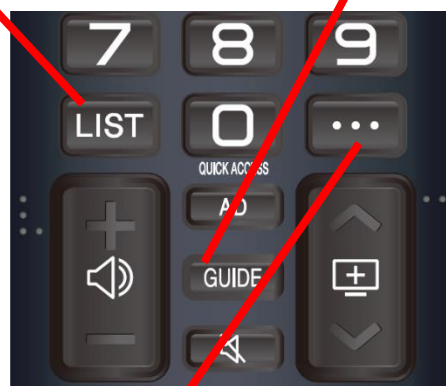
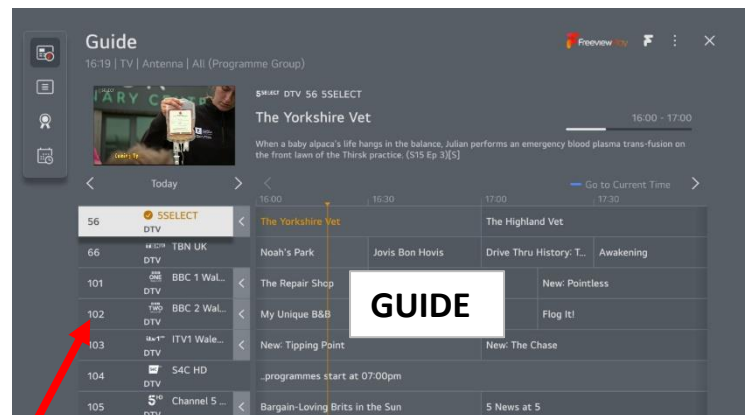
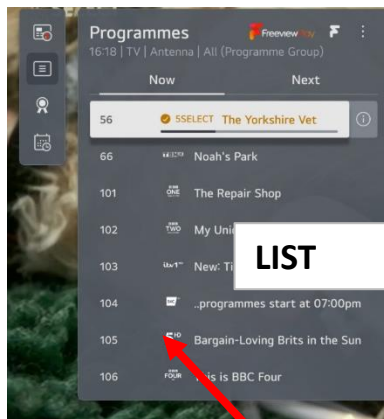

Then press
the 3 dots
... Button

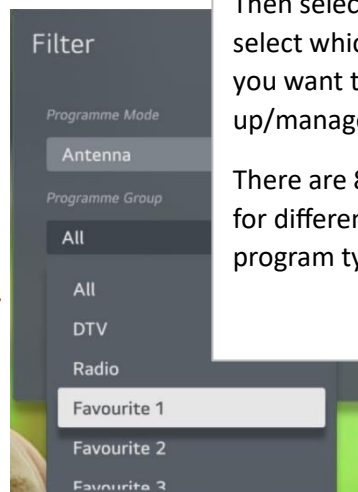
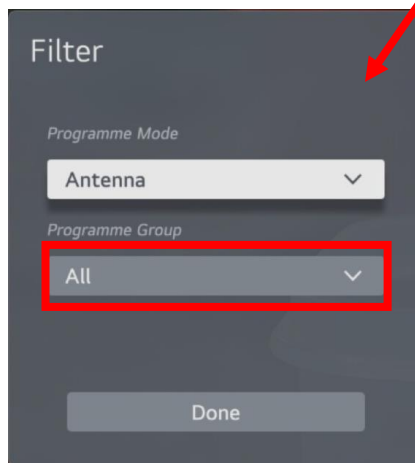

Then select All and
select which Favourite
you want to set
up/manage.

There are 8 Favourites
for different people or
program types.

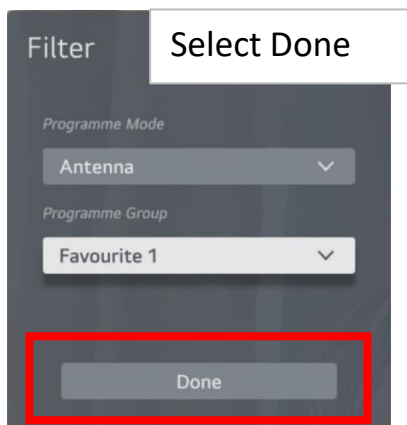

If this is the first time the list is selected there will be nothing in it so select Edit Favourites

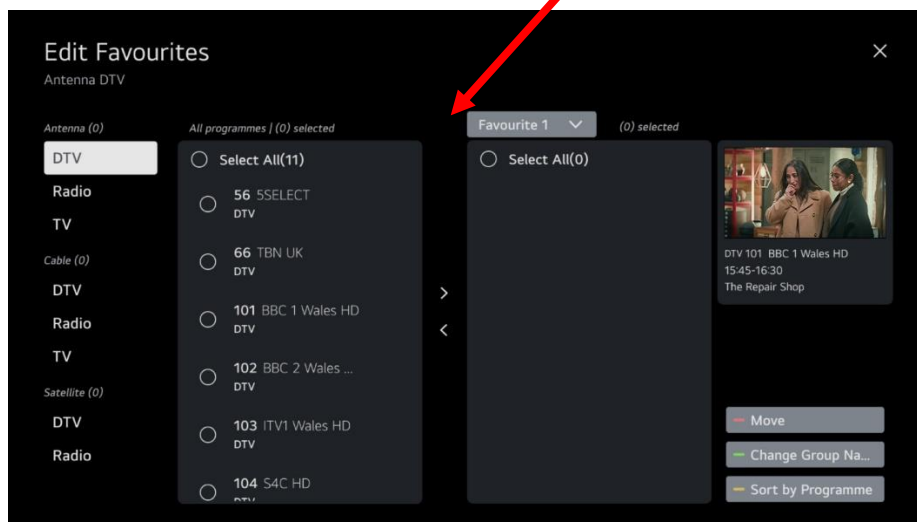
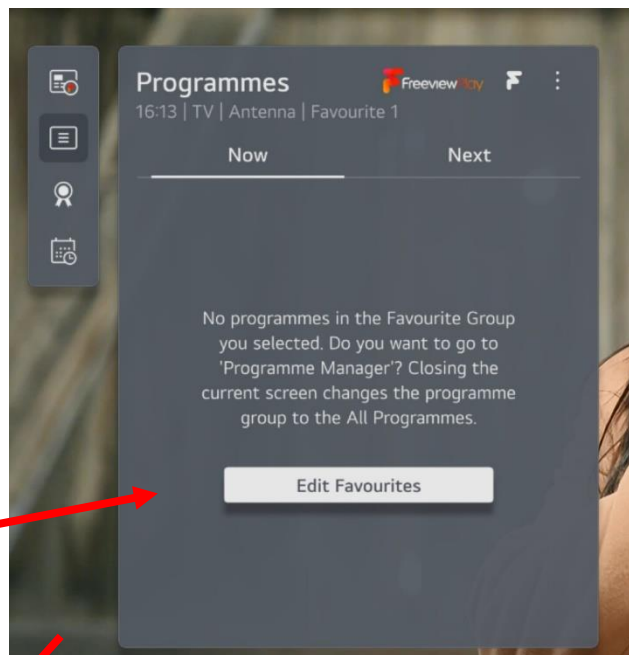

Select the programs you want to add to your list by highlighting them and pressing the OK button, once selected the circle will turn green.

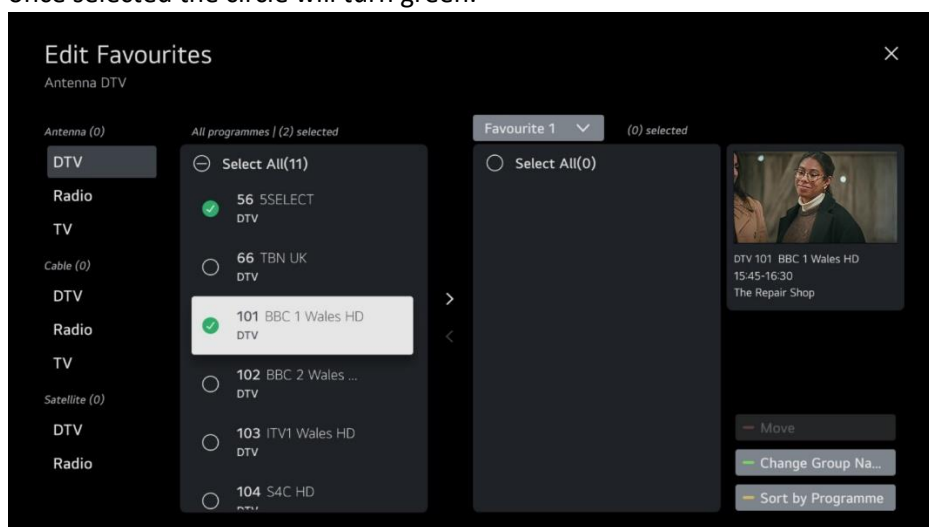

After selecting the programs you want in your list select the right arrow between the 2 boxes and click OK.

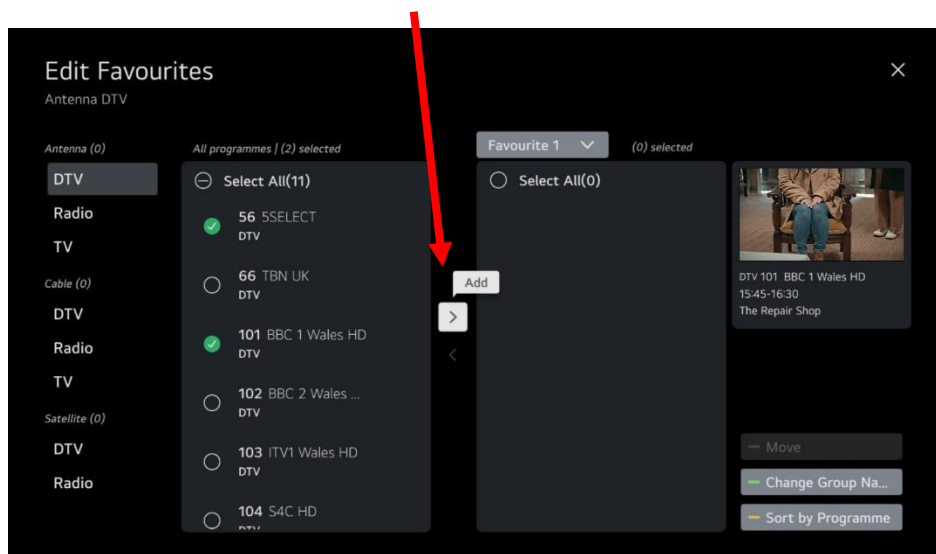

This will move the selected programs to the Favourite List

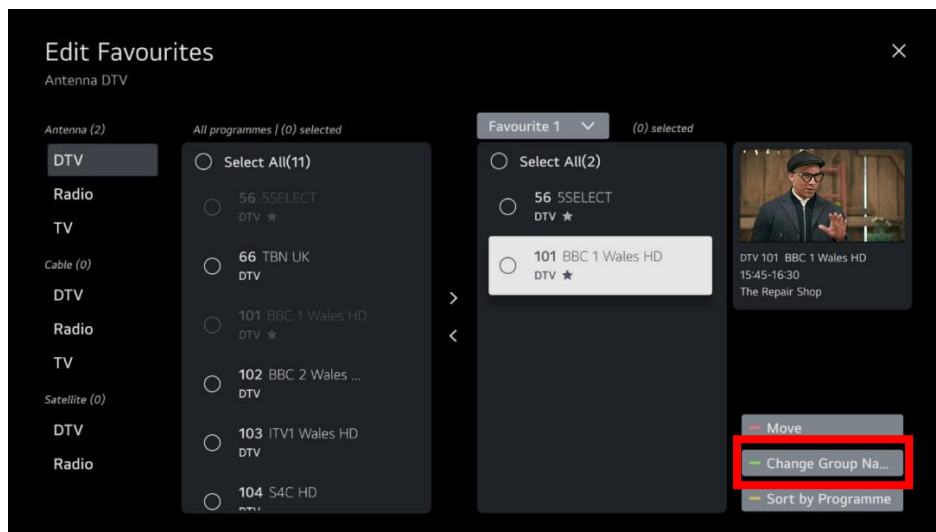

You can change the name of your list by clicking the green button on your remote.

This will open an on screen keyboard for you to type the new name of your Favourite List

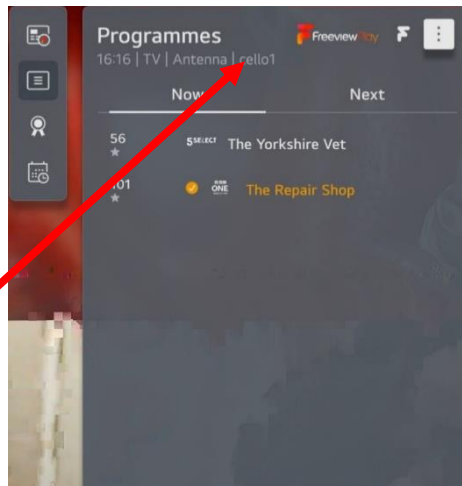
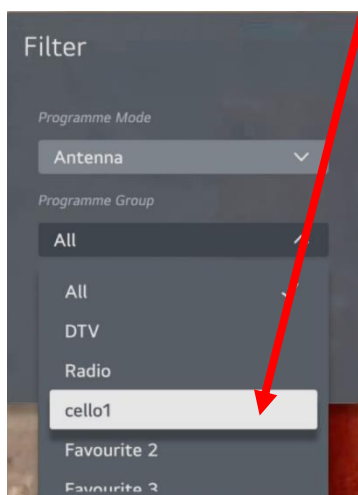
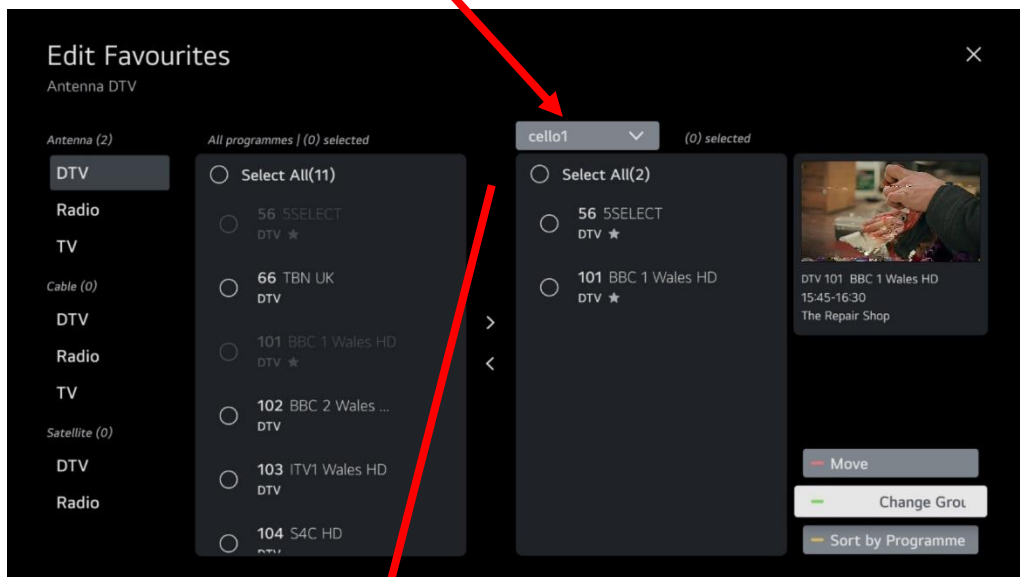
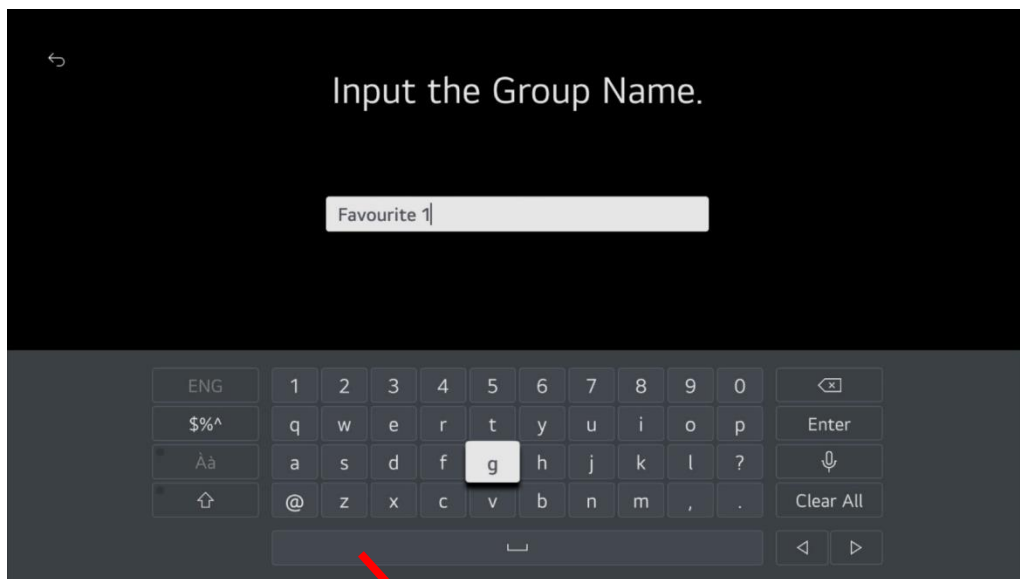

To edit a Favourite List press Guide and select the list to edit

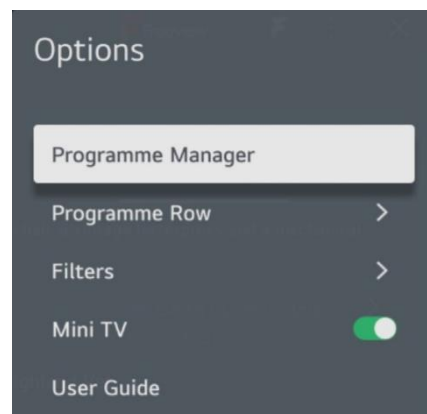
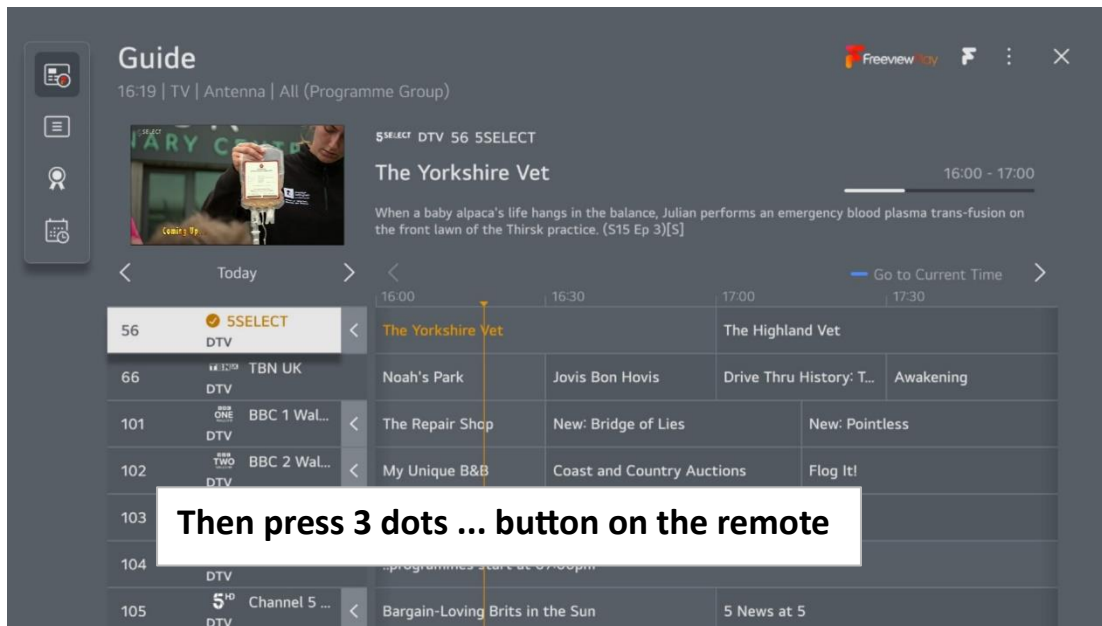

Then select Program Manager

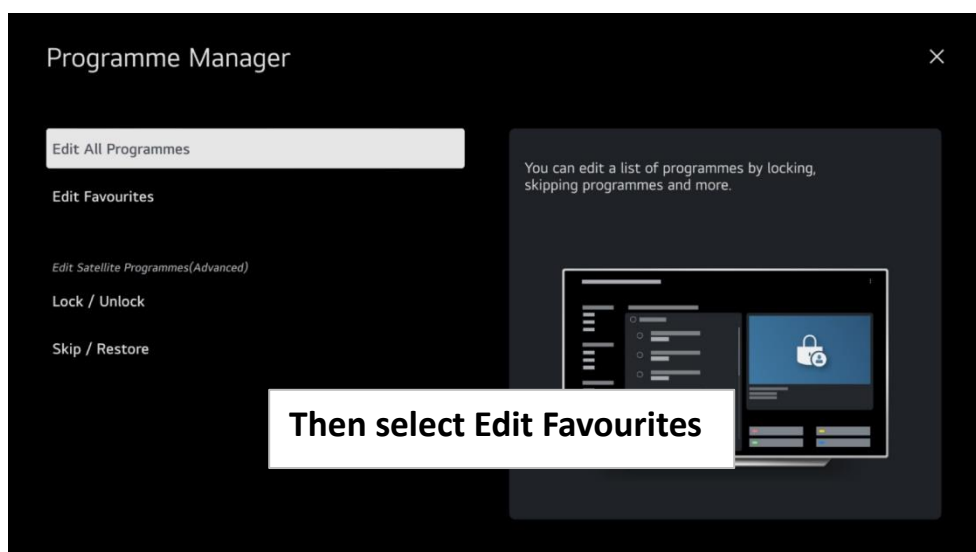

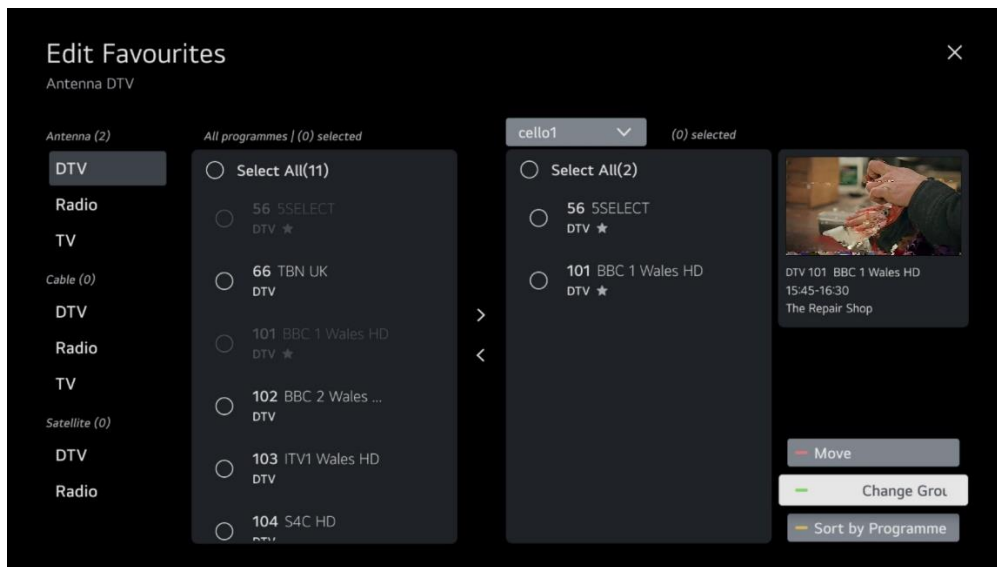

To add programs to your list highlight them in the left hand list and click OK for the circle to turn green and then use the right arrow between the two lists to transfer them.

To remove programs from your list highlight them in the right hand list and click OK for the circle to turn green and then use the left arrow between the two list to remove them.

To edit your list name press the green button on your remote and follow the steps from earlier in the guide for naming your list.

How to move Channels in your Favourite List on the WebOS TV

You can change the order that channels appear in your favourite list as follows

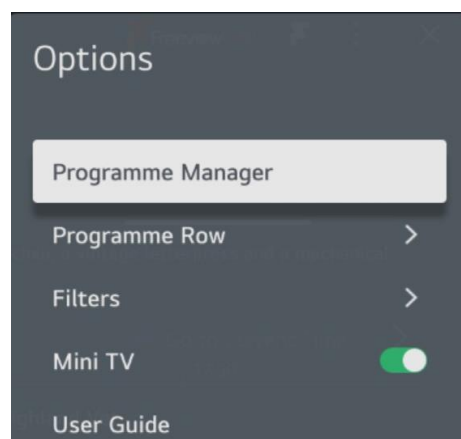
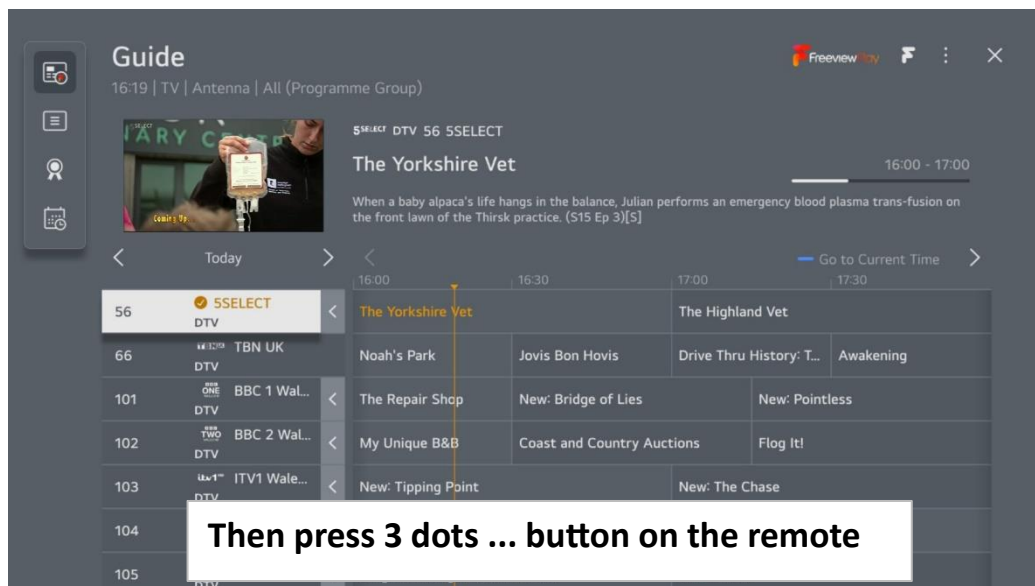

And select Programme Manager

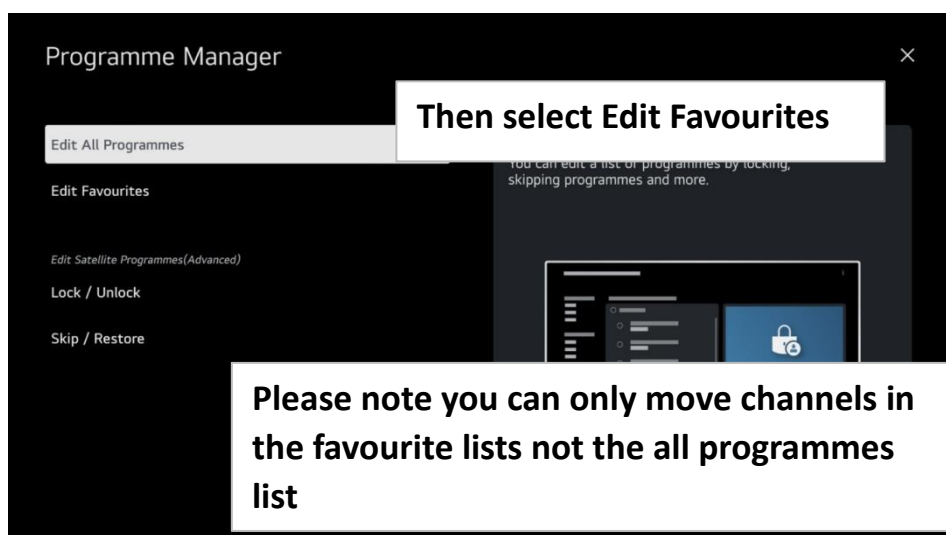

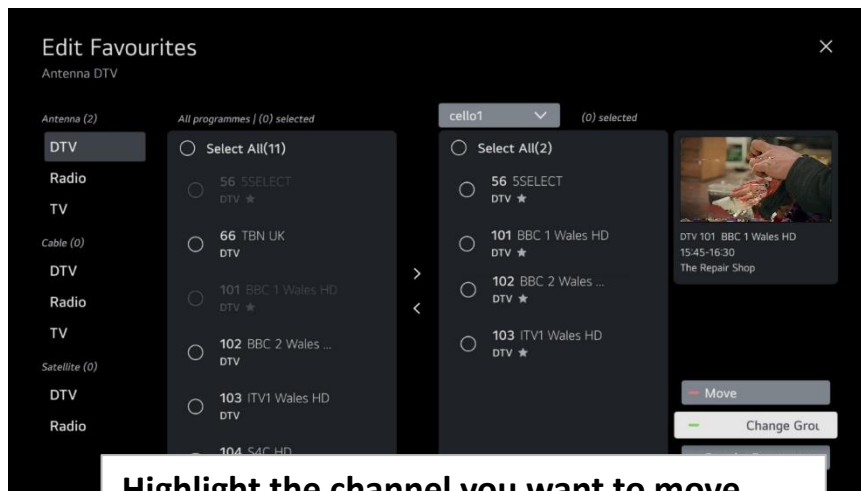

Highlight the channel you want to move and Click OK to turn the circle green

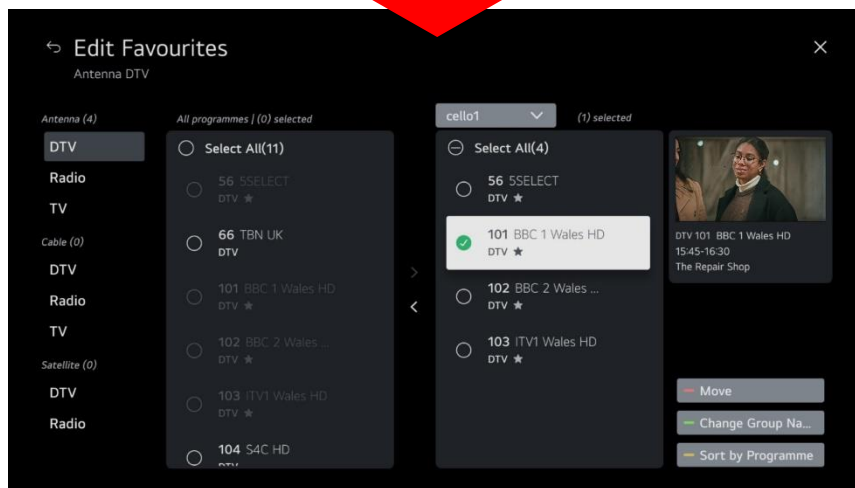

Then press the red button on the remote

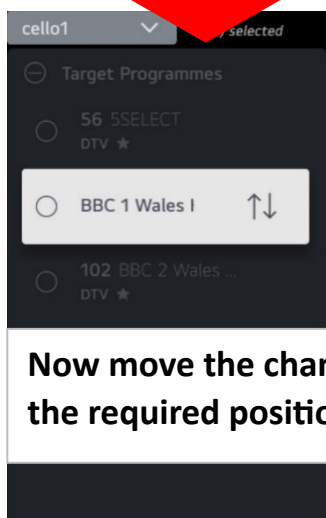

Now move the channel to the required position

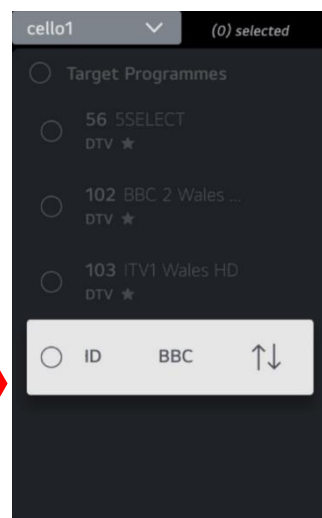

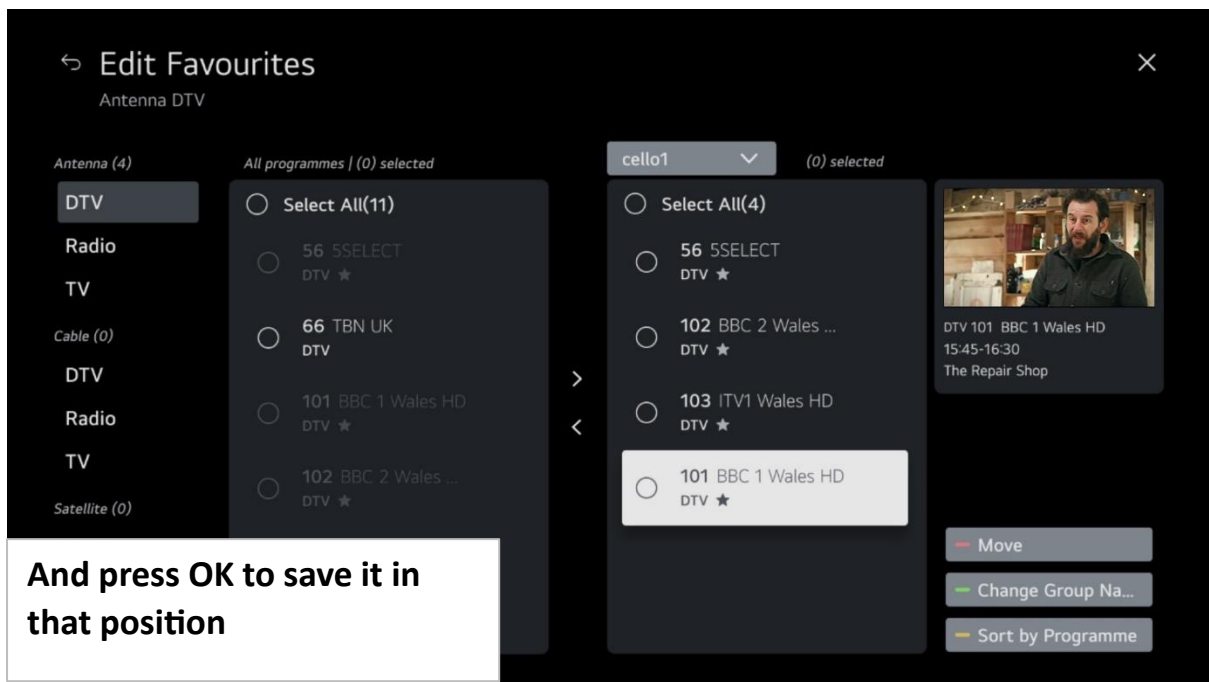

The channels will now be in that order whenever you select that Favourite List, it does not affect other Favourite Lists or the All Channel List.