



TVS 3690/3695

TV Floor Stand

Full Installation Guide

Everything you need to get your TV safely on the floor stand, in no time

Before you start

...we just wanted to say thanks for choosing Vogel's. Smart choice.

And you're already making another smart choice – reading the manual! Keep reading to learn all about safe, efficient installation, and how to use your new floor stand.

Stay safe



Warning

Always read these safety instructions carefully before installing and using this product.

Following these instructions is strictly required. Incorrect mounting and/or installation could put you, your TV, and your family at substantial risk.

Don't dare risk it... Read all

- Vogel's recommends that the mounting and/or installation of this product should be carried out by a suitably qualified expert.
- Vogel's cannot be held responsible for any injury and/or damage caused by incorrect installation.
- Please consult the manual for your TV and ensure that the weight and size of the TV is within the maximum weight and size limits specified for this product, and that the TV mounting bolts used are of a suitable length and diameter. Note that not all the TV mounting accessories provided are required for the installation of any one TV.
- Clean the product with a dry, lint-free cloth. Do not use detergents or other solvents to clean the product.

- Only qualified, certified personnel may repair the product. Use only original spare parts. The use of other parts will result in voiding the warranty, and could lead to injuries.
- Alterations to the product and technical modifications are not permitted. This will void the warranty, and could lead to injuries.
- Always store the product in a dry and safe place with a temperature between -10°C to +50°C.
- Handle and transport the product with care.
- Repack the product when transporting or not using it for a longer period of time.
- Lifting your TV is a two-person job. Don't be bold!



What's in the box?

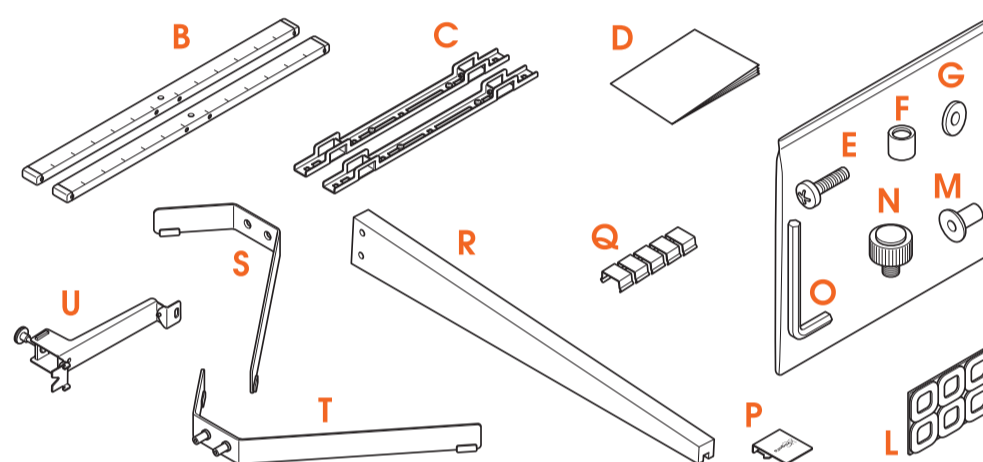

- Something missing? Make sure your packaging has everything in place:

B. Interface bars

C. Interface strips

D. Safety instructions

E. Bolts for fastening strips on TV (see contents of the TV fasteners kit)

F. Spacers

G. Washers 18mm

L. Protective TV patches

M. 2x M8*20mm bolts for attaching feet to stand

N. 2x M6*10mm thumbnuts

O. M5 (5mm) Allen key

P. Cover plate (TVS 3695)

Q. Cable clips (TVS 3695)

R. Wooden / steel stand

S. Foot (left)

T. Foot (right; with pre-attached sleeve nuts)

U. Steel bracket

- Contents of the TV fasteners kit:

- 4x M6*12mm bolts
- 4x M6*25mm bolts
- 4x M6*35mm bolts
- 4x M8*12mm bolts
- 4x M8*25mm bolts
- 4x M8*45mm bolts
- 4x M6 washer
- 4x spacer 10mm
- 4x spacer 5mm



You don't need all fasteners to mount your TV. Store the rest for later or other use!

Got your tools ready?

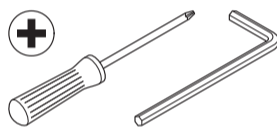

- Don't start without all the necessary tools:

- Large crosshead screwdriver
- M4 (4mm) Allen key

Take care of your safety



- Who cares about looking cool? Always wear personal protective equipment:

- Eye protection
- Ear protection
- Safety shoes



Lifting your TV is a two-person job. Don't be bold!

Ready, set, get installing!

Step 1: Attach the strips to the TV

For this step you will need:

- A large crosshead screwdriver
- 4x **Bolts** (Not sure which size you need for your TV? Then please consult our website for help.)
Ⓔ
- 2x **M6*10mm thumbnuts** Ⓓ
- 4x **Washers** Ⓖ
- 4x **Protective TV patches** Ⓖ
- 4x **Spacers** (optional; depending on your type of TV, use either the 5mm or 10mm spacers) Ⓕ
- 2x **Interface bars** Ⓑ
- 2x **Interface strips** Ⓒ
- 1x **Allen key** Ⓒ
- 1x **Steel Bracket** Ⓘ

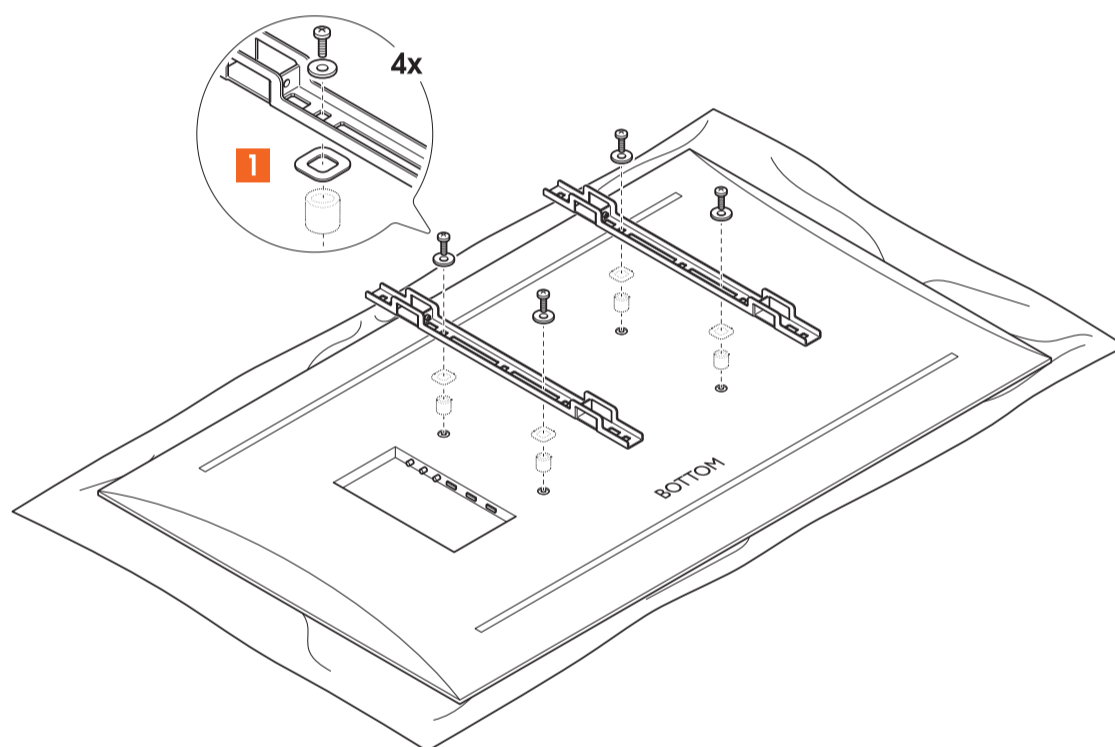

Carefully place the TV face down, on a soft clean surface without any obstacles!

1. Fix the **protective TV patches** Ⓖ onto the **interface strips** Ⓒ. Screw the **interface strips** Ⓒ onto the TV with the **bolts** Ⓔ. Make sure the **interface strips** Ⓒ are at the same height and do not stick out.



Are you missing any bolts? Or need different ones? The friendly team at Vogel's Consumer Care are waiting to help: [vogels.com/contact](http://www.vogels.com/contact) (<http://www.vogels.com/contact>).



Make sure bolts and spacers are positioned correctly.

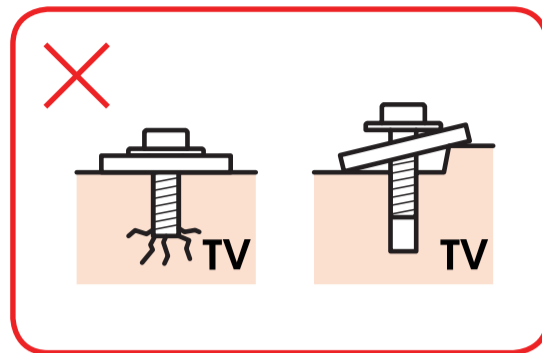
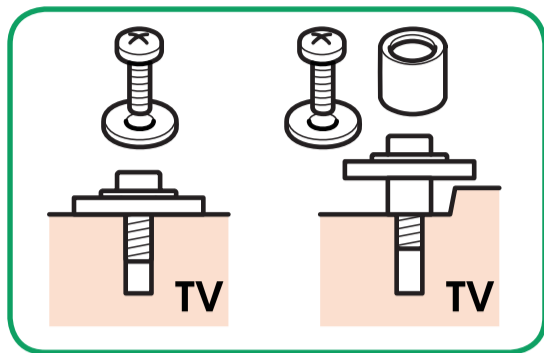

Refer to the user manual of your TV for the correct mounting material.

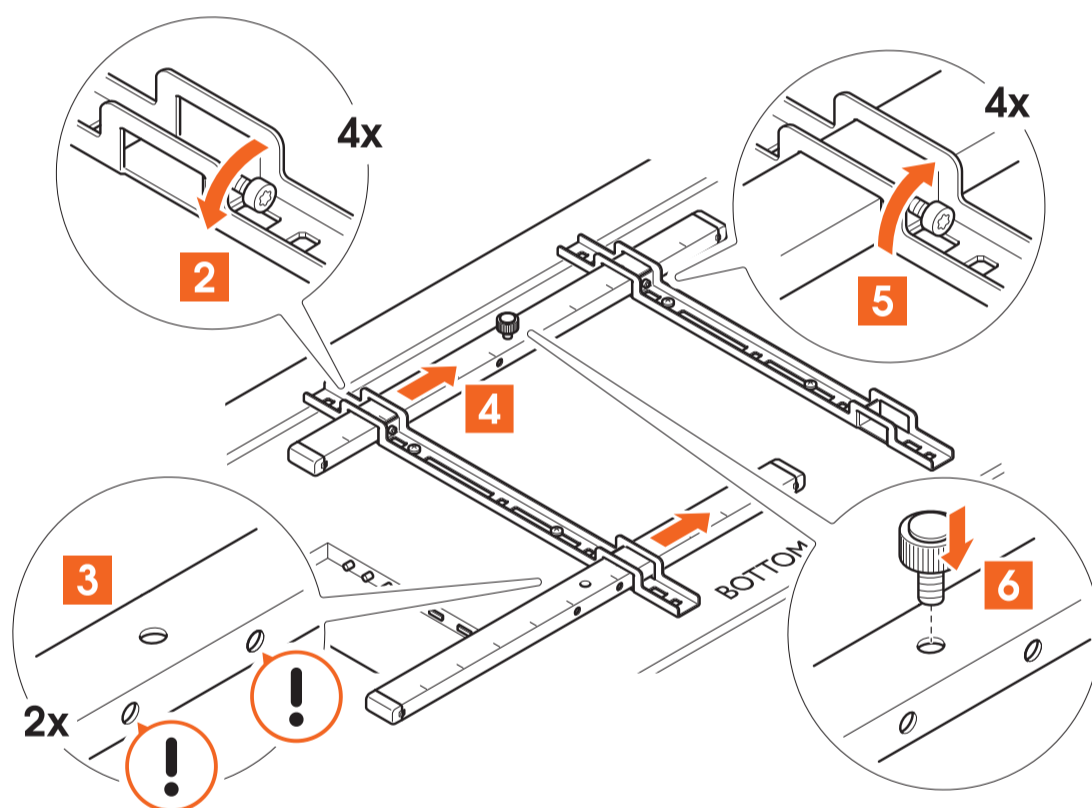

2. Loosen the **pre-attached bolts** © with the **allen key** ©.
3. Slide the lower **interface bar** ⑥ through the designated spacing of the **interface strip** ©. Make sure the **interface bar** ⑥ is placed in a centered position. Notice the holes on the side of this **interface bar** ⑥. They need to face downwards.
4. Slide the upper **interface bar** ⑥ through the designated spacing of the **interface strip** ©. Make sure this **interface bar** ⑥ is also placed in a centered position.
5. Attach the **interface bars** ⑥ to the strips by tightening the **pre-attached bolts** © with the **allen key** ©.
6. Screw the **thumbnut** ⑦ into the upper bar. Make sure you don't screw it in completely, yet.

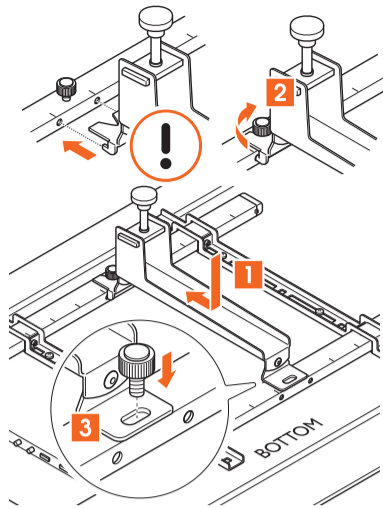

7. Slide the v-cut part of the **steel bracket** ① onto the upper **thumbnut** ②. Make sure the pins of the **steel bracket** ① slide into the holes of the upper interface bar!
8. Fasten the upper **thumbnut** ② until the **steel bracket** ① is secured.
9. Fasten the lower **thumbnut** ③ until the **steel bracket** ① is secured.

Step 2: Install the floor stand

For this step you will need:

- 1x **Wooden / steel stand** ④
- 1x **Left foot** ⑤
- 1x **Right foot** (with pre-attached bolts) ⑥
- 2x **M8*20mm bolts** ⑦
- 1x **Cover plate** ⑧
- 1x **Allen key** ⑨

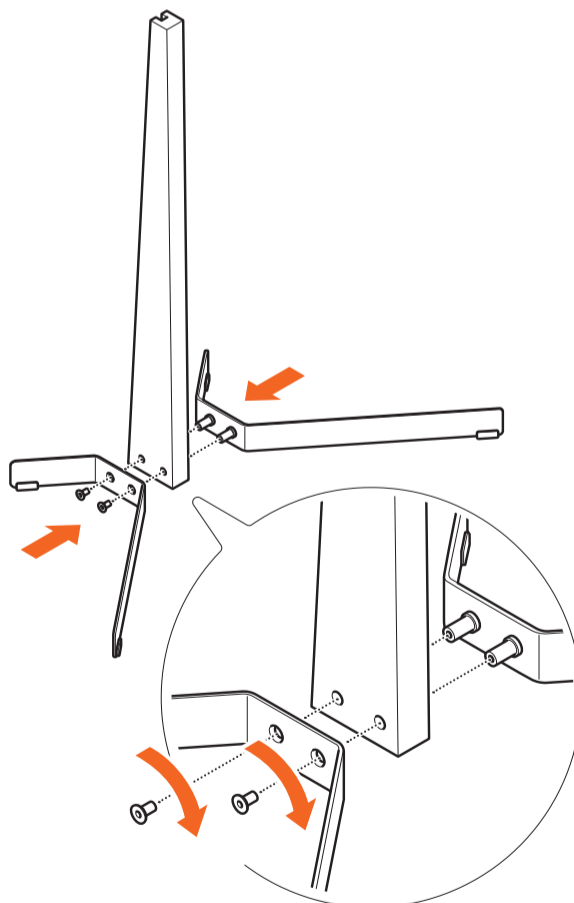

1. Slide the **right foot** (with pre-attached bolts) ⑥ into the **wooden / steel stand** ④. Make sure the longer leg is at the front of the **wooden / steel stand** ④. The back of the **wooden / steel stand** ④ includes a hidden notch for cable management.
2. Use the **allen key** ⑨ to attach the **left foot** ⑤ (without pre-attached bolts) to the **wooden / steel stand** ④ by screwing the two **M8*20mm bolts** ⑦ into the pre-attached screws of the **right foot**

Ⓣ.

Step 3: Attach the TV to the floor stand



Lifting your TV is a two-person job. Don't be bold!

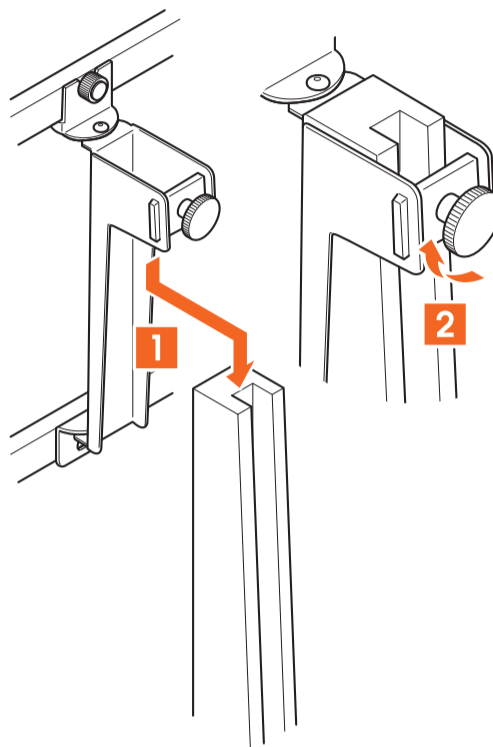

1. Slide the **steel bracket** Ⓣ over the top of the **wooden / steel stand** Ⓡ. Use the knob (see illustration) to fasten the **steel bracket** Ⓣ to the top of the **wooden / steel stand** Ⓡ.

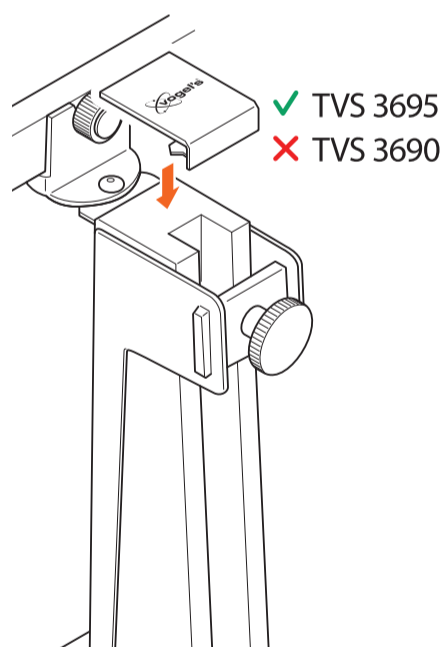

2. Apply the click-on stainless-steel **cover plate** Ⓟ on top of the **steel bracket** Ⓣ. (TVS 3695)

Job done now! Enjoy watching your TV!

Handy features

Cable management

For this step you will need:

- 5x **Cable clips** Ⓢ (TVS 3695)

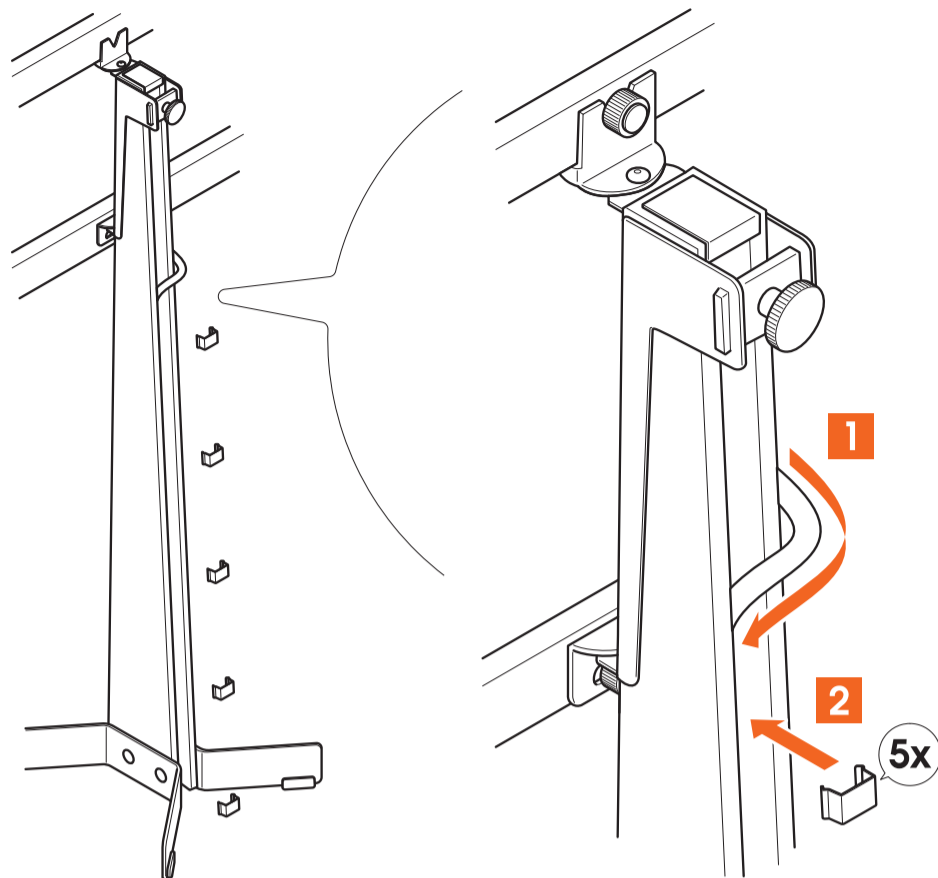

1. Carefully guide the cables through the notch on the back of the **wooden stand** ®.
2. Apply the **cable clips** © over the cables by clicking them into the notch ®, beginning at the top and working your way down.

TVS 3690

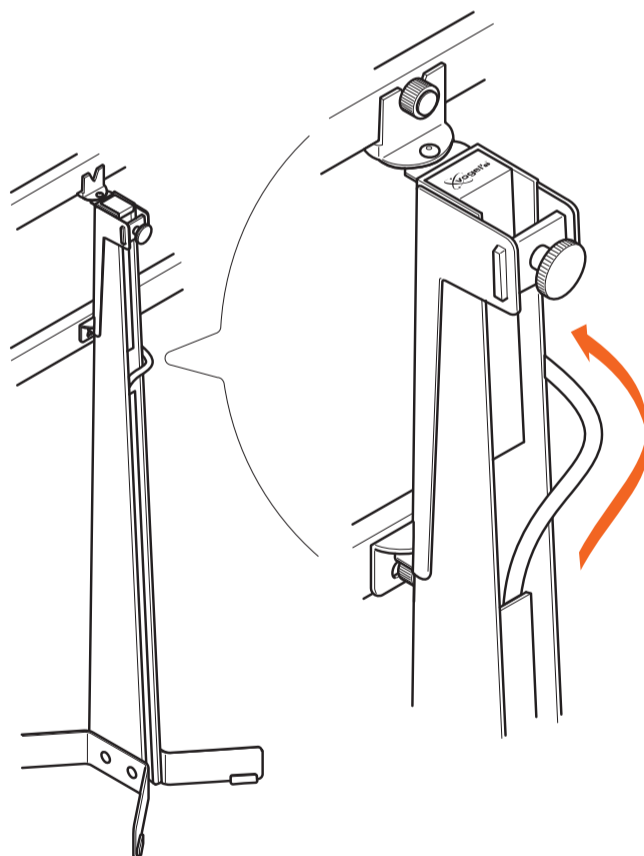

1. Carefully guide the cables through the back of the **wooden / steel stand** ®.



Having a cable mess? Do you need inspiration about how to hide and guide your cables or how to place other TV accessories? Take a look at our website [vogels.com](https://www.vogels.com/) (<https://www.vogels.com/>)!

Removing your TV

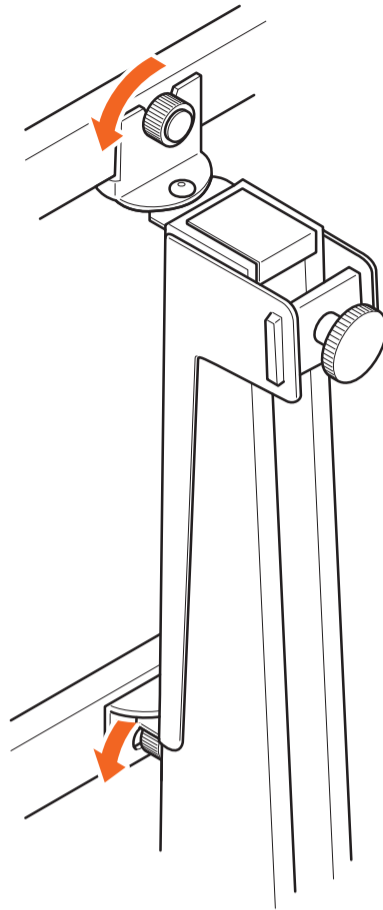

1. Unplug the cables from your TV.
2. Partially unscrew the **thumbnuts** ⓘ by turning them counterclockwise.
3. Remove the TV, and put it down somewhere safe.



Again, lifting your TV is a two-person job. Always get help.

Confused? Unsure? Going crazy?

There's plenty of help waiting for you, online:



info@vogels.com (<mailto:info@vogels.com>)
www.vogels.com/contact (<http://www.vogels.com/contact>)



[facebook.com/
VogelsForSure/](https://www.facebook.com/VogelsForSure/) (<https://www.facebook.com/VogelsForSure/>)



[instagram.com/
vogels_official/](https://www.instagram.com/vogels_official/) (https://www.instagram.com/vogels_official/)



[www.youtube.com/
c/VogelsForSure](https://www.youtube.com/c/VogelsForSure) (<https://www.youtube.com/c/VogelsForSure>).

Simple troubleshooting

Found a problem you can't fix? Don't panic... try these!

FAQs

'Where can I request the correct bolts for my TV (a service kit)?'

Whatever you need, simply contact your local Vogel's dealer or Vogel's. [Click here](http://www.vogels.com/contact) (<http://www.vogels.com/contact>) to contact Vogel's Consumer Care.

'Where can I find installation videos?'

Click or tap the button on the front page of this manual. The installation video can be found at the product page of your product on our website. It can also be found on our YouTube channel: www.youtube.com/c/VogelsForSure (<http://www.youtube.com/c/VogelsForSure>).

'What if I need spare parts?'

You can buy some spare parts on our webshop. Please visit the service kits/spare parts page from the bottom menu [on our website](https://www.vogels.com/) (<https://www.vogels.com/>) or enter the product type number in the search bar. If you require a different part or if a part is missing, please contact your local dealer or [Vogel's Consumer Care](http://www.vogels.com/contact) (<http://www.vogels.com/contact>).

'Which bolts or screws do I need to use?'

Vogel's offers a complete assembly kit with all mounting materials included in the box, for both your TV and wall. Vogel's offers a complete assembly kit with all mounting materials included in the box. Do you miss the correct bolts for your TV? Please contact your local Vogel's dealer. [Click here](http://www.vogels.com/contact) (<http://www.vogels.com/contact>) to contact Vogel's Consumer Care.

'What is VESA?'

VESA is a standard pattern of mounting location holes on the back of a TV which allows many standard TV mounts to be easily fitted to your TV.

Go green!

We care about the planet. If you're getting rid of the packaging or the TV mount itself, please check your municipality's guidelines for the best disposal options near you. For information about the materials used in the packaging, visit www.vogels.com/recycle (<https://www.vogels.com/recycle>). Recycling matters!



Guarantee

Thanks again for choosing Vogel's! Durability is paramount in the development and production of our products. We provide a guarantee of 2 years, unless local statutory law and regulation dictate a longer minimum period. We resolve any issues regarding product complaints or returned products and assess all complaints based on usage.

If your product is not functioning properly due to material faults or manufacturing defects, we will repair it free of charge or replace it at our own discretion.

If you have any problems with our product or want to know whether the guarantee is applicable, please:

1. Complete the contact form or mail our Consumer Care Team. Preferably, please add a picture.
2. Within 2 business days you will be contacted by our local Vogel's distributor.
3. If the guarantee is invoked, the product should be returned, together with the original purchase document (invoice, sales slip or cash receipt). The purchase document should clearly show the name of the supplier and the date of purchase. You will be informed about the specific return address and further procedure.

Vogel's guarantee shall lapse in the following cases:

- If the product has not been installed or used in accordance with the instructions;
- If applicable, if the holes in the wall have not been properly drilled in accordance with the Vogel's installation instructions for the applicable wall type;
- If the product has been altered or repaired by someone other than Vogel's;
- If a fault arises due to external causes (outside the product) such as for example lightning, water nuisance, fire, scuffing, exposure to extreme temperatures, weather conditions, solvents or acids, wrong use or negligence;
- If the product is used for different equipment than is mentioned on or in the packaging.

Do you have any other questions? Please make use of our contact form.
