

Loewe multi.room amp



DE Umfassendes Benutzerhandbuch
EN Comprehensive user guide
NL Uitgebreide gebruikershandleiding
FR Guide de l'utilisateur complet
IT Guida utente completa
ES Guía completa del usuario
PT Guia exaustivo do utilizador
PL Kompleksowa instrukcja obsługi
CS Kompletní uživatelská příručka
SK Komplexná používateľská príručka

LV Visaptveroša lietotāja rokasgrāmata
LT Bendrasis naudojimo vadovas
ET Üldine kasutusjuhend
DA Omfattende brugervejledning
SV Omfattande användarhandbok
FI Kattava käyttöopas
NO Detaljert bruksanvisning
HR Sažeti vodič za korisnike
SL Popoln uporabniški priročnik
RO Ghid de utilizare detaliat

EL Συνοπτικός οδηγός χρήσης
RU Общее руководство пользователя
UK Докладний посібник користувача
AR دليل الاستخدام الشامل
TR Kapsamlı kullanım kılavuzu
BG Подробно ръководство на потребителя
HU Átfogó felhasználói útmutató
SR Kompletan korisnički vodič
BS Detaljni korisnički priručnik (vodič)
KK Толук пайдаланушы нұсқаулығы

LOEWE.

Thank you

for choosing a Loewe product. We are happy to have you as a customer. At Loewe, we combine the highest standards of technology, design and user friendliness. This applies equally for TV, audio and accessories. Neither technology nor design accomplishes an end in itself, but together should facilitate the highest possible audio and visual experience for our customer.

Our design is not dictated by fleeting, fashionable trends. After all, you've invested in a high-quality piece of equipment, meant to be enjoyed not only today, but also tomorrow and for many days to come.

Content

Scope of delivery	18
Position of the rating label.....	18
1 Important safety instructions.....	19
2 Main unit components	21
3 Remote control	23
4 Wall-mounting the amplifier	24
5 Connecting the speakers	24
6 Connecting the power	25
7 Operation modes.....	25
8 Multiroom mode	25
9 Multichannel mode.....	26
10 TV mode.....	26
11 Basic Operation	27
12 Bluetooth Operation.....	28
13 USB Operation.....	28
14 Output power limiter	28
15 Spotify	28
16 Software update	28
17 Apps	29
Troubleshooting	30
Technical data	31
Disposal	32

Scope of delivery

Carefully unpack the device and make sure all accessories are present:

- Loewe multi.room amp
- Power cable (2,5m)
- HDMI cable (1,5m)
- Remote control (incl. 2 x CR2032 batteries)
- Quick start guide
- Safety instructions
- Technical data sheet

Position of the rating label

Label with model number and operating voltage can be found on the bottom of the product.

1 Important safety instructions

Attention: Read this page carefully to ensure safe operation of the device.

Follow all safety and operating instructions when using this product.

You should keep the safety and operating instructions for future reference.

You should strictly follow all warnings provided on the product and listed in the operating instructions.

Explanation of symbols



Double Insulated (Class II) Equipment. This electrical appliance has been designed in such a way that it does not require a safety connection to electrical earth (ground).



This symbol indicates risks caused by high voltages.



This symbol is to alert the user to other, more specific risks.



This symbol indicates dangers caused by the development of fire.

1.1 Installation

1.1.1 Placement

Place the unit on a stable, even surface.

Do not place this unit close to strong magnetic fields.

1.1.2 Cables

Lay the power cables so that they cannot be damaged. The power cable may not be kinked or laid over sharp edges, stood on or exposed to chemicals; the latter also applies to the system as a whole. A power cable with damaged insulation can cause electric shocks and poses a fire risk. As such, it must be changed before the unit is used again.

1.1.3 Do not use this device near water



The device should never be exposed to water droplets or water splashes, such as those found near a bathtub, wash basin, kitchen sink, washing machine, wet basement or swimming pool. Never place containers filled with liquids, such as e.g. flower vases, on the device.

1.1.4 Ventilation



Slots and openings in the housing are used to ventilate the device to ensure reliable operation of the device and to protect the device from overheating. Do not block the ventilation holes. Install the device according to the manufacturer's instructions. Never block the ventilation holes by placing the device on a bed, sofa, rug, or similar soft surfaces. This device should not be installed in a bookshelf or built-in wardrobe unless adequate ventilation is ensured.

1.1.5 Heat



Do not install the device near hot surfaces, such as radiators, fan heaters, stoves or other devices (including amplifiers) that can be hot. Never place objects with open flame, such as candles or lanterns, on or near the device. The installed batteries should not be exposed to excessive heat such as direct sunlight, fire or the like.

1.1.6 Accessories

Use only the accessories specified by the manufacturer.

1.1.7 Network connection

Please make sure that the firewall function is activated at your network access point (router). Consult your router's instruction manual.

1.2 Usage

1.2.1 Intended use

This device is intended exclusively for the reception and playback of sound signals.

1.2.2 Remote control

Exposing the remote control sensor to direct sunlight or high-frequency fluorescent light may cause malfunction. In such cases, you should move the system to a different location to avoid such malfunction.

The supplied batteries are intended for functional testing and may have a limited lifetime. If the range of the remote control decreases, replace the old batteries with new ones.

1.2.3 Overload



Never overload mains sockets, extension cords or multiple sockets, otherwise there is a risk of fire or electric shock.

1.2.4 Thunderstorm



The device should be disconnected from the mains during thunderstorms and if it is not used for a long time.

1.2.5 Penetration of foreign material and liquid



Be careful not to allow foreign material or liquid to enter this device through ventilation holes, otherwise it may come into contact with high voltage components or short circuit resulting in a fire or electric shock. Never spill liquids of any kind on this device.

1.2.6 Risks associated with high volume



The device is not designed for listening with headphones. To prevent possible hearing damage, do not listen at high volume for long periods.

1.2.7 Disconnection from power supply

The power button does not completely disconnect the power supply in any position. To completely disconnect the device from the mains, unplug the mains cable from the socket.

The mains plug must be easily accessible so that the unit can be disconnected from the mains at any time.

1.3 Maintenance

1.3.1 Device maintenance

Never attempt to carry out the maintenance of this device yourself, because live parts can be exposed through the openings or by removing covers, contacting which can be hazardous. Leave all maintenance to qualified service personnel.

1.3.2 Clean only with a dry cloth!

Unplug the mains adapter of this device from the mains socket before cleaning this product. Never use liquid cleaning detergents or cleaning sprays. Use only a damp cloth for cleaning.

1.4 Batteries



Caution! Do not ingest battery!

The remote control supplied with this product contains a coin cell battery. If the coin cell battery is swallowed, it can cause severe internal burns in just 2 hours and can lead to death.

Keep new and used batteries away from children.

If the battery compartment does not close securely, stop using the product and keep it away from children.

If you think batteries might have been swallowed or placed inside any part of the body, seek immediate medical attention.



Caution!

Risk of explosion if the batteries are replaced with the wrong type.

Do not heat or disassemble batteries. Never throw batteries into fire or water.

Do not carry or store batteries with other metallic objects. The batteries could short circuit, leak or explode.

Never recharge a battery unless it is confirmed to be a rechargeable type.

When the Remote Control is not to be used for a long time (more than a month), remove the battery from the Remote Control to prevent it from leaking.

If the batteries leak, wipe away the leakage inside the battery compartment and replace the batteries with new ones.

Do not use any batteries other than those specified.

1.6 Automatic energy saving function

The device is equipped with an automatic energy saving function. This switches the device to standby mode within 15 minutes if it is played at a very low volume or if the device is muted. Please note that the setting can't be changed.

EU Declaration of Conformity

Hereby, Loewe Technology GmbH declares that the radio equipment type Loewe multi.room amp complies with Directive 2014/53/EU. The full text of the EU declaration of conformity is available at the following Internet address: <https://www.loewe.tv/int/support>

This product can be used across all EU member states.

Due to the 5 GHz frequency range of the built-in WLAN module, use in the following countries is only permitted inside buildings:

AT	BE	BG	CZ	DK	EE	FR	DE	IS	IE	IT
EL	ES	CY	LV	LI	LT	LU	HU	MT	NL	NO
PL	PT	RO	SL	SK	TR	FI	SE	CH	UK	HR

1.5 Repair

1.5.1 Damages requiring repair

Maintenance and repair work should only be carried out by a qualified customer service. Maintenance/repair is required if the device has been damaged (e.g. the mains adapter) if liquid has entered the device, if objects have entered the device, if the device has been exposed to rain or moisture, when it stops working properly or has fallen down.

1.5.2 To minimize the risk of electric shock, fire, etc.

Do not remove screws, covers or body parts.





2 Main unit components

2.1 Front side

- 1 LED strip – changes colour depending on status or source.

LED indicator colour information

LED colour	Status or mode
<div></div> White	Standby (solid white) Booting (breathing)
<div></div> Green	HDMI ARC source or activation of eco standby mode
<div></div> Ice blue	LINE IN source
<div></div> Blue	Bluetooth mode
<div></div> Turquoise	Multichannel mode
<div></div> Orange	Play-Fi / Multiroom mode
<div></div> Yellow	USB mode / MP3 playback
<div></div> Red	Activation of multiroom sleep mode, update pro- cess, emergency mode, factory reset, unsupport- ed ARC audio format

- 2  Skip to previous track/radio station.
Long press: skip to previous input source.
- 3  Skip to next track/radio station. Long
press: skip to next input source.
- 4  Increase the volume level.
- 5  Decrease the volume level.
- 6 Play/Pause Functionality:
During Bluetooth, USB, or multiroom
mode: Play or pause the current track.
In AUX mode: Toggle between
mute and unmute.

Power Management:
While in Standby mode: A brief press will
activate the amplifier.
If the amplifier is active: Press
and hold to shut it down.

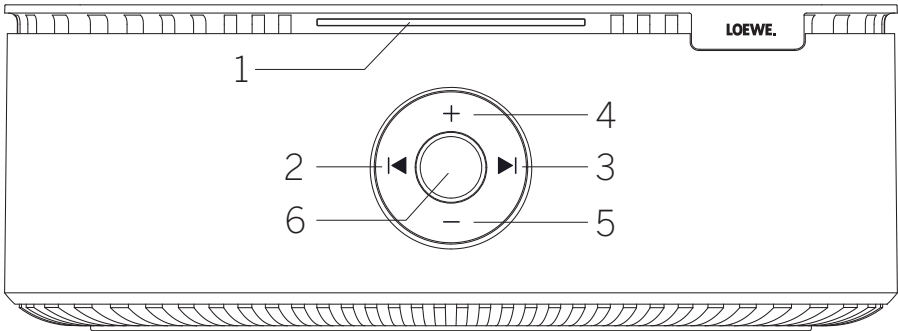

2.2 Back side

- 1 **Wi-Fi indicator** – The LED light displays the status of the Wi-Fi connection.

LED indicator state	Wi-Fi status
LED flashes quickly	Device is booting
LED slowly pulsing	Wi-Fi Access Point (AP) mode
LED flashes twice	Wi-Fi Protected Set-up (WPS) mode
LED is on	Connected / Pairing successful

- 2 **WPS (Wi-Fi Protected Setup) button** – Triggers Wi-Fi setup for Play-Fi/multiroom mode. Press and hold the button for 3 seconds until the LED flashes twice to activate the WPS mode. Furthermore, this button is required for AirPlay/Google Home setup. Refer to the "Connecting to Wi-Fi" chapter for detailed instructions.
- 3 **PAIR button** – Use this button to wirelessly pair with a Loewe soundbar.
- 4 **MONO switch** – This two-position switch determines whether the amplifier is outputting a stereo signal to the connected speakers or whether it downmixes both channels to a mono signal.
Outer position: Stereo mode active.
Inner position: Mono mode active.
- 5 **SUB switch** – This two-position switch controls the output for the left and right speakers.
Outer position: Left and right speakers receive an unfiltered signal.
Inner position: Left and right speakers receive only signal with frequencies higher than the selected crossover frequency. Activate this only if you want to remove low frequencies from the speaker outputs, for example if you have connected a subwoofer.
- 6 **SUB output** – Use this RCA output to connect an active subwoofer. This output provides a signal with frequencies below the selected crossover frequency.
- 7 **LINE OUT** – Use these connectors to connect active speakers. If you intend to use this device as a preamplifier, connect it to an amplifier using these RCA outputs.
- 8 **LINE IN** – This input is used for connecting an external audio source such as a turntable, CD player, MP3 player, or preamplifier. Use RCA cables for the connection. These inputs feature a signal detection functionality that automatically wakes up the amplifier when a sound signal is detected.
- 9 **AC IN** – Connect to the mains.

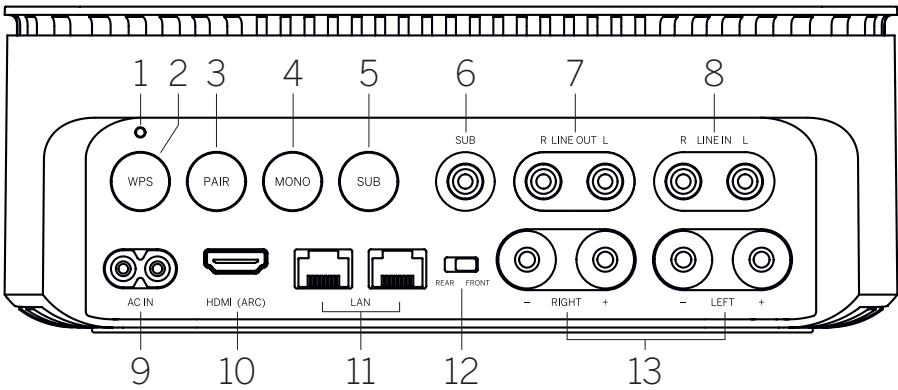

- 10 **HDMI (ARC) input** – Connect to the HDMI ARC/eARC jack on a TV. This enables you to play TV audio through external passive speakers connected to the amplifier. Please note that only PCM is supported.
- 11 **LAN terminals** – Utilize one terminal to connect this amplifier to a wired network. The other terminal can be used to provide a network connection to another device or amplifier (daisy chain).
- 12 **Multichannel switch** – The position of this switch determines the channels that will be reproduced via the amplifier speakers when used in wireless multichannel mode.
FRONT: Front left/right channel.
REAR: Surround left/right channel.
- 13 **RIGHT/LEFT speaker terminals** – Use these terminal plugs to connect your passive speakers. They are designed to be removable for easier cable fixation.

3 Remote control

The remote control is an IR remote control and requires visual contact with the amplifier to operate.

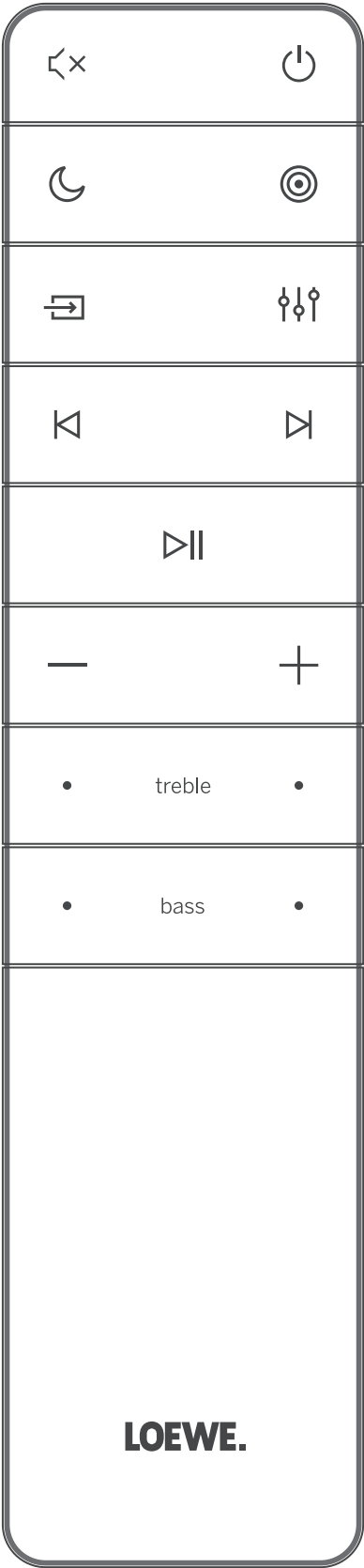

	Sound Mute / Unmute.
	Switches the amplifier on or switches to standby mode.
	Short press: Setup of the LED brightness. Long press: Setup for output power limiter.
	Long press: Enters setup for multichannel volume offset.
	Short press: Changes the input source. Long press: Activates the sub-woofer crossover frequency and subwoofer volume setup.
	Long press: Activates speaker balance setting.
	Skip to the previous audio track in USB / Bluetooth / Multiroom mode.
	Skip to the next audio track in USB / Bluetooth / Multiroom mode.
	Short press: Play/pause audio track in USB / Bluetooth / Multiroom mode. Long press: Activates Bluetooth pairing.
	Reduces the volume level.
	Increases the volume level.
treble	Adjusts the bass level.
bass	Adjusts the treble level.

First time use

The unit has a pre-installed lithium 2 x CR2032 battery. Remove the protective tape to activate the remote control battery.

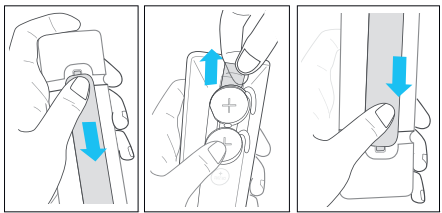

1. Press and slide the back cover to open the battery compartment of the remote control.
2. Remove the protective tape.
3. Push the battery cover back into place.

Replacing the remote control batteries

The remote control requires 2 pcs of CR2032, 3V Lithium batteries. Press and slide the back cover to open the battery compartment of the remote control.

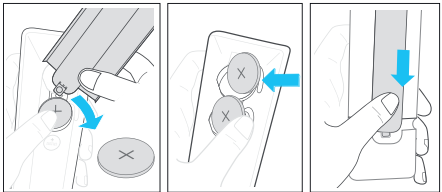

1. Use a tool (such as the battery compartment cover) to pry up the groove between the two batteries to remove the old batteries.
2. Insert the new batteries from the side and push them firmly into the original battery position. Make sure the (+) side of the battery is facing up.
3. Push the battery cover back into place.

4 Wall-mounting the amplifier

Aside from traditional placement on shelves or cabinets, you have the option to wall-mount your amplifier using the two holes located on the bottom.

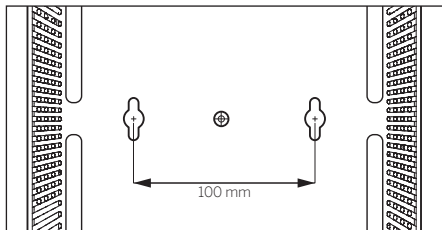

Note

- Installation must be carried out by qualified personnel only. Incorrect assembly can result in severe personal injury and property damage. It is the installer's responsibility to verify that the wall will safely support the total load of the unit and wall brackets.
- When drilling holes in walls it is essential to avoid contact with electrical cables and water or gas pipes contained within. It is highly recommended to use a good-quality live wire detector and a hidden object locator. Only proceed with drilling into structures when you are certain it is safe to do so.
- Additional tools and hardware (not included) are required for the installation.

Steps to wall-mount the amplifier:

- Choose a suitable location on the wall where you want to mount your amplifier.
- Measure and mark two points on the wall horizontally, with a distance of 10 cm between them. Use a level to make sure the marks are perfectly aligned horizontally.
- Screw the screws (not provided) directly into the wall at the marked points until they protrude by about 4 mm. If your wall is made of drywall or plaster, it may be necessary to use wall anchors or dowels to provide additional support.
- Carefully lift the amplifier and hook the holes on the bottom of the amplifier onto the protruding screws. Ensure that the amplifier is securely attached to the wall and level. Make any necessary adjustments to the screws' tightness to achieve this.

5 Connecting the speakers

You have the option to connect either passive speakers or active speakers to this amplifier. Additionally, you can also connect an active subwoofer if desired. Before proceeding with any connections, please ensure that all devices are disconnected from the power outlet for safety.

5.1 Connecting passive speakers

- Peel off about 10 mm of sheathing from the tip of the speaker cable (not provided). Afterward, twist the core wire tightly.

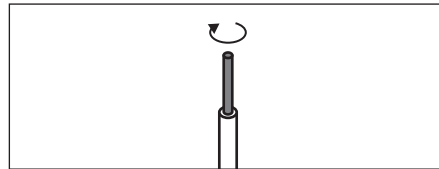

- Pull out removable speaker terminal plugs from the amplifier.

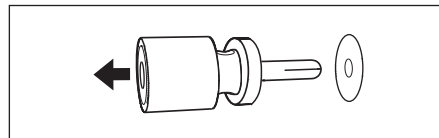

- Insert the core wire of the speaker cable into the speaker terminal hole and secure it by tightening the black cap. Be cautious to avoid any plastic insulation being inadvertently clamped by the terminal plug.

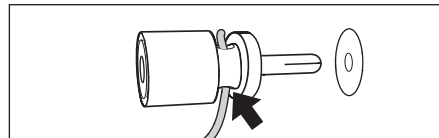

- Once the core wire is inserted, plug the speaker terminal back into the appropriate slot on the amplifier.

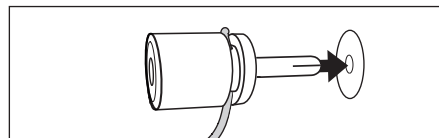

- Pay attention to the correct placement of the left and right speaker cables. Connect the left speaker to the terminals marked as "LEFT" and the right speaker to the terminals marked as "RIGHT." It is essential to match the polarity (+/-) of the speakers with the corresponding markings on the amplifier to ensure proper audio output.

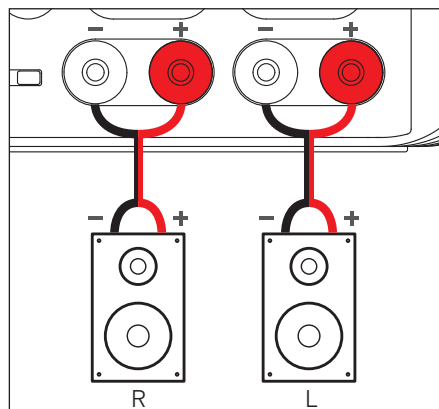

Note

- Use speakers with an impedance of 4 – 16 Ω /ohms. Do not connect speakers with impedance lower than 4 Ω /ohms!
- Make sure the core wires are securely fastened within the terminal and that no exposed wires are protruding.

5.2 Connecting active speakers

Use an RCA cable to connect the left and right active speakers to the amplifier.

- Connect left speaker to the **LINE OUT L** terminal.
- Connect right speaker to the **LINE OUT R** terminal.
- Once all the connections are made, connect the active speakers to a power outlet.

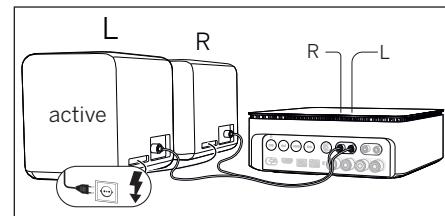

5.3 Connecting an active subwoofer

If you wish to connect a subwoofer, you will need to use an RCA cable. Please note that subwoofer will only play low-frequency signals below the selected crossover frequency (default 100 Hz) that have been extracted from the left and right channels. Since this amplifier operates with a 2.0 channel configuration, there is no separate channel dedicated solely to the subwoofer.

- Use an RCA cable to connect an active subwoofer to the **SUB** terminal on the amplifier.
- Optionally, you can press the **SUB** switch located on the back of the amplifier. When the switch is pressed, the left and right speakers will play a filtered signal with frequencies above the selected crossover frequency (default 100 Hz). If you choose not to press the **SUB** switch, the left and right speakers will play the whole frequency range.

5.3.1 Adjustment of subwoofer output level

You can adjust the output level of the subwoofer using the remote control. The default output level is 0 dB in relation to the system volume, and you can change it within a range of +/- 6 dB. The subwoofer volume will always be changed together with the system volume.



1. Press and hold the  (Source) button on the remote control.
2. The LED strip on the amplifier indicates the current volume offset of the subwoofer. The LED segments represent the volume range, with the lowest volume (-6 dB) indicated when all segments on the left side of the strip are lit and the maximum volume (+6 dB) indicated when all segments on the right side are lit. If only the middle segment is lit, the current volume offset is 0 dB.
3. Press the **+/-** buttons to adjust the subwoofer volume. Each press of the button changes volume offset by 1 dB.

5.3.2 Adjustment of subwoofer crossover frequency

You can adjust the crossover frequency of the subwoofer by using the remote control. The crossover frequency affects two things:

1. The frequency of subwoofer output. Only signals with a frequency below the selected crossover frequency will be available on the SUB terminal.
2. In the case of the **SUB** switch being pressed, speakers (passive or active) connected to the amplifier will play only frequencies above the selected crossover frequency.

To adjust the crossover frequency:

1. Press and hold the  (Source) button on the remote control.
2. Press the  button to adjust the frequency with a step of 20 Hz.
3. The LED strip on the amplifier will indicate the current crossover frequency. Depending on which LED segment is lit, a different crossover frequency is selected. Please note that only every second segment can be lit. Refer to the table below for details:

Illuminated LED position (from the left side)	Crossover frequency
1	60 Hz
3	80 Hz
5	100 Hz (default)
7	120 Hz
9	140 Hz
11	160 Hz
13	180 Hz

6 Connecting the power

Note

- Before connecting the AC power cord, ensure you have completed all other connections.

- Risk of product damage! Ensure that the power supply voltage corresponds to the voltage printed on the underside of the unit.

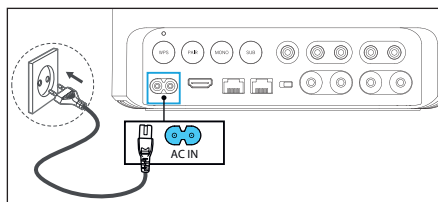

1. Connect the mains cable to the AC IN socket of the amplifier and then into a mains socket.

7 Operation modes

This amplifier offers versatile connectivity options to suit different usage scenarios. You can utilize the amplifier in the following ways:

- **Multiroom mode** – Enjoy audio playback through speakers connected to the amplifier using Spotify Connect, Chromecast, AirPlay or DTS Play-Fi app. With this mode, you can broadcast audio to multiple rooms, creating a unified and synchronized listening experience throughout your entire home.
- **Multichannel mode** – Expand the audio capabilities of a compatible soundbar by connecting it to the amplifier wirelessly. This setup allows you to utilize your passive or active speakers to create an immersive multichannel audio experience in conjunction with the soundbar.
- **TV mode** – Connect the amplifier to the TV directly via HDMI ARC. This enables you to route the audio from your TV to the amplifier and enjoy superior sound quality through external speakers.
- **Standalone mode** – You can use the amplifier as a standalone device without any specific hardware requirements. This versatile mode enables you to enjoy audio on larger speakers through various means: via Bluetooth connection from your mobile device, from a USB portable device connected to the amplifier's USB port, or by utilizing the analogue LINE IN connectors to connect external audio devices such as turntables, CD players, or MP3 players.

8 Multiroom mode

This amplifier can be used as part of multiroom speaker setup. This means that the same music can be played from your amplifier and other compatible devices simultaneously throughout your home.

To use this feature, make sure the amplifier and your smartphone / tablet are on the same network. You can use Spotify Connect, Chromecast, AirPlay or DTS Play-Fi app to control compatible multiroom speakers. You

can then play the music on multiple speakers at the same time, assign speakers to different groups, control the volume individually, or use master volume to change the volume on all speakers at the same time.

8.1 Connecting to Wi-Fi

Wi-Fi setup via WPS

If your router has Wi-Fi Protected Setup (WPS), you can set up the connection without entering a password.

1. Press and hold the **WPS** button until you hear a tone and the Wi-Fi indicator will flash twice continuously.
2. Press the WPS button on the router. The button is usually marked with the WPS logo.
3. If the setup is successful, the Wi-Fi indicator on the amplifier will change to a constant light.

Note

- WPS is not a standard feature of all routers. If your router does not have WPS, follow AirPlay or Google Home setup.
- Press the WPS button once if you want to exit the WPS mode or it will automatically exit after 2 minutes.

AirPlay setup

Use AirPlay to set up the Wi-Fi connection of iOS device (iOS7 or later) and amplifier.

1. Press and hold the **WPS** button located at the rear side of the amplifier for 8 seconds to trigger the Wi-Fi connection. Release the button when you hear a second tone from the speaker.
2. Wait until the Wi-Fi light indicator turns from a fast blink to a slow pulse. A slow pulse indicates that the speaker is entering the AirPlay setup mode.
3. On your iOS device go to **Settings > Wi-Fi > Setup new AirPlay speaker [Play-Fi device (xxxxxx)]**
4. The amplifier will be automatically recognized as AirPlay device. Tap on **[Set up new AirPlay speaker]**.
5. Tap on **[Show Other Networks...]** and select your home network to which you want the amplifier to connect.
6. Give amplifier a proper name. Press "next" to connect multiroom.amp with the selected network.
7. If the setup is successful, the Wi-Fi indicator on the amplifier will change to a constant light.

Google Home setup

1. Download the Google Home app on your mobile device.

2. iPhone/iPad only: Turn on your mobile device's Bluetooth.
3. Press and hold the WPS button located at the rear side of the amplifier for 8 seconds to trigger the Wi-Fi connection until the speaker makes a second tone, and then release the button.
4. Wait until the Wi-Fi light indicator turns from a fast blink to a slow pulse. A slow pulse indicates that the speaker is entering the Wi-Fi setup mode.
5. Open the Google Home app.
6. Follow the steps to set up your device. If you can't find the steps to set up your amplifier:
 - At the top left of the Google Home app home screen, tap **Add + > Set up device > New device**.
 - Follow the setup steps.

8.2 Connecting to LAN

To connect the amplifier to your local network with a LAN cable, follow these steps:

1. Use a LAN cable (not provided) to connect the router to one of the LAN terminals on the amplifier.
2. If DHCP is enabled on your router, the amplifier will automatically connect to your network.
3. Ensure that your mobile device is connected to the same network. You can then use AirPlay, Google Home, or the DTS Play-Fi app to search for and set up the amplifier on your mobile device.

Note

- If you have another multi.room amp, you can connect it to an unused LAN terminal on this amplifier. The network connection will be extended to the additional amplifier through this daisy-chain configuration.
- Furthermore, you can utilize an unused LAN terminal to connect other devices, such as a TV, to your network.

8.3 Mode switching

Upon initial connection to Wi-Fi or LAN, the amplifier automatically enables the "multiroom sleep mode." When this mode is active and the amplifier is turned off, it enters a state of network-connected sleep mode. This allows you to conveniently awaken the amplifier using a mobile device. However, please be aware that the "multiroom sleep mode" consumes more power compared to the "eco standby mode."

Eco standby mode is designed to minimize power consumption. In this mode, the amplifier is disconnected from the local network, and it is not possible to wake it up using a mobile device.

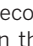
To swap between "multiroom sleep mode" and "eco standby mode", press  ->  on the remote control. Please note that the amplifier must be turned off and should not be paired with a Loewe wireless digital audiolink device in order to make this change.

When you successfully switch to "eco standby mode", the LED indicator on the front of the amplifier will blink green five times.

Likewise, when you switch to "multiroom sleep mode", the LED indicator on the front of the amplifier will blink red five times.

9 Multichannel mode

You have the option to wirelessly connect this amplifier to a compatible Loewe soundbar supporting Loewe wireless digital audiolink. This enables the soundbar to play audio from the speakers connected to the amplifier. The amplifier speakers can be configured as either the front left/right or rear left/right speakers.

List of compatible Loewe soundbars:

- klang bar3 mr
- klang bar5 mr

9.1 Pairing the amplifier with a soundbar

To connect the amplifier and soundbar via Loewe wireless digital audiolink, please follow these steps:

1. On the rear of the amplifier, set the **REAR | FRONT** switch to the desired position.
 FRONT – If you intend to use the speakers connected to this amplifier as the front pair of speakers.
 REAR – If you intend to use the speakers connected to this amplifier as the rear pair of speakers.
2. Remove the rear flap on the soundbar to access the external speaker switches.
3. On the soundbar, set the switch with the same name you selected on the amplifier (FRONT or REAR) to the **"LARGE"** position.
4. Press and hold the **PAIRING** button on the amplifier for 3 seconds. The LED on the front of the amplifier will start pulsing in turquoise colour, indicating that the amplifier is in multichannel pairing mode.
5. Press and hold the **PAIRING** button on the soundbar.
6. After successful pairing, "P-OK" will appear on the display of the soundbar. Additionally, the LED on the amplifier will stop pulsing and remain solid in a turquoise colour.

Once the pairing is complete, the speakers connected to the amplifier will play the sound from the soundbar. Please note that the vol-

ume control will be handled exclusively by the soundbar.



If you pair the amplifier to a Loewe wireless digital audiolink source after a factory reset, the multiroom functionality is switched off to save energy since the amplifier receives its content through the soundbar. If you want to use the amplifier with any multiroom protocol, such as AirPlay, please pair Wi-Fi first and Loewe wireless digital audiolink afterwards.

9.2 Volume offset

If you encounter volume level discrepancies between the speakers connected to the amplifier and the soundbar, you can adjust the volume offset for the amplifier speakers to achieve a balanced sound output. Follow these steps to adjust the volume offset:

1. Press and hold the  (Surround) button on the remote control.
2. The LED strip on the amplifier indicates the current volume offset. The LED segments represent the volume range, with the lowest offset (-12dB) indicated by a single segment being lit and the maximum offset (+12dB) indicated by all segments being lit.
3. Press the **+/-** buttons to adjust the volume offset.

10 TV mode

If you wish to connect two external speakers to your TV, you can easily do so with the amplifier. Before you make or change any connections, make sure that all devices are disconnected from the power outlet.

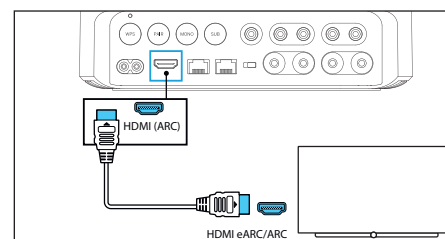

Follow these steps to set up the TV mode:

1. On your TV, turn on HDMI-CEC operations.
2. Using an HDMI cable (included), connect the HDMI ARC connector on your amplifier to the HDMI ARC or eARC connector on the TV.
3. When you power on the TV, the multi.room amp will automatically wake up and switch to the HDMI source. You will see a green LED light on the front of the amplifier indicating that it is receiving the HDMI signal.

When HDMI ARC connection is properly set up, you can enjoy these features:

- The amplifier turns on automatically when you turn on the TV.
- The amplifier turns off automatically when you turn off the TV.
- You can mute/unmute or adjust the volume of the amplifier using the TV remote control.

Note

- Your TV must support the HDMI-CEC and ARC function. HDMI-CEC and ARC must be set to On.
- The setting method of HDMI-CEC and ARC may differ depending on the TV. For details about ARC function, please refer to your TV operating instructions.
- If you have correctly connected all the devices, enabled HDMI-CEC and HDMI ARC, but you are still not receiving sound, you may need to change the Digital Output settings in your TV menu to PCM. If a different sound format like Dolby or DTS is accidentally sent to the amp, it will flash in red to indicate that the audio format is not supported.

11 Basic Operation



11.1 Turn ON and OFF

When you initially connect the unit to the mains socket, it will be in standby mode.

To power on the amplifier, simply press the middle button on the amplifier or the  (Standby) button on the remote control.

To power off the amplifier, press and hold the middle button on the amplifier or the  (Standby) button on the remote control.

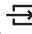
11.2 Source selection

Press the  (Source) button on the remote to cycle through the inputs. Alternatively, you can press and hold the  or  on the amplifier to cycle through the available sources.

11.3 Volume control

To adjust the volume level, use the **+/-** (Volume) buttons on either the amplifier or the remote control. Press the **+** button to increase the volume and the **-** button to decrease it. As you adjust the volume, the volume level will be indicated by the number of illuminated LEDs on the LED strip of the amplifier.

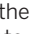
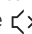
To mute the sound, press the  (Mute) on the remote control. To restore the sound, press the  (Mute) again or press **+** (Volume).

11.4 Play/Pause

To toggle between play and pause of the track, press the middle button on the ampli-

fier. However, please note that if the current source does not support play/pause functionality, the sound button on the amplifier will instead mute or unmute the sound. Alternatively, you can use the  (play/pause) button on the remote control to control playback.

11.5 Playback control

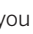
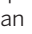
To skip to the previous or next track or radio station, you can use the  or  buttons on either the amplifier or the remote control. Please keep in mind that if these buttons are not illuminated on the amplifier, it indicates that the current source does not support skipping to the next or previous title.

11.6 Equalizer (bass/treble)

Press the **bass +/-** buttons on the remote control to adjust bass level (-6 dB ~ +6 dB).

Press the **treble +/-** buttons on the remote control to adjust treble level (-6 dB ~ +6 dB).

As you make adjustments to the bass and treble, you can see the indication of gain on the front side of the amplifier. The LED strip on the amplifier will show the gain level. When a single LED in the middle is illuminated, it corresponds to 0 dB gain. Increasing the bass or treble level above 0 dB will illuminate more LEDs on the right side of the LED strip. Conversely, decreasing the gain below 0 dB will illuminate additional LEDs on the left side of the LED strip.

11.7 Balance

If the speakers connected to the amplifier are positioned unevenly, you can adjust the balance to ensure an optimal listening experience. Balancing the speakers allows you to decrease the volume of the speaker that is closer to the listening position and increase the volume of the speaker that is further away. To adjust the balance settings, follow these steps:

1. Press and hold the  button on the remote control to access the balance settings.
2. Press the **+/-** buttons to adjust the balance between the speakers.

The LED strip on the amplifier indicates the current balance. When a single LED in the middle is illuminated, it corresponds to an even balance between the speakers. As the LED travels to the right, the volume of the left speaker decreases. Similarly, as the LED travels to the left, the volume of the right speaker decreases. The further the LED travels, the greater the difference in volume between the speakers.

11.8 Dual mono switch

The Dual Mono switch allows you to configure multi.room amp to function either as a

stereo device (with separate left and right channels) or as a dual mono device (with the same mono signal played on both connected speakers).

The switch is located on the back of the amplifier and is labelled "MONO". When the switch is pressed (in the inner position), the dual mono feature is active, and both speakers will play the same mono signal. This option is particularly useful for settings like restaurants or hotel lobbies. On the other hand, when the button is not pressed (in the outer position), the speakers will receive a stereo signal.

11.9 "SUB" switch

The SUB switch allows you to configure the multi.room amp to filter the frequencies played through the left and right speakers. The switch is located on the back of the amplifier and is labelled "SUB". When the switch is pressed (in the inner position), the left and right speakers will play a filtered signal with frequencies above the selected crossover frequency. On the other hand, when the button is not pressed (in the outer position), the left and right speakers will play the full frequency spectrum. Regardless of the switch position, the sub channel output will always play everything below the selected crossover frequency, ensuring consistent low-frequency performance.

11.10 Adjusting the LED indicator brightness

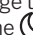
To change the brightness of the LED indicator, press the  button. Each press will cycle the brightness through different levels: [100%], [50%], [30%], [10%], [10%+switch off]. When you choose the last option, if there's no interaction with the button for 3 seconds, the LED will turn off completely. If any interaction occurs during this 3-second interval, the light will stay on for an additional 3 seconds, allowing for further adjustments.

11.11 Factory Reset

Performing a factory reset will restore the device to its default settings. It is necessary to do this before disposing of, gifting, or selling the device to ensure that your personal information and settings are removed.

To initiate the factory reset, press and hold the WPS and PAIRING buttons simultaneously for 3 seconds. The device will begin the factory reset process. During a factory reset, the LED will pulse red and a tone will play from the speakers. After the reset is complete, the device will automatically reboot.

11.12 Checking the Software Version

1. Put the device into standby mode.

- Press **bass+** ->  -> **treble+** on the remote control.
- The centre LED of the LED strip will begin displaying different colours to indicate various software types:
 - A turquoise light signifies the MCU software version.
 - A yellow light signifies the sound software version.
 - A blue light signifies the Bluetooth software version.
 - A red light signifies the wireless software version.
- The LEDs to the left and right of the centre LED will indicate the version number of the software.
 - The LED on the left of the centre LED represents the whole number part of the software version.
 - The LED on the right of the centre LED represents the decimal place of the software version.
- The version number is indicated by how many times these LEDs flash.

For Example:

If the centre LED displays turquoise colour, and then the left LED flashes 8 times, followed by the right LED flashing 6 times, it signifies:



- Cyan colour represents the MCU version.
- Left LED flashing 8 times represents the whole number, which is 8.
- Right LED flashing 6 times represents the decimal place, which is 6.



This indicates that the MCU software version is 8.6.

After displaying all the software versions, the device will automatically return to standby mode.

12 Bluetooth Operation

Connect the amplifier to a Bluetooth device (such as an iPad, iPhone, iPod touch, Android phone, or laptop) via Bluetooth, and then you can listen to audio files stored on the device through the connected speakers.

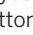
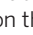
- Press the  (Source) button on the remote repeatedly until Bluetooth mode is selected. The front LED of the amplifier will turn blue to indicate Bluetooth mode.
- If no Bluetooth devices are currently paired with the amplifier, it will automatically enter Bluetooth pairing mode.
- If you want to pair an additional Bluetooth device, press and hold the  button.
- Bluetooth pairing mode is indicated by a flashing blue LED on the front of the amplifier.



- Enable Bluetooth on your smartphone, search for "multi.room amp," and select it to establish a Bluetooth connection. Refer to the user guide of your Bluetooth device for instructions on enabling Bluetooth.
- Once connected, play audio files or music on your Bluetooth device. Use the  /  buttons on the remote control to skip tracks, and press  to pause or resume playback.
- To exit Bluetooth, select another source. When you switch back to Bluetooth mode, the amplifier will automatically reconnect to any previously paired devices within range.

Note

- The amplifier remembers all paired devices. To delete paired devices, perform a factory reset.
- The maximum operating range between the amplifier and a Bluetooth device is approximately 10 meters, but this may vary depending on the phone model and environmental circumstances.
- Compatibility with all Bluetooth devices is not guaranteed.

13 USB Operation

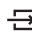
To play audio files from a USB drive, follow these steps:

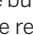
- Insert the USB drive into the USB port located on the side of the amplifier.
- Press the  (Source) button on the remote repeatedly until USB mode is selected. The front LED of the amplifier will turn yellow to indicate USB mode.
- Use the playback buttons  to skip to the previous track and  to skip to the next track.
- Press the middle button on the amplifier or  button on the remote to start or pause playback of the current track.

Note

- This product may not be compatible with certain types of USB storage devices.
- If you use a USB extension cable, USB hub or USB multifunctional card reader, the USB storage device may not be recognized.
- Do not remove the USB storage device while files are being read.
- This unit can only play MP3 audio files.

14 Output power limiter

To ensure safe operation of small passive speakers according to their power capabilities, it is advisable to limit the output power on the speaker terminals. This can be done using the power limiter feature provided by

the amplifier.

To set up the power limit, follow these steps:

- Press and hold the  (night mode) button on the remote control to enter power limiter setup.
- The LED strip on the amplifier indicates the current power limit. Each LED segment represents a step in the power limit range, with the lowest limit indicated by a single segment being lit and the maximum limit indicated by all segments being lit. Default value is 300W for 4Ω speakers and 150W for 8Ω speakers.
 - When no LED is lit, power is turned off for the outputs for passive speakers. This is recommended to set when you connect only active speakers via the LINE OUT output, as it decreases the power consumption of the amplifier.
- Use the **+/−** buttons to adjust the power limit.

Explanation for power limit based on the number of illuminated LEDs:

Number of illuminated LEDs	Maximum output power @ 4Ω	Maximum output power @ 8Ω
0	off	off
1	12.5W	6.25W
2	25W	12.5W
3	50W	25W
4	75W	38W
5	100W	50W
6	125W	63W
7	150W	75W
8	175W	86W
9	200W	100W
10	225W	112W
11	250W	125W
12	275W	138W
13	300W	150W

15 Spotify

Use your phone, tablet or computer as a remote control for Spotify. Go to spotify.com/ connect to learn how.

The Spotify Software is subject to third party licenses found here:

www.spotify.com/connect/third-party-licenses

16 Software update

To upgrade amplifier firmware:

- Download the latest software from the website www.loewe.de.

2. Extract the file to the USB root folder. Ensure that the USB drive is formatted using the FAT32 file system.
3. Connect the USB drive to the amplifier while it is powered on.
4. On the amplifier, switch to the USB source.
5. The installation process will start automatically, which will be indicated by LEDs flashing in different colours.
6. Once the installation is finished, the amplifier will automatically switch to standby.

To upgrade the multiroom function of your amplifier:

1. Download and install the DTS Play-Fi app on your mobile device.
2. Connect the amplifier and your mobile device to the same network.
3. If new Play-Fi software is available, the application notifies you.
4. Follow the instructions in the application to run the multi-room feature update.

Warning: It may take a few minutes for the software to update. Do not unplug your amplifier, turn off the device, or disconnect the USB stick or network during the update. These actions can potentially destroy your amplifier. Additionally, avoid switching off the app on your phone and patiently keep the Play-Fi progress screen open until the update is finished.

17 Apps

Scan the QR code below with your phone and download the recommended app.



The "my Loewe" app is an entry point to the Loewe world and gives you access to all user manuals for your Loewe products.

Troubleshooting

In the event of a device failure, we recommend that you check the list below before calling the helpline.

Problem	Possible cause	Remedy/notes
The system does not respond to any button press.	A software error may have caused the device to stop receiving commands from the buttons, and the device must be restarted by unplugging it.	Unplug the unit from the power supply for a few minutes, then plug it in again.
No sound.	<ul style="list-style-type: none"> a. Sound is muted b. Volume is decreased to minimum. c. Wrong source is selected. d. Source is paused. e. Bluetooth is not paired 	<ul style="list-style-type: none"> a. Press the mute button on the remote. b. Adjust the volume to the correct level. c. Make sure the desired source is selected. d. Press the play button on the remote. e. Pair the device with the amplifier before listening.
Amplifier is not visible during Bluetooth pairing.	Amplifier is not in Bluetooth pairing mode.	Change the amplifier source to Bluetooth mode and enter pairing by pressing and holding play/pause button. Wait a few seconds for the amplifier to appear on your phone.
The audio playback quality of the connected Bluetooth device is poor.	Bluetooth reception is poor.	Move the device closer to the amplifier or remove obstacles between the device and the amplifier.
Wi-Fi connection cannot be established.	<ul style="list-style-type: none"> a. Wi-Fi network may be unavailable. b. Wi-Fi signal is very weak. 	<ul style="list-style-type: none"> a. Check the availability of WLAN network on the router. b. Place the Wi-Fi router closer to the unit or use an Ethernet cable.
Cannot discover the amplifier from the app.	<ul style="list-style-type: none"> a. The amplifier may not be in multiroom mode. b. Device may be disconnected from Wi-Fi. 	<ul style="list-style-type: none"> a. Enable Multiroom Mode of the amplifier by connecting it to a network. b. Make sure the device is connected to the Wi-Fi.
No sound from the TV.	The amplifier is receiving encoded audio from the TV, such as Dolby Digital or DTS.	Switch the TV's Digital Audio Output to the "PCM" sound format.
The amplifier indicator is blinking red.	<ul style="list-style-type: none"> a. The amplifier is receiving the wrong audio format via HDMI. b. The amplifier is overheating and has switched off for protection. c. The speaker terminals were shorted, causing the amp to switch off. d. The impedance of the connected speakers is too low. 	<ul style="list-style-type: none"> a. Switch the TV's Digital Audio Output to the "PCM" sound format. b. Allow the amplifier to cool down for a period and then restart it. c. Check the cabling and eliminate any short circuits and restart the amplifier. d. Connect speakers with an impedance of > 4 ohms and restart the amplifier.
The amplifier's volume is gradually decreasing over time.	The amplifier is protecting itself from potential damage caused by excessive power usage.	Place the amplifier in a cooler environment and reduce the volume to a lower level.

Disposal

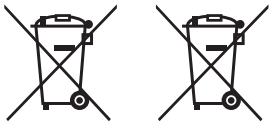

Disposal of used electrical and electronic equipment and batteries.

The crossed-out wheeled bin symbol on the product or its packaging indicates that this product must not be treated as normal household waste, but must be returned to a collection point for the recycling of electrical and electronic equipment and batteries. By helping to properly dispose of this product, you are protecting the environment and the health of your fellow human beings. Improper or incorrect disposal endangers the environment and health. For more information about the recycling of this product, please contact your local authority or your municipal waste disposal service. Attention: The "Pb" sign under the battery symbol indicates that this battery contains lead.

