

Q

SCIMITAR ELITE WIRELESS

MMO Gaming Mouse
QUICK START GUIDE



IN THIS GUIDE

- GETTING TO KNOW YOUR MOUSE
- CHARGING THE MOUSE
- SETTING UP 2.4GHZ SLIPSTREAM WIRELESS
- SETTING UP BLUETOOTH
- ADJUSTING THE KEY SLIDER
- ONBOARD PROFILES
- MOUSE STATUS, DPI SETTINGS, AND INDICATIONS
- BATTERY REMOVAL INFORMATION
- COPYRIGHT / LEGAL INFORMATION

GETTING TO KNOW YOUR MOUSE

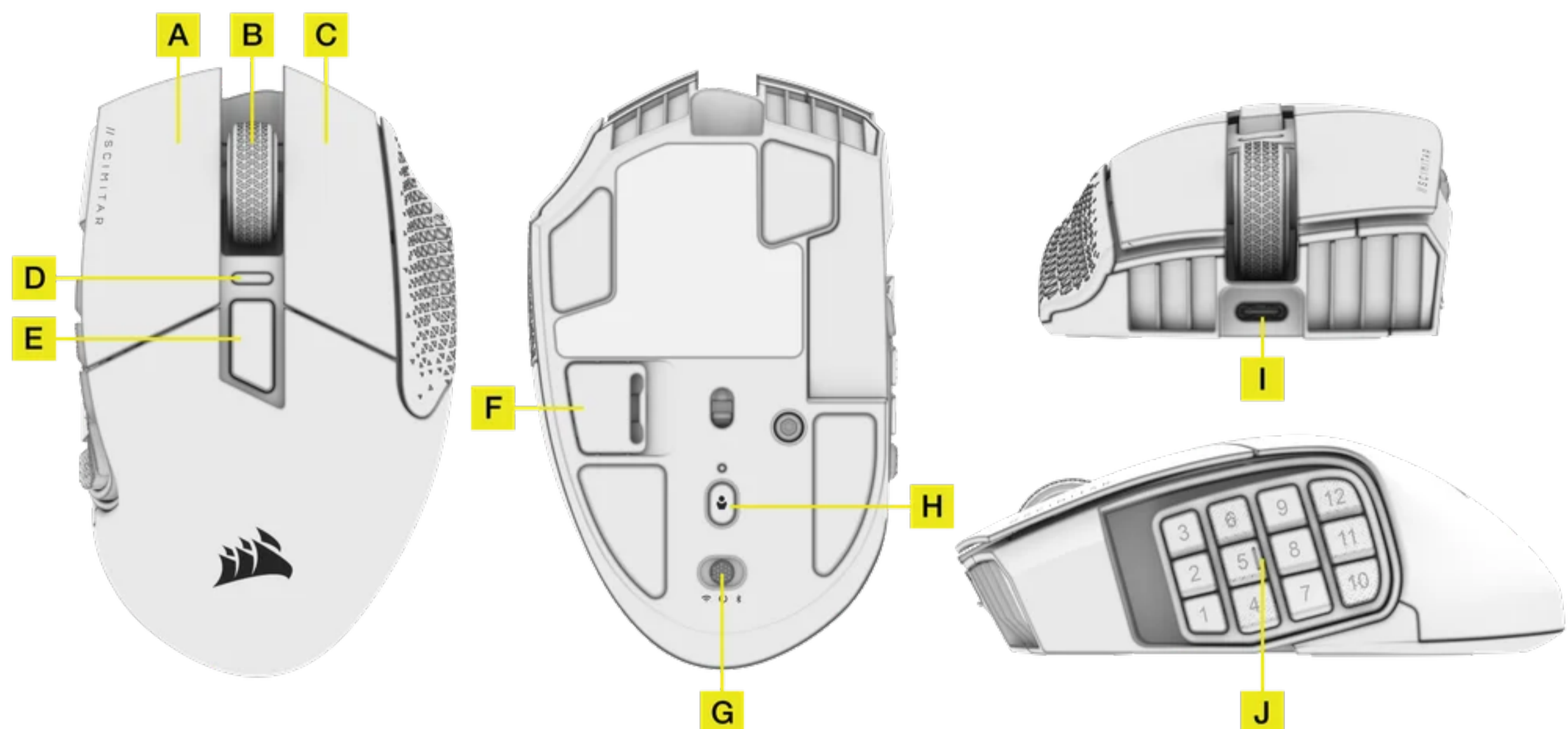

- A. LEFT CLICK BUTTON

B. MIDDLE CLICK BUTTON

C. RIGHT CLICK BUTTON

D. MULTI-PURPOSE LED INDICATOR

E. DPI TOGGLE BUTTON
- F. USB RECEIVER STORAGE

G. POWER / WIRELESS MODE SWITCH

H. PROFILE BUTTON

I. USB CHARGING / DATA PORT

J. PATENTED KEY SLIDER

CHARGING THE MOUSE

IMPORTANT: The SCIMITAR ELITE WIRELESS mouse must be fully charged before its first use.

Connect the mouse to an available USB 2.0 or 3.0 port on your PC via the USB CHARGING / DATA PORT (I).

The MULTI-PURPOSE LED INDICATOR (D) on the mouse will begin pulsing green to denote battery charging and will turn solid when charging is complete.

SETTING UP 2.4GHZ SLIPSTREAM WIRELESS

Hyper-fast sub-1ms wireless connection is designed for no-compromise gaming grade performance.

- Toggle the POWER / WIRELESS MODE SWITCH (G) to "2.4GHz" position to turn on your mouse.
- Connect the USB WIRELESS RECEIVER to an available USB 2.0 or 3.x port located on the front panel of your PC or nearby USB port. (e.g. on CORSAIR MM700, MM800, MM1000 mousepads).
- The MULTI-PURPOSE LED INDICATOR (D) will turn solid white when connected.
- Download the iCUE software from www.corsair.com/downloads.
- Run the installer program and follow instructions for installation.

If reconnection is required, initiate USB wireless receiver pairing via the iCUE software settings menu.



SETTING UP BLUETOOTH

Bluetooth wireless is best for everyday computing tasks, productivity, and office applications.

- Initiate Bluetooth pairing on your Bluetooth 4.0 or higher enabled device.
- Press and hold DPI TOGGLE BUTTON (E).
- Toggle POWER / WIRELESS MODE SWITCH (G) to "BT" position to turn on your mouse.
- Follow the instructions provided to successfully connect your device.

The MULTI-PURPOSE LED INDICATOR (D) will turn solid blue when connected.



ADJUSTING THE KEY SLIDER

The patented Key Slider™ control system lets you reposition the 12 side buttons to comfortably fit your grip. To adjust the keypad slider, please follow the steps below:

- Insert the included Allen key into the keypad slider lock located at the bottom of the mouse and turn it counterclockwise to unlock the keypad.
- Move keypad to desired position and turn the Allen key clockwise to lock the keypad.

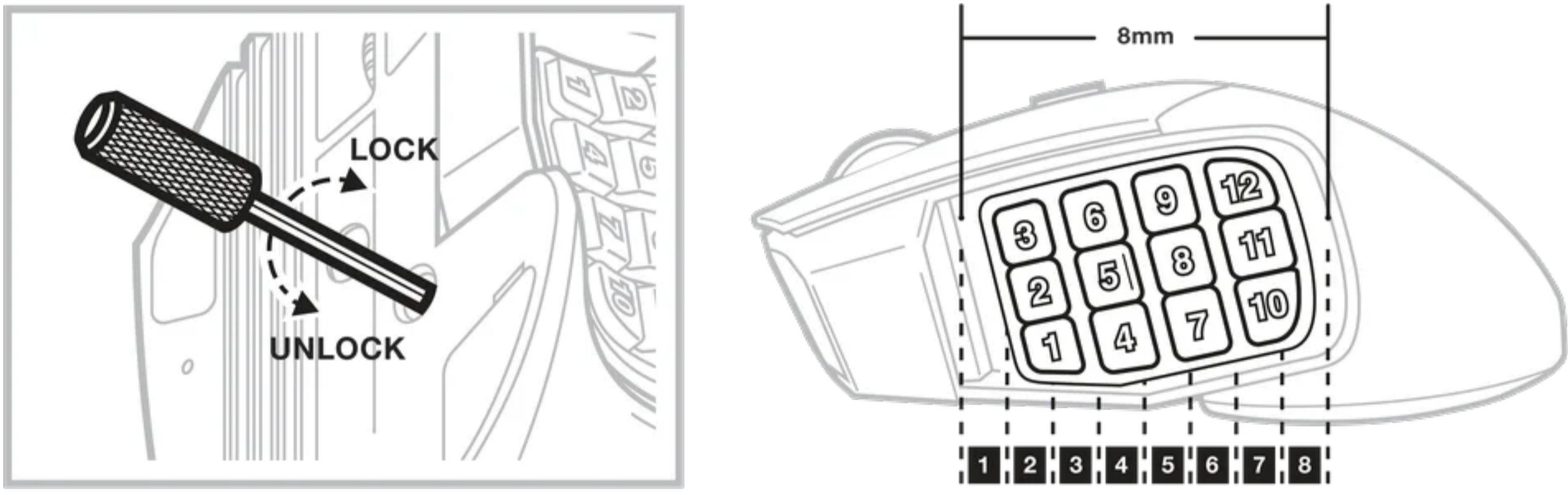

ONBOARD PROFILES

Three onboard profile slots hold predefined DPI settings, button assignments, and lighting effects. They can be cycled through by pressing the PROFILE BUTTON (H) located on the bottom of the mouse. You will know which profile you are on by the color indicated directly above the PROFILE BUTTON (H). All those settings can be fully customized using iCUE software and stored back in onboard memory.

	PROFILE #1 (RED)	PROFILE #2 (GREEN)	PROFILE #3 (BLUE)
BUTTON 1	1	1	1
BUTTON 2	2	2	2
BUTTON 3	3	3	3
BUTTON 4	4	4	4
BUTTON 5	5	5	5
BUTTON 6	6	6	6
BUTTON 7	7	7	7
BUTTON 8	8	8	8
BUTTON 9	9	9	9
BUTTON 10	0	0	0
BUTTON 11	-	-	-
BUTTON 12	=	=	=

MOUSE STATUS, DPI SETTINGS, AND INDICATIONS

Wireless connection and battery status are communicated through the MULTI-PURPOSE LED INDICATOR (D). The mouse comes preloaded with common competitive DPI settings which can be cycled through by pressing the DPI TOGGLE BUTTON (E) with the MULTI-PURPOSE LED INDICATOR (D) backlighting to reflect the current stage.

Battery Status	Multi-Purpose LED Indicator
Battery charging	Pulsing Green
Battery critical, recharge required	Pulsing Red
Battery low, recharge soon	Blinking Red
Battery medium	Blinking Amber
Battery high	Blinking Green
Battery charged	Green

Wireless Status	Multi-Purpose LED Indicator
2.4GHz wireless mode – pairing	Blinking White
2.4GHz wireless mode – paired	White
2.4GHz wireless mode – pairing failed	Pulsing White
BT wireless mode – pairing	Blinking Blue
BT wireless mode – paired	Blue
BT wireless mode – pairing failed	Pulsing Blue

Profile	Red	Green	Blue
Stage 1 (Red)	400	400	800
Stage 2 (White)	800	800	1500
Stage 3 (Green)	1200	1500	3000
Stage 4 (Purple)	1600	3000	6000
Stage 5 (Capri)	3200	6000	9000

BATTERY REMOVAL INFORMATION

This product uses a rechargeable battery and safety guidelines must be followed in the event that the product is disabled for disposal and recycling. To safely remove the battery for disposal and recycling, follow the numbered steps with the below diagrams.

CORSAIR MEMORY, Inc. encourages customers to recycle used electronic hardware and rechargeable batteries in accordance with local laws and regulations.

- Remove Teflon Feet (x4 Pieces)
- Remove x4 Screws
- Remove Top Cover Assembly then unplug Connector "A" and "B"
- Unplug Battery Connector "C"
- Remove Battery

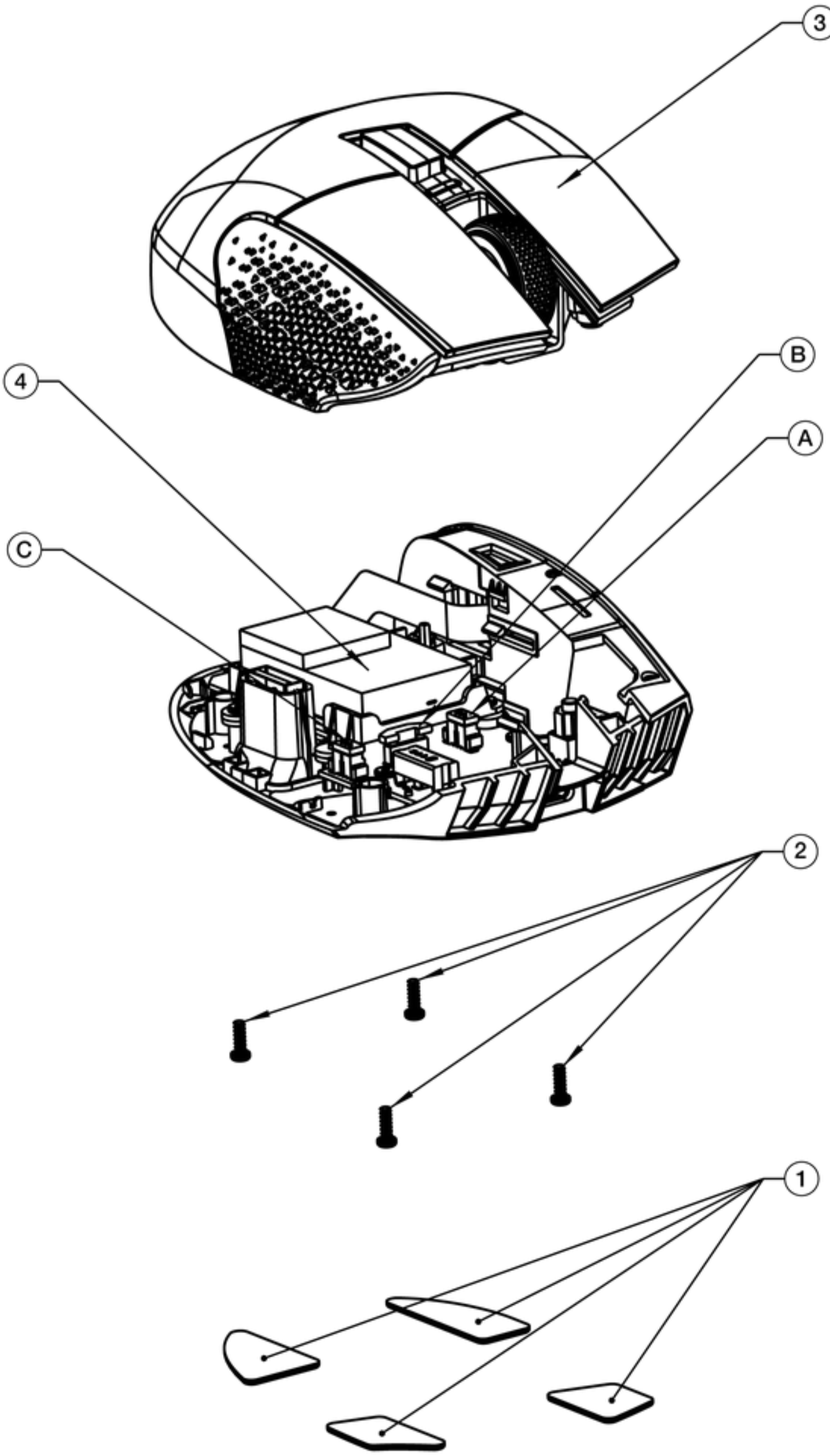

COPYRIGHT / LEGAL INFORMATION

© 2023 CORSAIR MEMORY, Inc. All rights reserved. CORSAIR and the sails logo are registered trademarks of CORSAIR in the United States and/or other countries. All other trademarks are the property of their respective owners. Product may vary slightly from those pictured.

FCC ID: 2AAFMRGP0145 (Mouse)
FCC ID: 2AAFMRGP0146 (Dongle)

IC: 10954A-RGP0145 (Mouse)
IC: 10954A-RGP0146 (Dongle)



SIGN UP

